



MACK

CIVIL ENGINEERING

26 September 2022

Cycleway Construction

The Crescent, Beecroft

Dear Householder / Business Operators

As you may already be aware, Mack Civil, on behalf of Hornsby Shire Council is undertaking construction work as part of the Beecroft to Cheltenham Cycleway project.

During upcoming construction works, there will be intermittent road closures along The Crescent with additional traffic control to facilitate works. These constructions works take place until the end of October 2022.

Pedestrian access to properties will be maintained at all times.

We apologise for any inconvenience caused and every effort will be made to ensure vehicle access to your property is returned as early as possible.

This work may be noisy at times, however, every effort will be made to minimise the impact to residents and businesses.

To facilitate the various work activities, changed traffic and pedestrian conditions will apply, including temporary road closures and detours. Motorists and Pedestrians are asked to assist and comply with these changed conditions and any directions provided by Traffic Controllers employed for your safety.

The detour setup on The Crescent between The Promenade to Cheltenham Road will be amended during school drop off and pick up hours to allow vehicles to drive through to Cheltenham Road from The Crescent, as we understand this route is highly used during school drop off and pick up hours to access Cheltenham Road.

Should you have any concerns regarding these works, Senior Project Manager, Gordon Butt can be contacted on 0424 136 386 or info@mackcivil.com.au

Thank you in advance for your understanding and cooperation.

Regards

Gordon Butt

Mack Civil Engineering

www.mackcivil.com.au



Senior Project Manager

Location Map



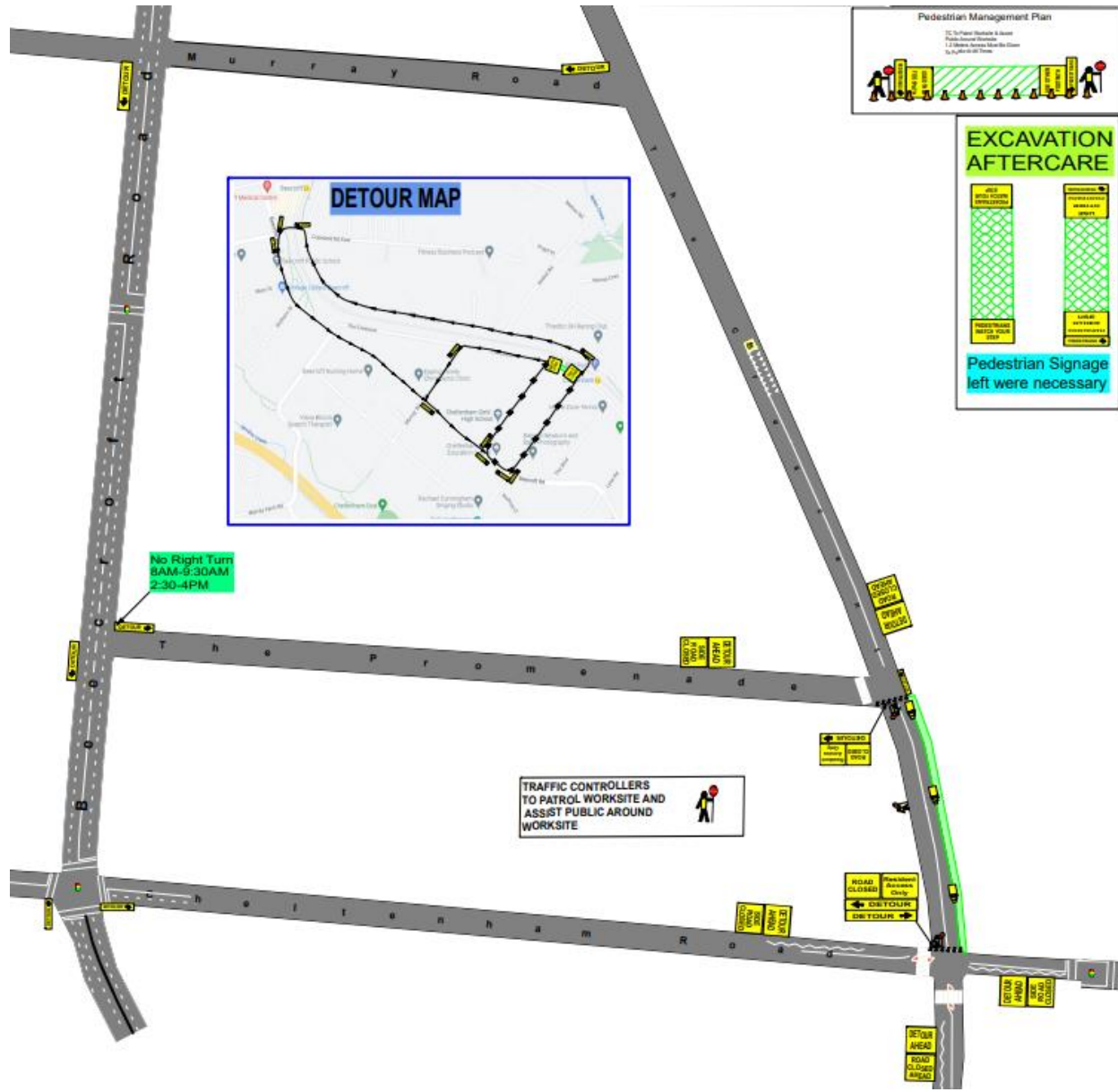

Pedestrian Management Plan
CC-11-Plan-Markets & Street
Public Access Strategy
1.2 Public Access - Areas To Close
By Night or All Time

EXCAVATION AFTERCARE

Pedestrian Signage left where necessary

TRAFFIC CONTROLLERS TO PATROL WORKSITE AND ASSIST PUBLIC AROUND WORKSITE