

# PUBLIC DOMAIN WORKS CIVIL ENGINEERING PLANS FOR CONSTRUCTION CERTIFICATE 94 DAVID ROAD, CASTLE HILL

DA/1017/2021/A

### GENERAL NOTES.

- ALL WORK TO BE CARRIED OUT IN ACCORDANCE WITH HORNSBY SHIRE COUNCIL'S DEVELOPMENT ENGINEERING STANDARD UNLESS OTHERWISE NOTED.
- ALL EROSION AND SEDIMENTATION CONTROL MEASURES ARE TO BE CARRIED OUT IN ACCORDANCE WITH COUNCIL'S CODE OF PRACTICE FOR EROSION AND SEDIMENTATION, AND MUST BE IMPLEMENTED PRIOR TO THE COMMENCEMENT OF ANY BUILDING OF CIVIL WORKS. THE DEVELOPER IS RESPONSIBLE FOR ONGOING MAINTENANCE OF EROSION AND SILTATION CONTROL MEASURES.
- ALL PUBLIC UTILITIES ARE TO BE CLEARLY IDENTIFIED IN THE FIELD PRIOR TO ANY CIVIL WORKS. COUNCIL ACCEPTS NO RESPONSIBILITY FOR DAMAGE OR RELOCATION COSTS TO UTILITIES DURING CONSTRUCTION.
- SUPERVISING ENGINEER IS TO BE NOTIFIED PRIOR TO THE COMMENCEMENT OF ANY WORKS.
- IT IS THE CONTRACTOR'S RESPONSIBILITY TO ENSURE THAT ALL WORKS ARE CARRIED OUT IN ACCORDANCE WITH WORK HEALTH AND SAFETY ACT 2011.
- PERMISSION TO ENTER, CONSTRUCT WORKS AND DISCHARGE STORMWATER ONTO ADJOINING PROPERTIES IS TO BE OBTAINED AND SUBMITTED TO COUNCIL PRIOR TO COMMENCEMENT OF ANY WORKS.
- ALL WORKS AS A RESULT OF THE SUBMITTED PLANS IS TO BE CARRIED OUT TO THE SUPERVISING ENGINEER'S SATISFACTION.
- ANY DISTURBED LANDSCAPING AREA IS TO BE SHAPED AND TURFED, APPROVED TOP SOIL & TURF IS TO BE REINSTATED TO THE SUPERVISING ENGINEER'S SATISFACTION.
- ALL DRAINAGE GRATES TO BE BIKE SAFE TO LOAD TYPE CLASS "D" AS PER AS3996-2006 (LOAD CLASSIFICATION). GRATES TO BE "DURHAM-MEDIUM TRAFFICABLE" OR SIMILAR.
- RETAINED TREES TO BE FENCED WITH A 1.8m HIGH CHAINWIRE LINK FENCE FULLY SUPPORTED AT GRADE TO MINIMISE THE DISTURBANCE TO EXISTING GROUND CONDITIONS WITHIN THE CANOPY DRIP LINE. "TREE PROTECTION ZONE" SIGNAGE TO BE ATTACHED TO PROTECTIVE FENCING.
- A ROAD-OPENING PERMIT SHALL BE OBTAINED FOR WORKS IN THE ROAD RESERVE PRIOR TO COMMENCEMENT OF WORK IN THE ROAD RESERVE.
- ALL REDUNDANT LINE MARKING SHALL BE GRINDED OFF THE PAVEMENT AND APPROVED LINE MARKING FROM COUNCIL AND/OR TINSW SHALL BE REFLECTIVE WHITE THERMOPLASTIC OR SIMILAR.
- SERVICES SHOWN ON THIS PLAN HAVE BEEN LOCATED FROM INFORMATION SUPPLIED FROM THE RELEVANT AUTHORITIES VIA A "DIAL BEFORE YOU DIG" ENQUIRY DURING DESIGN. THE LOCATION OF SERVICES SHOWN ON THIS DRAWING HAVE BEEN PLOTTED AS ACCURATELY AS POSSIBLE FROM DIAGRAMS PROVIDED BY SERVICE AUTHORITIES. A NEW "DIAL BEFORE YOU DIG" ENQUIRY MUST BE CARRIED OUT TO VERIFY SERVICE LOCATIONS JUST PRIOR TO CONSTRUCTION.
- NO CONCRETE SHALL BE POURED PRIOR THE EXCAVATION AND FORMWORK HAVE BEEN INSPECTED FROM A QUALIFIED AND PRACTICING CIVIL ENGINEER.
- CERTIFICATION FROM PRACTICING ENGINEER TO BE SUBMITTED TO COUNCIL.

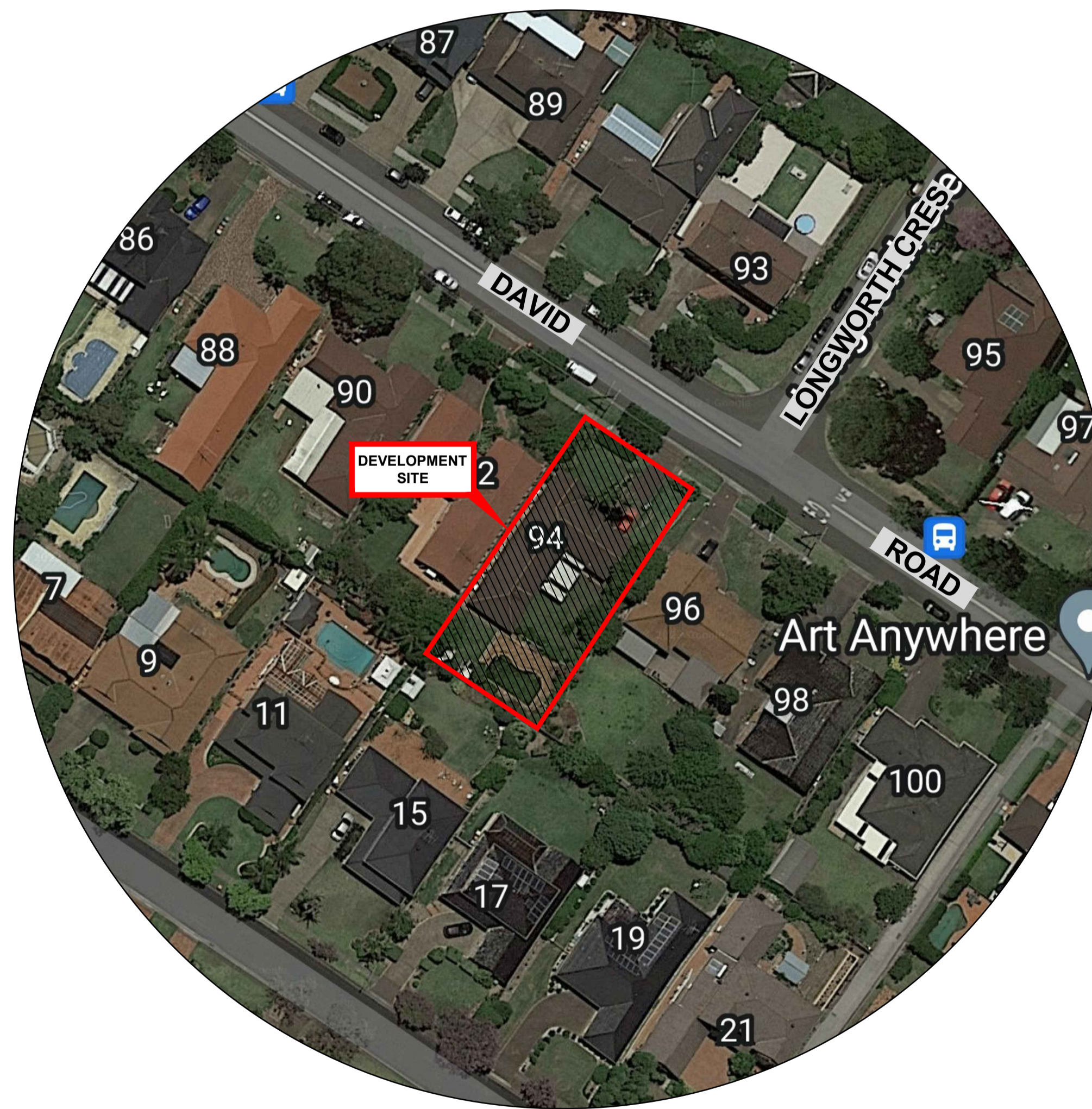

LOCALITY PLAN  
N.T.S.

DRAWING INDEX		
Drawing No.	DESCRIPTION	Rev
C000	GENERAL NOTES, LOCALITY PLAN & DRAWING SCHEDULE	D
C101	CIVIL WORKS LAYOUT PLAN	C
C201	DRIVEWAY PROFILE - LONGITUDINAL SECTIONS	A
C301	DAVID ROAD - LONGITUDINAL SECTION	A
C401	DAVID ROAD - CROSS SECTIONS	A
C501	TYPICAL CROSS SECTIONS	A
C601	CONSTRUCTION NOTES AND DETAILS SHEET 1 OF 2	A
C602	CONSTRUCTION NOTES AND DETAILS SHEET 2 OF 2	B
C701	PEDESTRIAN REFUGE PLAN	D
C801	SWEPT PATH	B

**DANGER :**  
LOCATION OF ALL EXISTING UNDERGROUND SERVICES SHOWN ARE APPROXIMATE AS TAKEN OFF DBYD INFO. EXTREME CAUTION TO BE EXERCISED WHEN WORKING IN THE VICINITY OF AND AROUND THESE SERVICES. PLEASE CALL THE RELEVANT AUTHORITIES TWO DAYS PRIOR TO CONSTRUCTION FOR A MORE EXACT LOCATION OF THE EXISTING SERVICES.

IT IS THE CONTRACTOR RESPONSIBILITY TO CONTACT "DIAL BEFORE YOU DIG" FOR THE LOCATION OF EXISTING PUBLIC UTILITIES, PRIOR TO EXCAVATION.

**DISCLAIMER**  
ALL INFRASTRUCTURE INFORMATION (MAINS, SEWER, PIPES ETC.) IS DERIVED FROM DIAL BEFORE YOU DIG RECORDS.  
  
EVERY EFFORT WAS MADE TO ENSURE ACCURACY OF THESE RECORDS WHEN COMPILED.  
  
NO WARRANTY IS GIVEN TO CURRENCY OF DEPTHS AND LEVELS DUE TO THE POSSIBILITY OF SUBSEQUENT ALTERATION OF LEVELS THROUGH FILLING OR EXCAVATION. USERS OF THE INFORMATION IN THIS DRAWING/DESIGN SHOULD TAKE ALL REASONABLE STEPS TO VERIFY THE RELEVANT INFORMATION BEFORE COMMENCING EXCAVATING OR CONSTRUCTION WORK.  
  
TELFORD CIVIL DESIGN & CONSTRUCTION EXCELLENCE TAKE NO RESPONSIBILITY FOR APPARENT ERRORS OR INACCURACIES IN THE INFORMATION PROVIDED.

NOT FOR CONSTRUCTION



Issue	Description	Date	Design	Checked
D	ISSUE FOR CONSTRUCTION CERTIFICATE	10/07/2023	J.E.H.	J.A.B.
C	ISSUE FOR CONSTRUCTION CERTIFICATE	09/06/2023	J.E.H.	J.A.B.
B	ISSUE FOR CONSTRUCTION CERTIFICATE	22/05/2023	J.E.H.	J.A.B.
A	ISSUE FOR CONSTRUCTION CERTIFICATE	24/03/2023	P.B.T.	J.A.B.

Certification By Dr. Michel Chaaya  
B.E., M.E. (Res), Ph.D., F.I.E. Aust., CPEng.,  
Civil & Structural Engineer

Architect  
**INTO Architecture**  
Scott Miner - Architect NSW Reg. #9100  
Mobile 0409 995 974  
Email scott@intoarchitecture.com.au

Client  
**JOANNE DRAYBI**

Council  
**HORNSBY SHIRE COUNCIL**

Scale

**TELFORD CIVIL**  
DESIGN & CONSTRUCTION EXCELLENCE

Level 14, 32 Smith Street, Parramatta NSW 2150  
PO BOX 3579 Parramatta 2124

Email : info@telfordcivil.com.au  
Phone : 02 7809 4931  
Company : Telford Consulting Pty Ltd

Project  
**94 DAVID ROAD, CASTLE HILL  
PUBLIC DOMAIN WORKS  
CIVIL ENGINEERING PLANS  
CONSTRUCTION CERTIFICATE**

Drawing Title				
GENERAL NOTES, LOCALITY PLAN AND DRAWING SCHEDULE				
Scale	A1	Project No.	Dwg. No.	Issue
N.T.S.		23001	C000	D

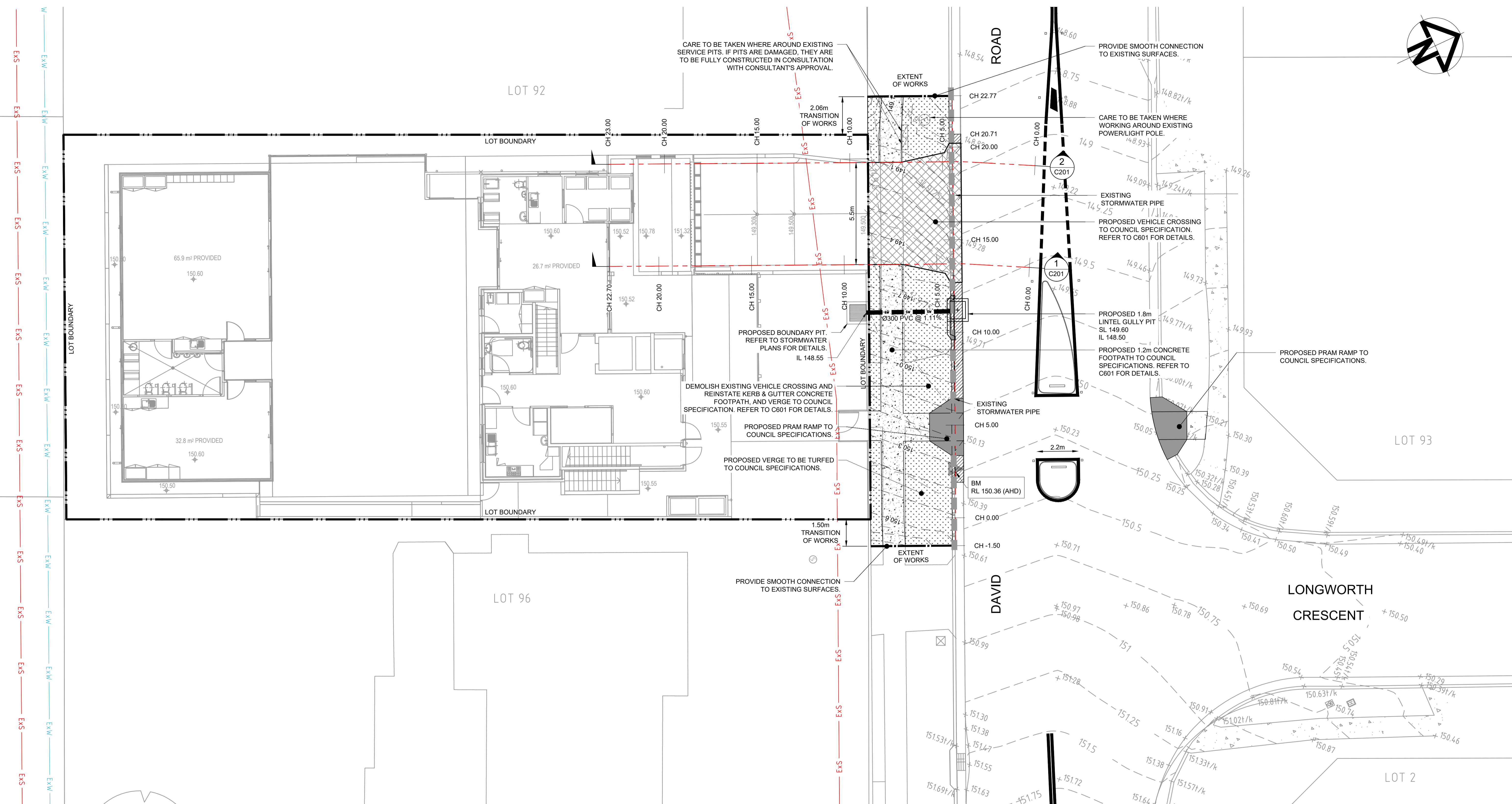
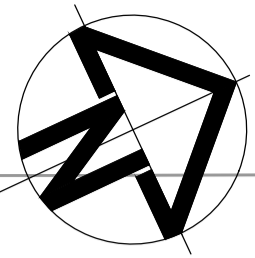

**LEGEND**

- LOT BOUNDARY
- PROPOSED KERB & GUTTER
- PROPOSED CENTRE LINE
- PROPOSED CONTROL LINE
- PROPOSED VERGE
- PROPOSED DRIVEWAY
- PROPOSED CONCRETE FOOTPATH
- PROPOSED PRAM RAMP TO COUNCIL SPECIFICATIONS
- PROPOSED STORMWATER PIPE
- PROPOSED STORMWATER PIT
- PROPOSED GULLY PIT
- Ex. K&G
- ExW
- ExS
- EXISTING STORMWATER PIPE
- EXISTING STORMWATER PIPE



NOTE:  
ALL EXISTING SERVICES TO BE ADJUSTED TO MATCH PROPOSED SURFACE LEVELS.

**NOT FOR CONSTRUCTION**

Issue	Description	Date	Design	Checked
C	ISSUE FOR CONSTRUCTION CERTIFICATE	09/06/2023	J.E.H.	J.A.B.
B	ISSUE FOR CONSTRUCTION CERTIFICATE	22/05/2023	J.E.H.	J.A.B.
A	ISSUE FOR CONSTRUCTION CERTIFICATE	24/03/2023	P.B.T.	J.A.B.

Certification By Dr. Michel Chaaya  
B.E., M.E. (Res), Ph.D., F.I.E. Aust., CPEng,  
Civil & Structural Engineer

Architect  
**INTO Architecture**  
Scott Miner - Architect NSW Reg. #9100  
Mobile 0409 995 974  
Email scott@intoarchitecture.com.au

Client  
**JOANNE DRAYBI**

Council  
**HORNBY SHIRE COUNCIL**

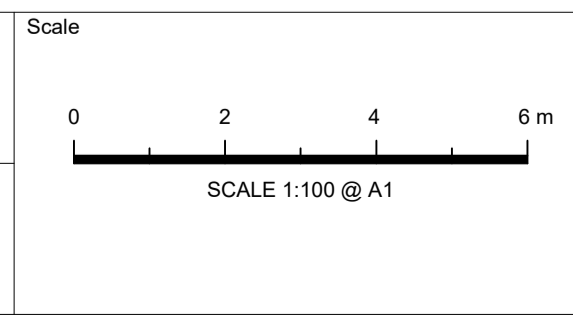

**TELFORD CIVIL**  
DESIGN & CONSTRUCTION EXCELLENCE

Level 14, 32 Smith Street,  
Parramatta NSW 2150  
PO BOX 3579 Parramatta 2124

Email : info@telfordcivil.com.au  
Phone : 02 7809 4931  
Company : Telford Consulting Pty Ltd

Project  
**94 DAVID ROAD, CASTLE HILL  
PUBLIC DOMAIN WORKS  
CIVIL ENGINEERING PLANS  
CONSTRUCTION CERTIFICATE**

Drawing Title  
**CIVIL WORKS LAYOUT PLAN**

Scale	A1	Project No.	Dwg. No.	Issue
1:100		23001	C101	C

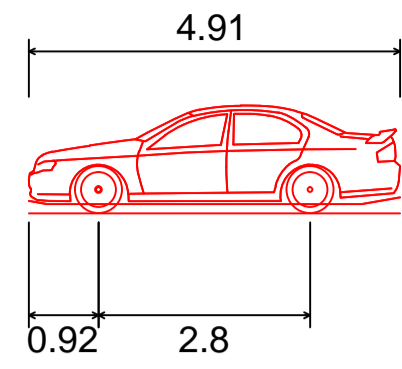

B85 Ground Clearance (2004)  
 Overall Length 4.910m  
 Overall Width 1.870m  
 Overall Body Height 1.421m  
 Min Body Ground Clearance 0.120m  
 Track Width 1.770m  
 Lock-to-lock time 4.00s  
 Curb to Curb Turning Radius 8.000m

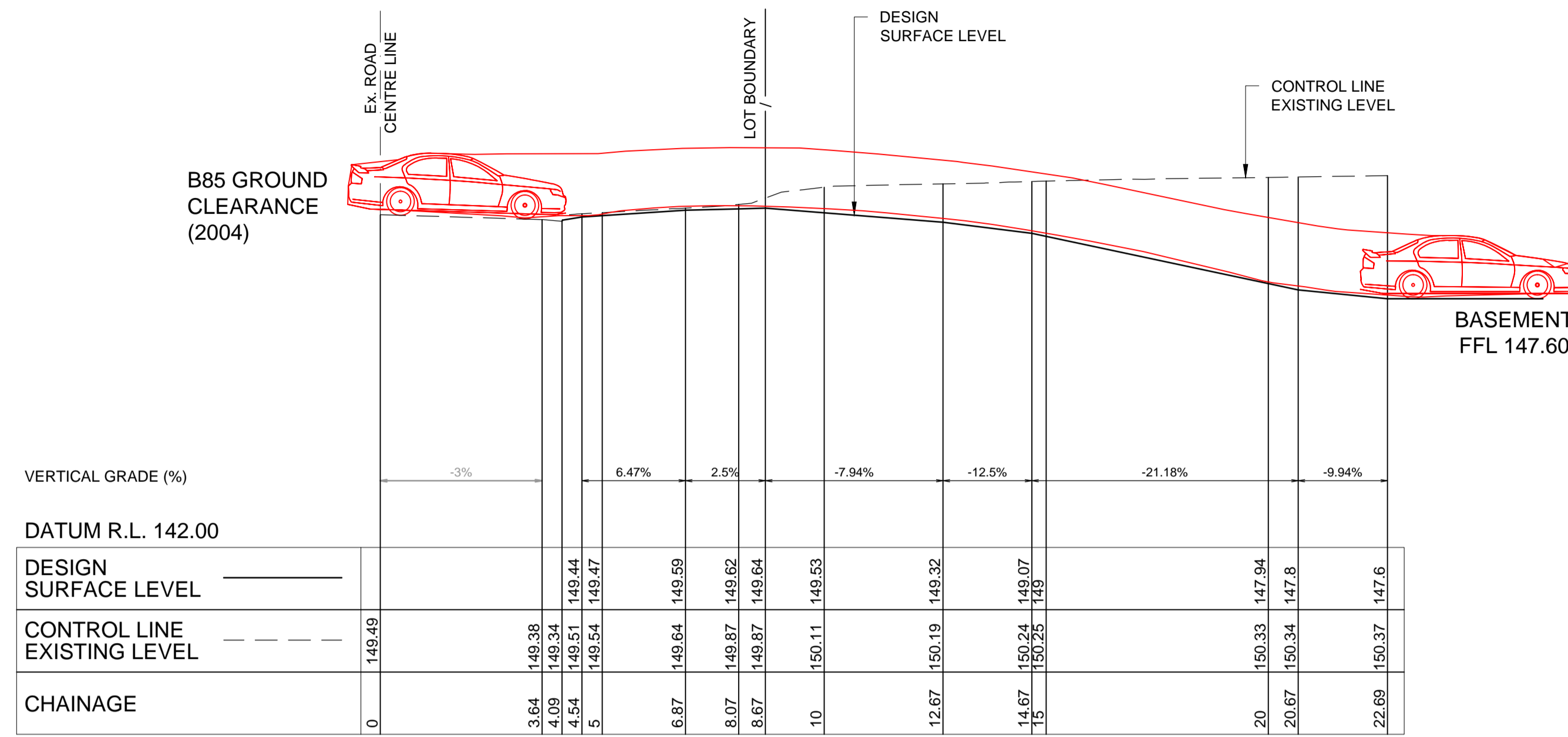

DRIVEWAY PROFILE - LONGITUDINAL SECTION 1  
 SCALE 1:100 (NATURAL) C101

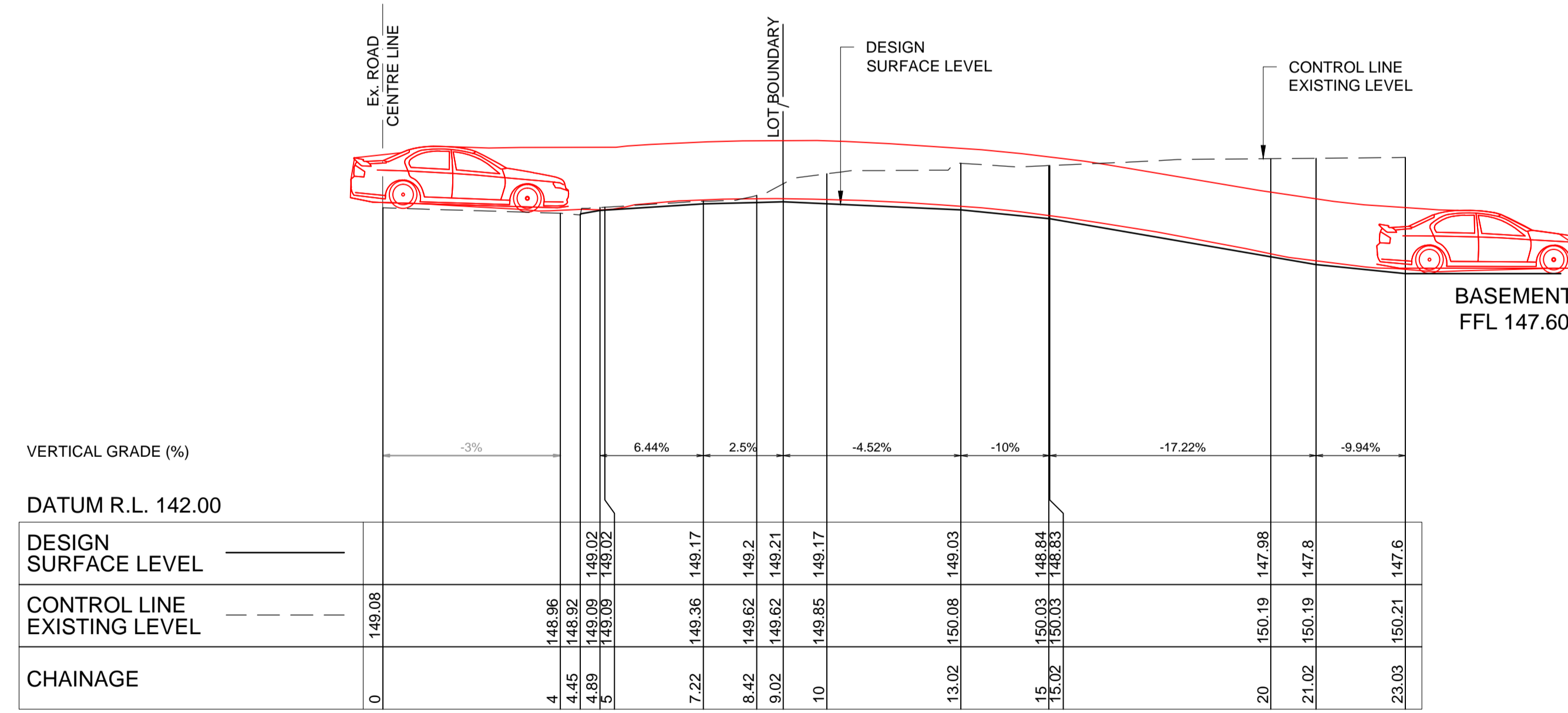

DRIVEWAY PROFILE - LONGITUDINAL SECTION 2  
 SCALE 1:100 (NATURAL) C101

NOT FOR CONSTRUCTION

A ISSUE FOR CONSTRUCTION CERTIFICATE				24/03/2023	P.B.T.	J.A.B.
Issue	Description	Date	Design	Checked		

Certification By Dr. Michel Chaaya  
 B.E., M.E. (Res), Ph.D., F.I.E. Aust., CPEng.,  
 Civil & Structural Engineer

Architect  
**INTO Architecture**  
 Scott Miner - Architect NSW Reg. #9100  
 Mobile 0409 995 974  
 Email scott@intoarchitecture.com.au

Client  
**JOANNE DRAYBI**  
 Council  
**HORNSBY SHIRE COUNCIL**

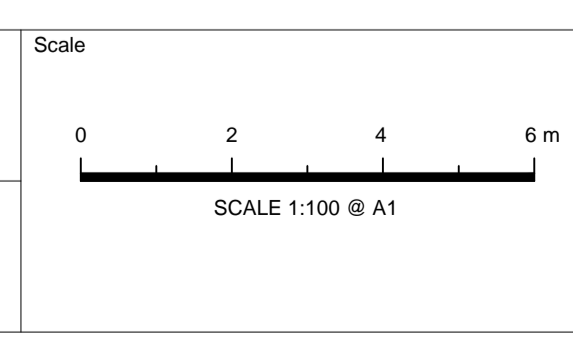

**TELFORD CIVIL**  
 DESIGN & CONSTRUCTION EXCELLENCE

Level 14, 32 Smith Street, Parramatta NSW 2150  
 PO BOX 3579 Parramatta 2124

Email : info@telfordcivil.com.au  
 Phone : 02 7809 4931  
 Company : Telford Consulting Pty Ltd

Project  
**94 DAVID ROAD, CASTLE HILL  
 PUBLIC DOMAIN WORKS  
 CIVIL ENGINEERING PLANS  
 CONSTRUCTION CERTIFICATE**

Drawing Title DRIVEWAY PROFILE LONGITUDINAL SECTIONS			
Scale 1:100	A1	Project No. 23001	Dwg. No. C201
			Issue A

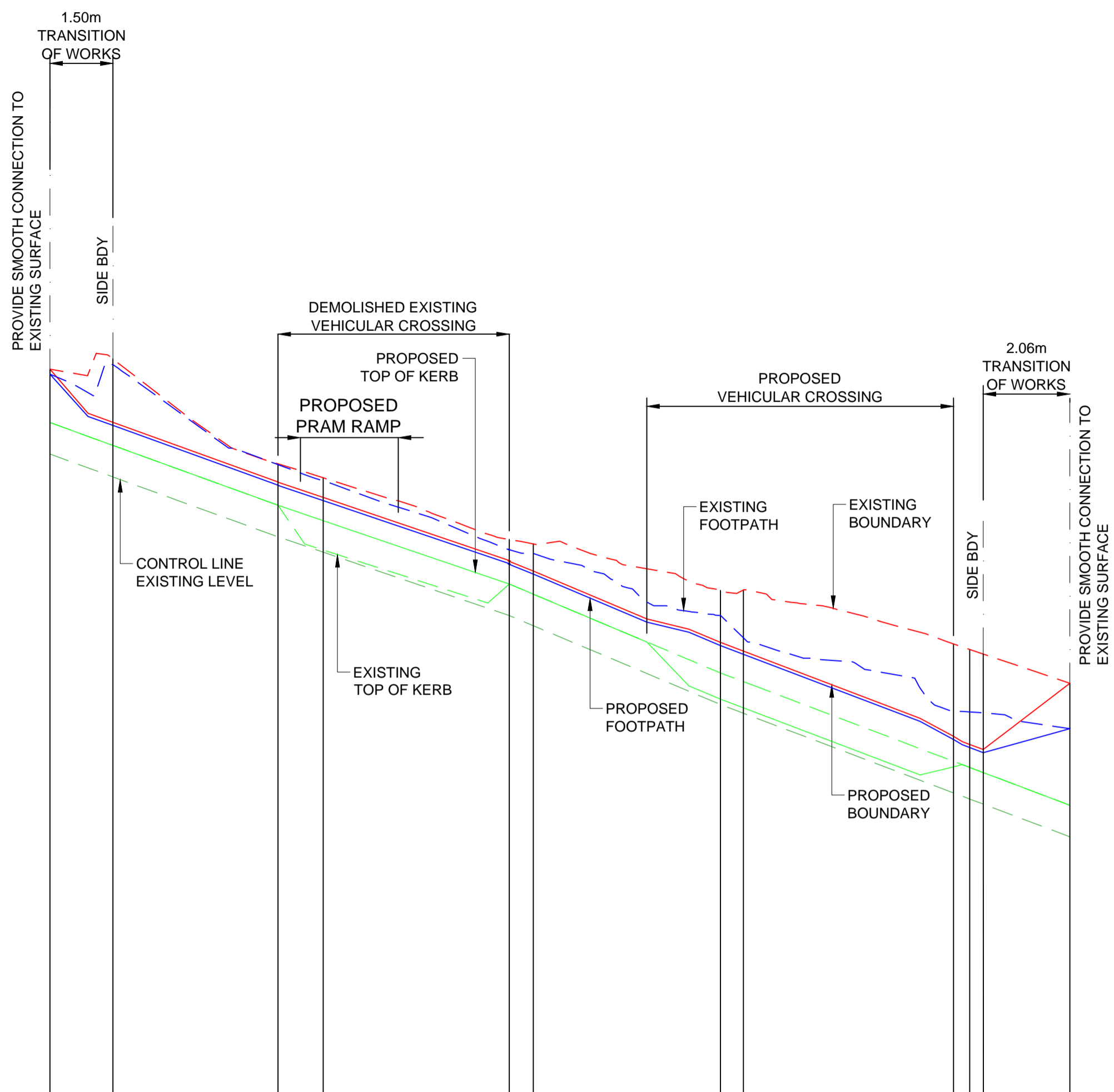

CONTROL LINE VERTICAL GRADE (%)		-7.26%		-6.82%		-8.42%		-7.58%		-7.54%			
DATUM R.L. 147.00													
EXISTING TOP OF KERB	---	150.622	150.513	150.228	149.853	149.805	149.43	148.985	148.8				
PROPOSED TOP OF KERB	---												
EXISTING FOOTPATH	---	150.852	150.896	150.422	149.999	149.597	149.264	148.985	148.985	149.165			
PROPOSED FOOTPATH	---												
EXISTING BOUNDARY	---	150.876	150.924	150.425	150.044	149.823	149.534	149.568	149.532				
PROPOSED BOUNDARY	---												
CONTROL LINE EXISTING LEVEL	---	150.47	150.36	150.08	149.65	149.28	148.86	148.86	148.65				
CHAINAGE		-1.5	0	3.93	5	9.43	10	14.45	15	20	20.99	21.01	22.77

DAVID ROAD - LONGITUDINAL SECTION - CONTROL LINE (INVERT OF KERB)  
 SCALE (H) 1:100  
 (V) 1:20

NOT FOR CONSTRUCTION

A				ISSUE FOR CONSTRUCTION CERTIFICATE				24/03/2023	P.B.T.	J.A.B.
Issue	Description	Date	Design	Checked						

Certification By Dr. Michel Chaaya  
 B.E., M.E. (Res), Ph.D., F.I.E. (Aus.), CPEng.,  
 Civil & Structural Engineer

Architect  
**INTO Architecture**  
 Scott Miner - Architect NSW Reg. #9100  
 Mobile 0409 995 974  
 Email scott@intoarchitecture.com.au

Client  
**JOANNE DRAYBI**  
 Council  
**HORNSBY SHIRE COUNCIL**

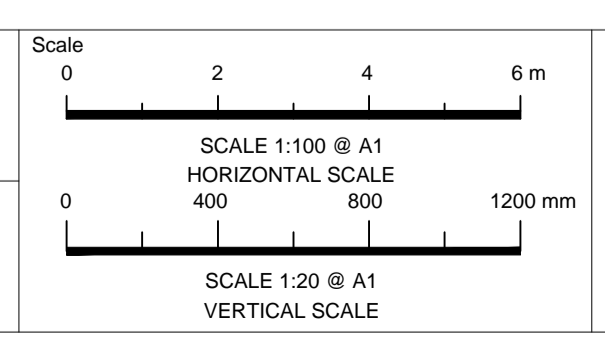

**TELFORD CIVIL**  
 DESIGN & CONSTRUCTION EXCELLENCE

Level 14, 32 Smith Street,  
 Parramatta NSW 2150  
 PO BOX 3579 Parramatta 2124

Email : info@telfordcivil.com.au  
 Phone : 02 7809 4931  
 Company : Telford Consulting Pty Ltd

Project  
**94 DAVID ROAD, CASTLE HILL  
 PUBLIC DOMAIN WORKS  
 CIVIL ENGINEERING PLANS  
 CONSTRUCTION CERTIFICATE**

Drawing Title <b>DAVID ROAD LONGITUDINAL SECTION</b>			
Scale AS SHOWN	A1 Project No. 23001	Dwg. No. C301	Issue A

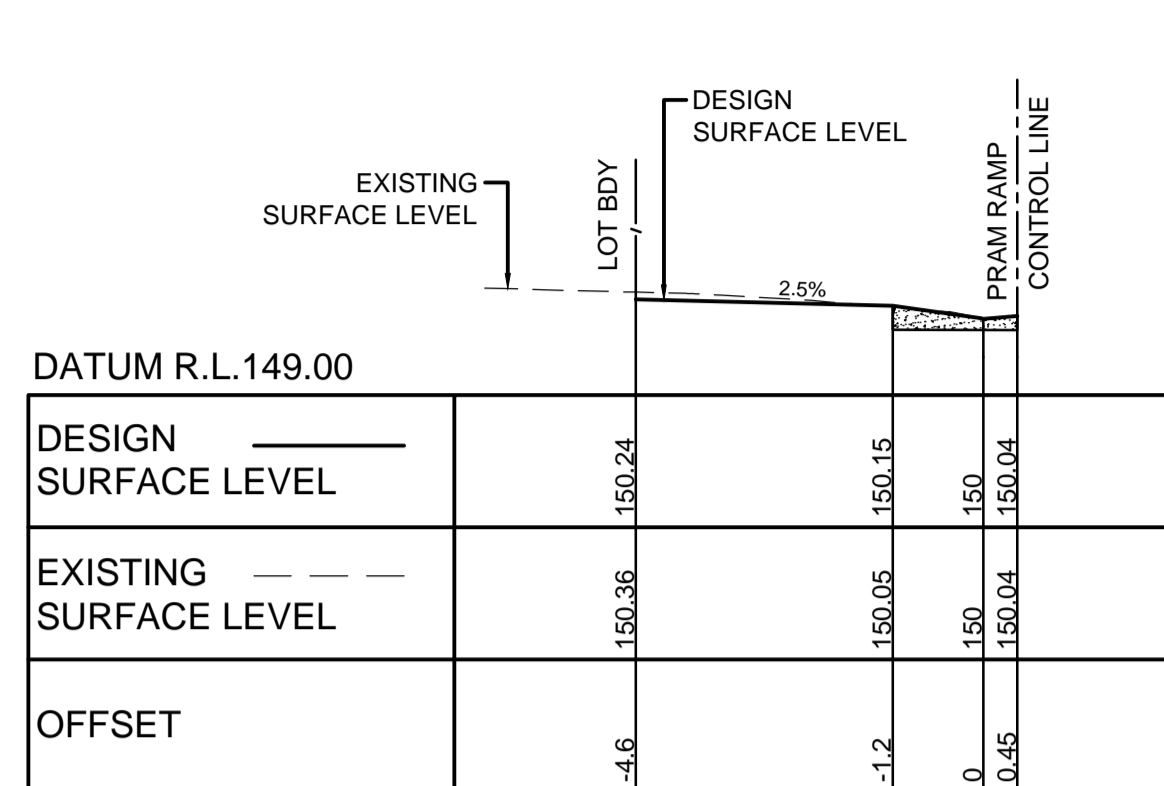

CH. 5.00 - ENTRANCE

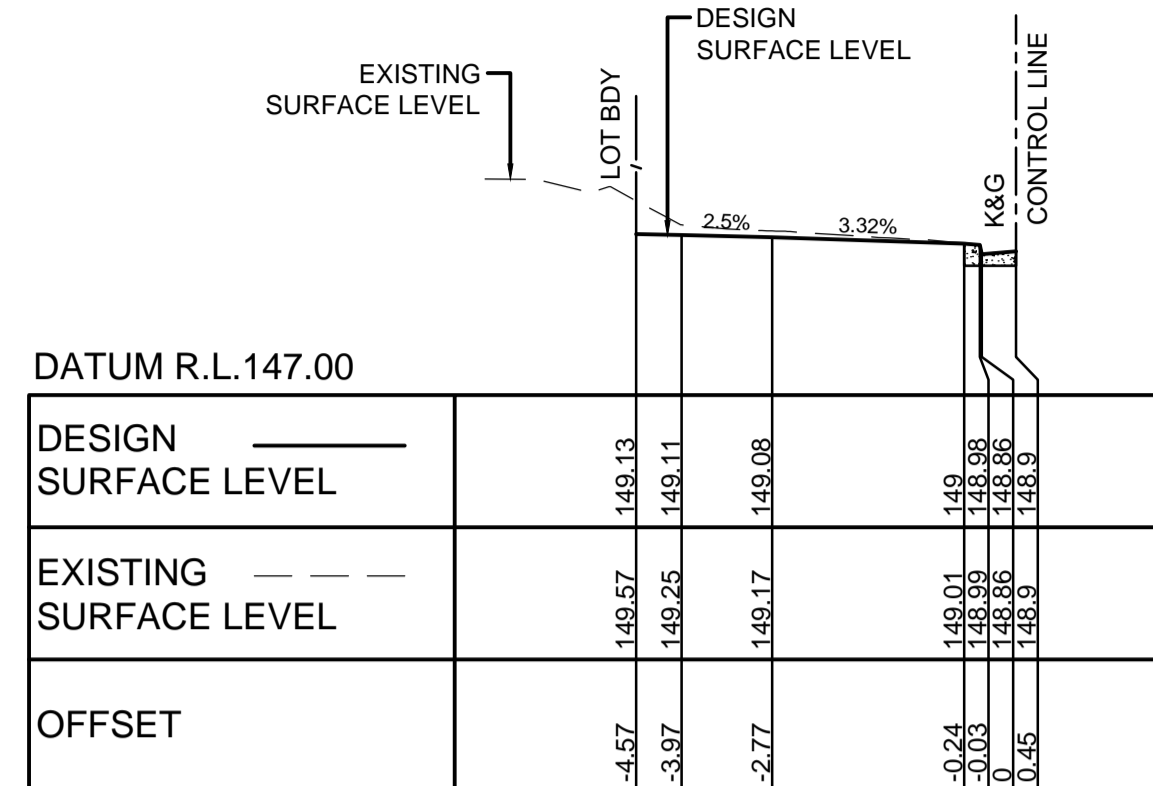

CH. 20.00

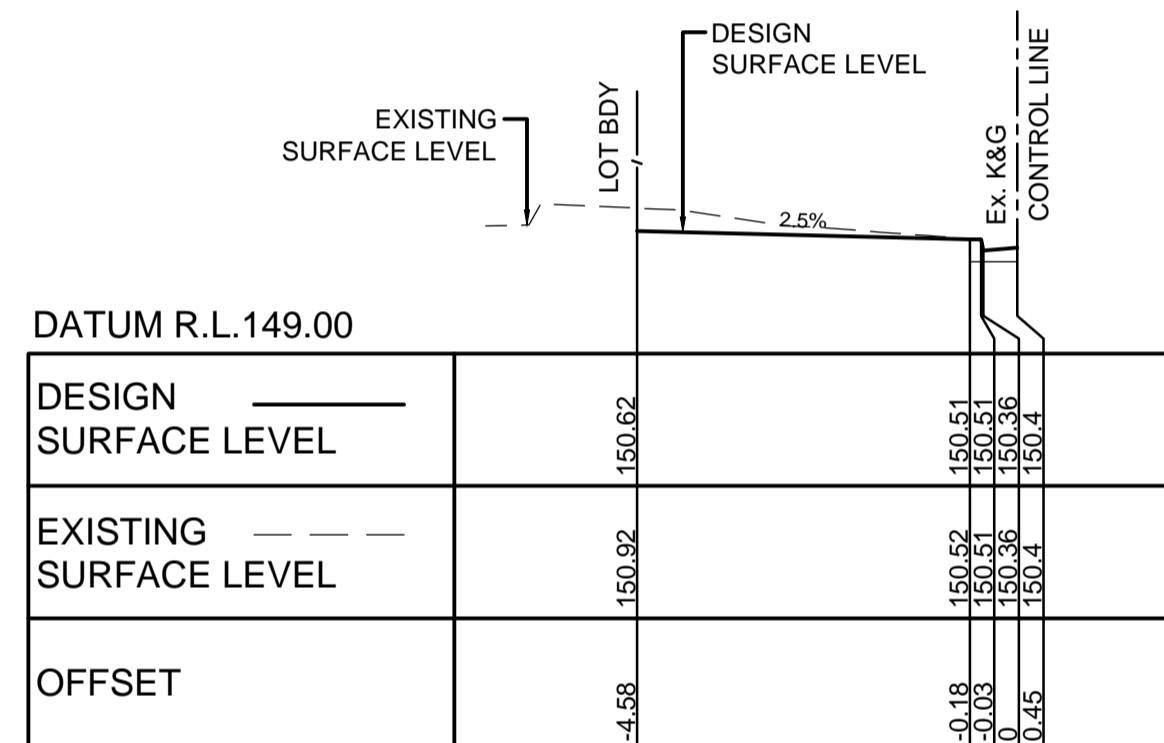

CH. 0.00 - SIDE BOUNDARY

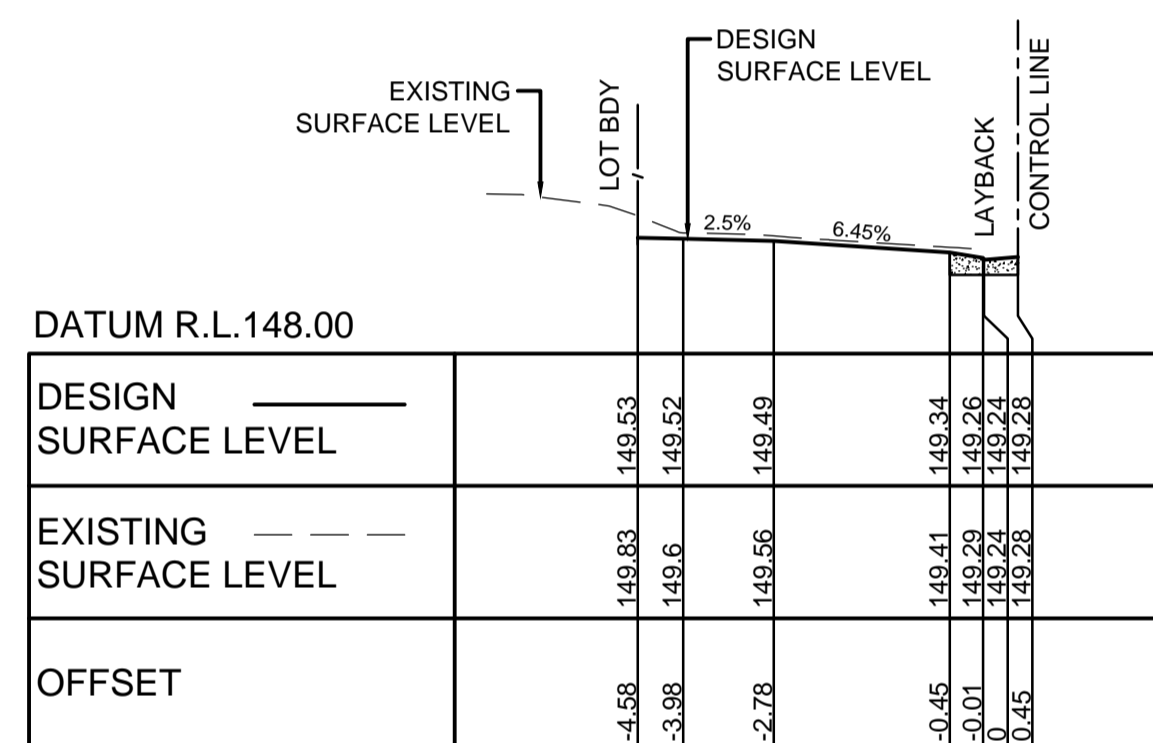

CH. 15.00 - DRIVEWAY

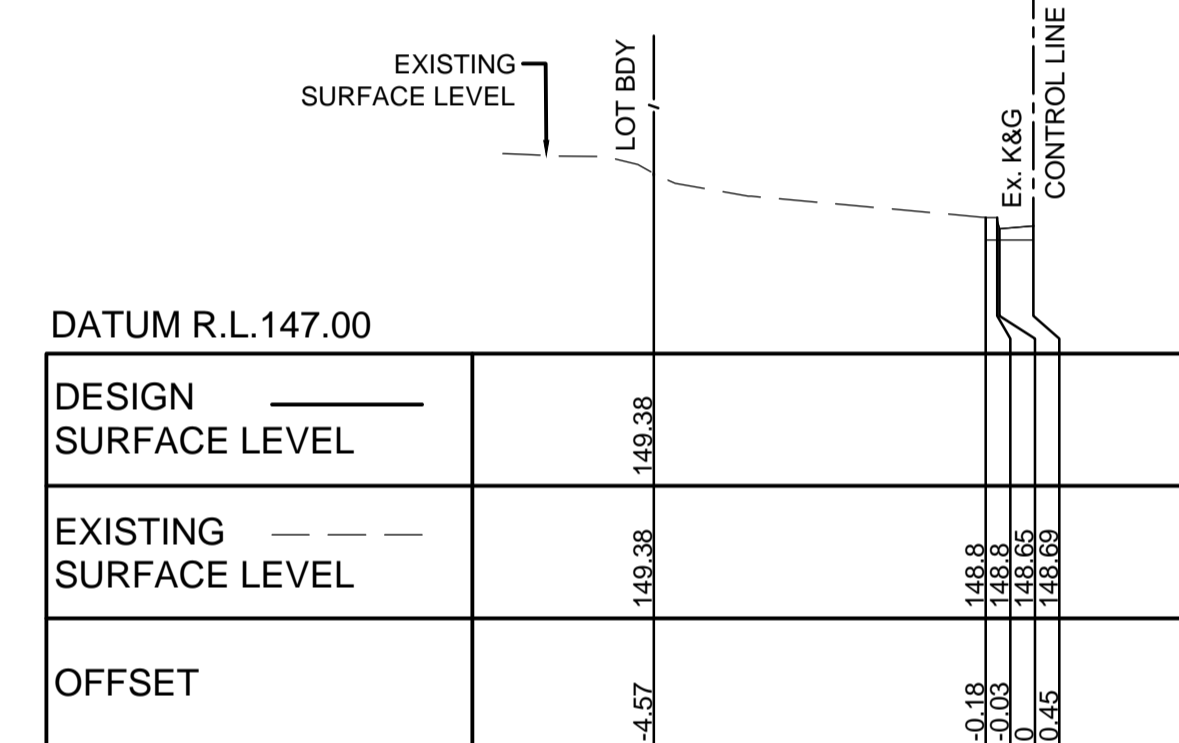

CH. 22.77 - TRANSITION

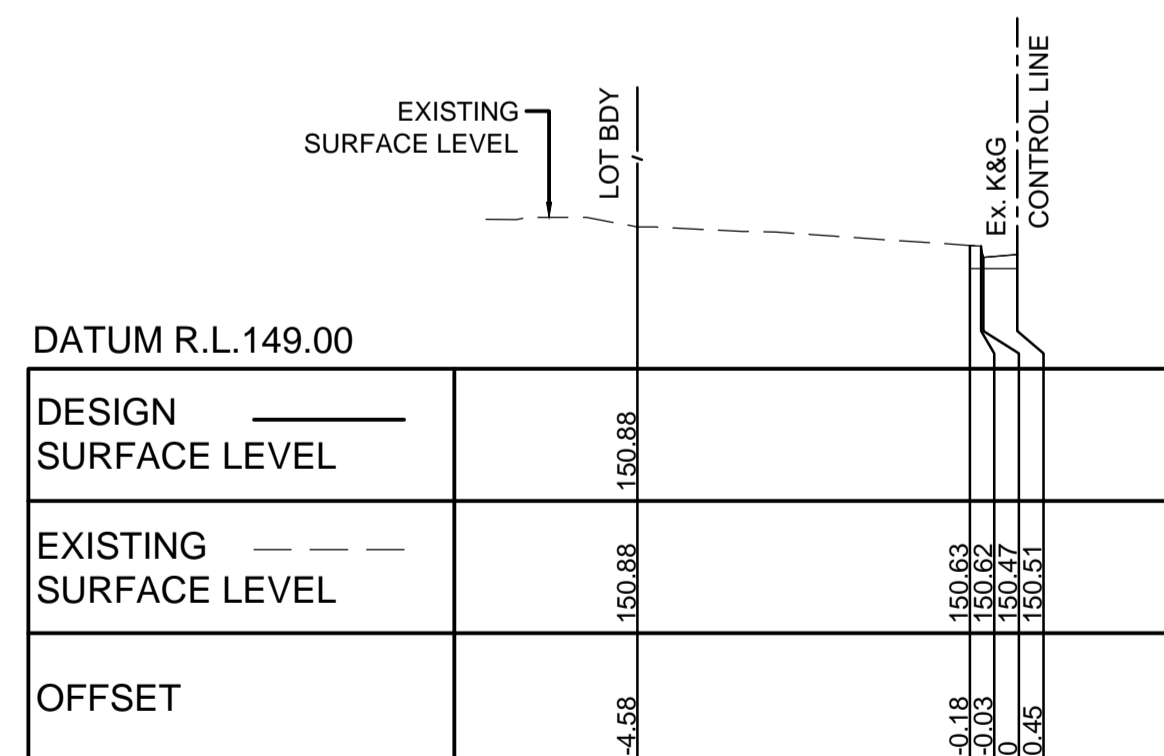

CH. -1.50 - TRANSITION

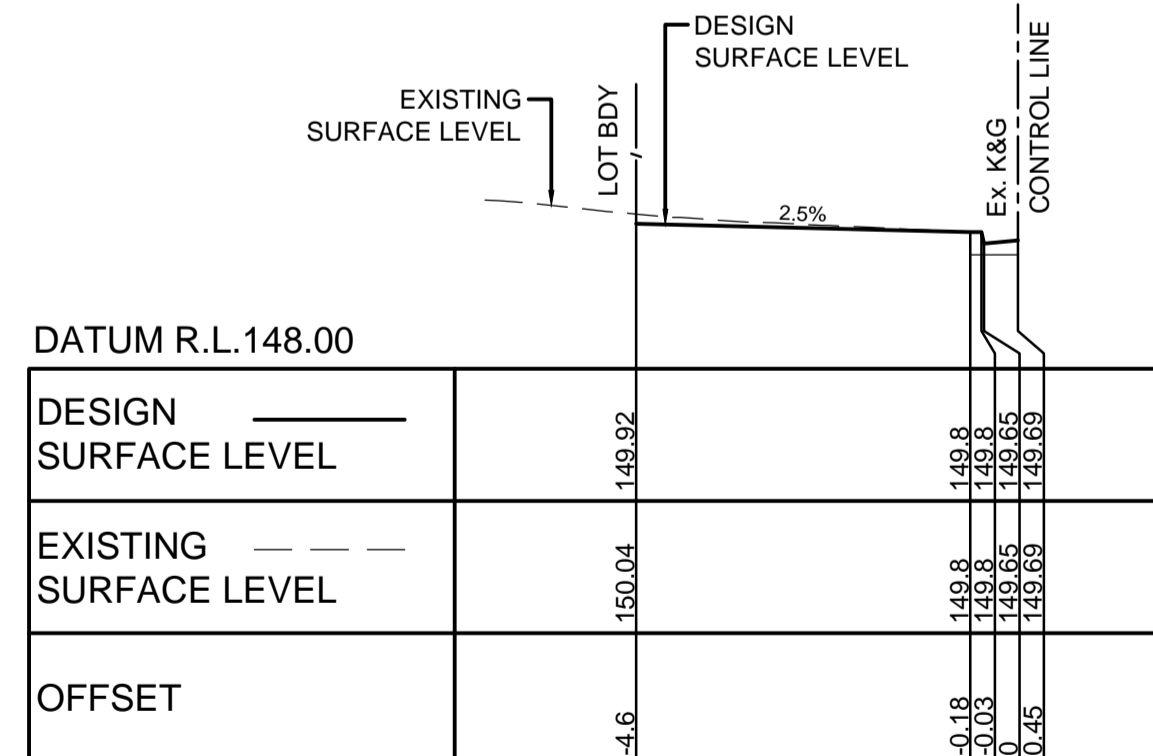

CH. 10.00

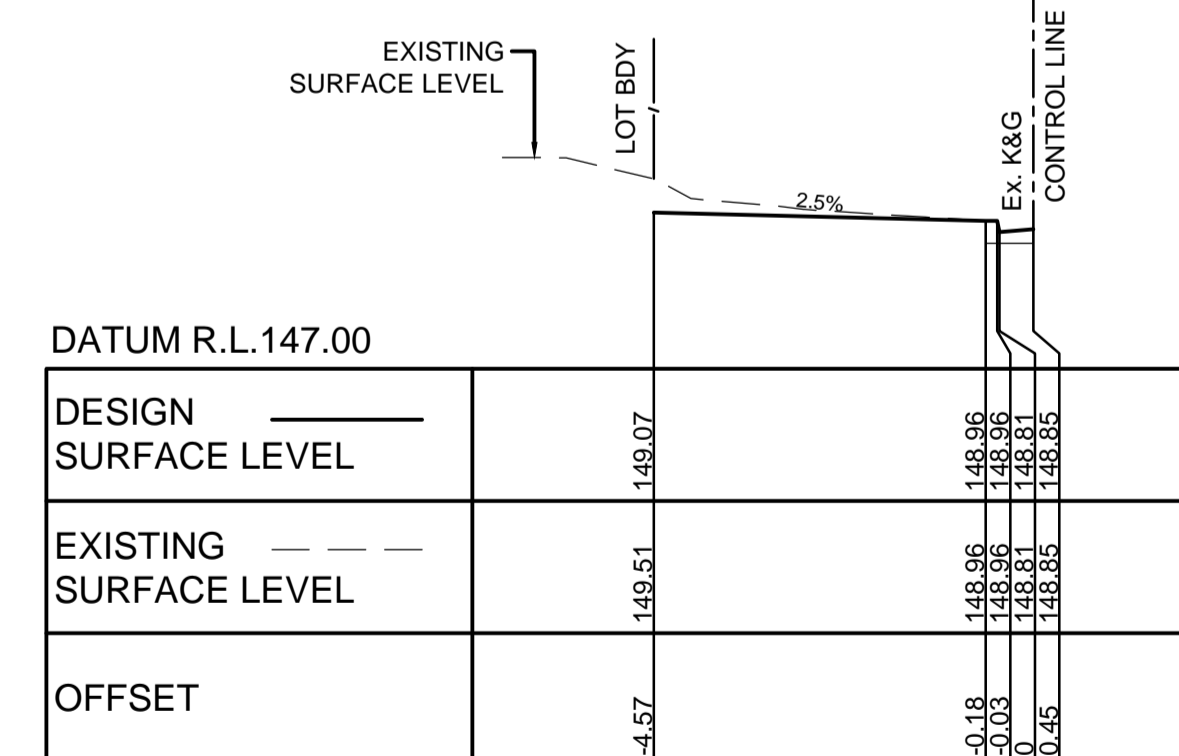

CH. 20.71 - SIDE BOUNDARY

NOT FOR CONSTRUCTION

Issue	Description	Date	Design	Checked
A	ISSUE FOR CONSTRUCTION CERTIFICATE	24/03/2023	P.B.T.	J.A.B.

Certification By Dr. Michal Chaya  
B.E., M.E. (Res), Ph.D., F.I.E. Aust., CPEng.,  
Civil & Structural Engineer

Architect  
**INTO Architecture**  
Scott Miner - Architect NSW Reg. #9100  
Mobile 0409 995 974  
Email scott@intoarchitecture.com.au

Client  
**JOANNE DRAYBI**  
Council  
**HORNSBY SHIRE COUNCIL**

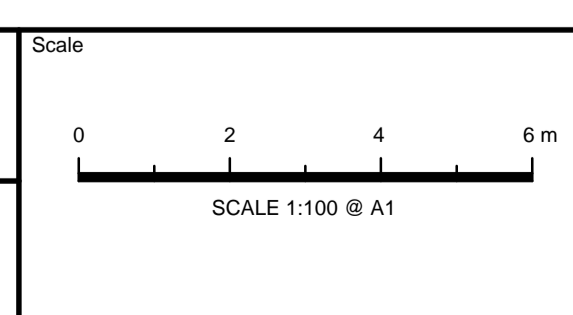

**TELFORD CIVIL**  
DESIGN & CONSTRUCTION EXCELLENCE

Level 14, 32 Smith Street,  
Parramatta NSW 2150  
PO BOX 3579 Parramatta 2124

Email : info@telfordcivil.com.au  
Phone : 02 7809 4931  
Company : Telford Consulting Pty Ltd

Project  
**94 DAVID ROAD, CASTLE HILL  
PUBLIC DOMAIN WORKS  
CIVIL ENGINEERING PLANS  
CONSTRUCTION CERTIFICATE**

Drawing Title  
**DAVID ROAD  
CROSS SECTIONS**

Scale	A1	Project No.	Dwg. No.	Issue
1:100		23001	C401	A

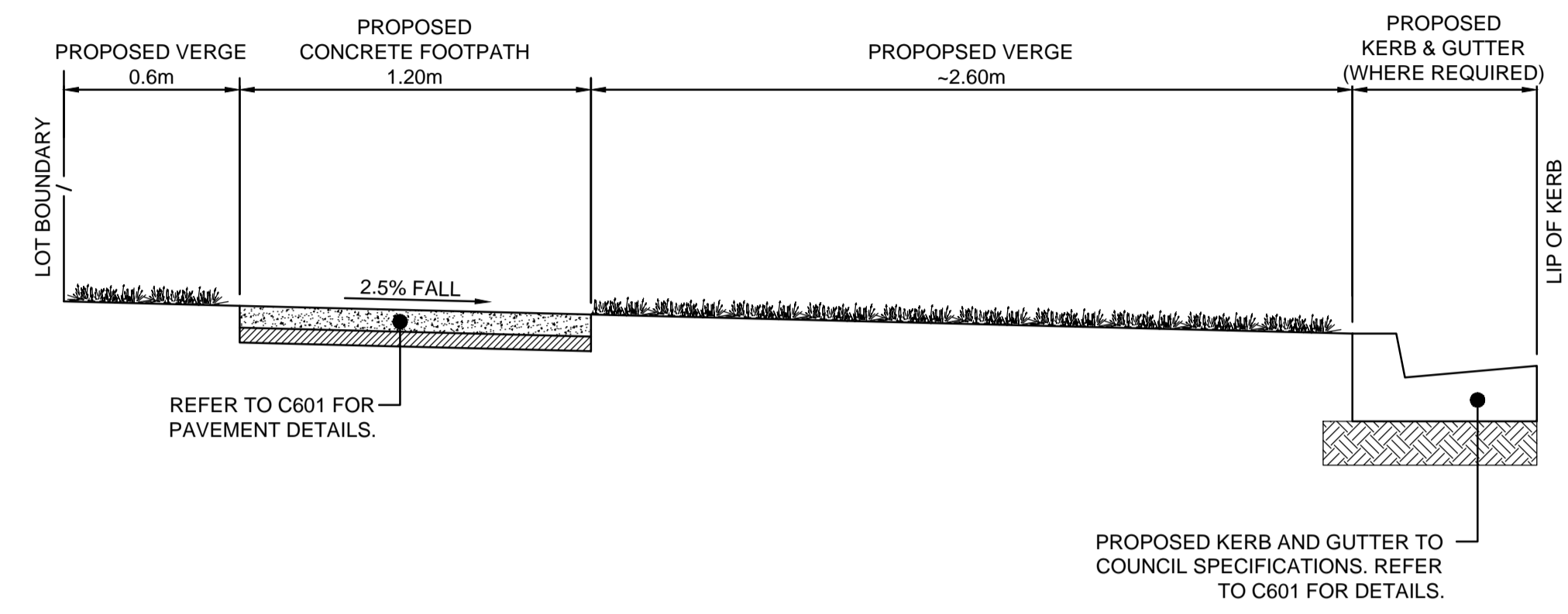

**DAVID ROAD - TYPICAL FOOTPATH CROSS SECTION**  
SCALE 1:20

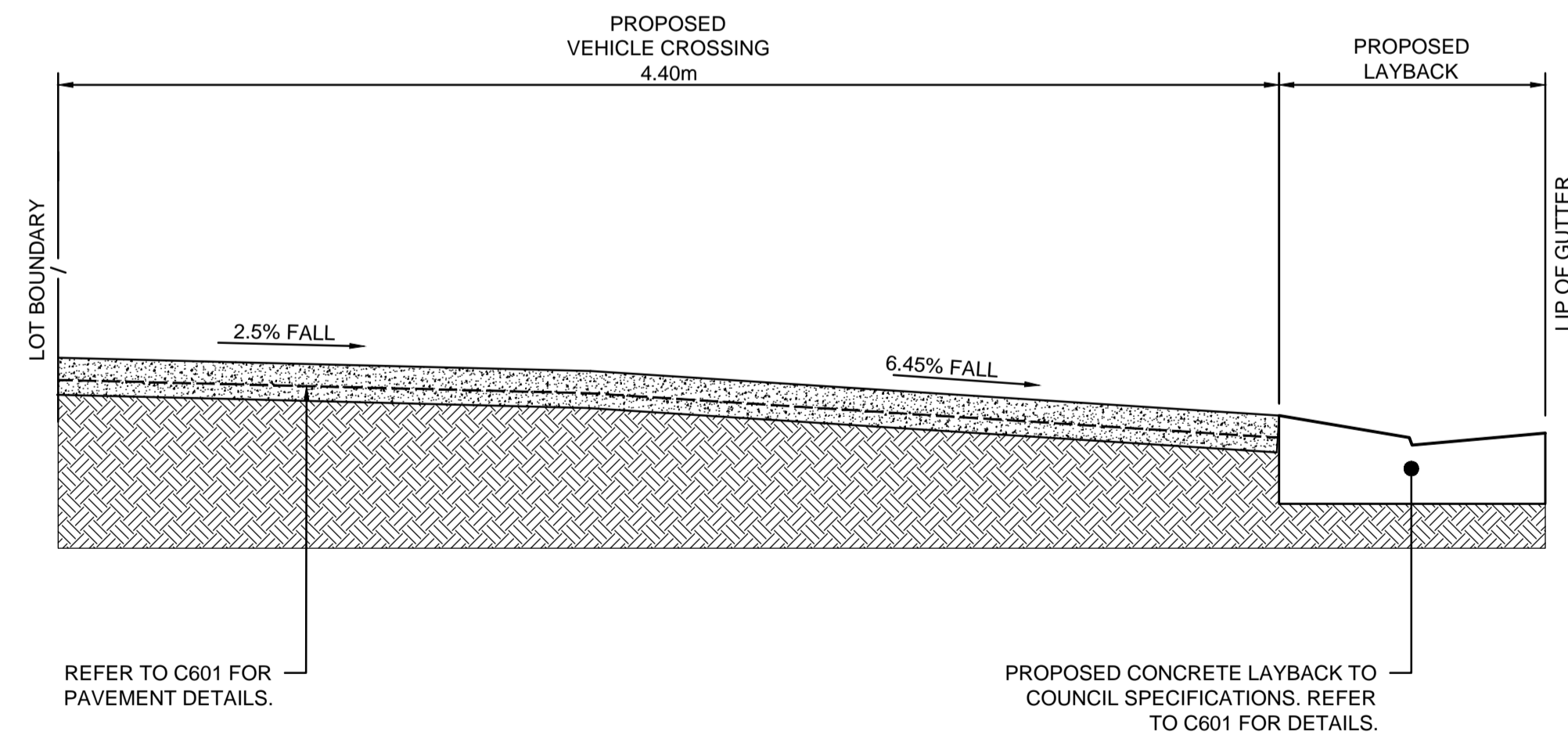

**DAVID ROAD - TYPICAL VEHICLE CROSSING SECTION**  
SCALE 1:20

**NOTE:**  
DRIVEWAY LEVELS: THE LEVEL AT A POINT 600mm FROM THE BOUNDARY ALIGNMENT TO BE 280mm ABOVE THE ADJACENT INVERT LEVEL.

NOT FOR CONSTRUCTION

Issue	Description	Date	Design	Checked
A	ISSUE FOR CONSTRUCTION CERTIFICATE	24/03/2023	P.B.T.	J.A.B.

Certification By Dr. Michal Chayya  
B.E., M.E. (Res), Ph.D., F.I.E. Aust., CPEng.,  
Civil & Structural Engineer

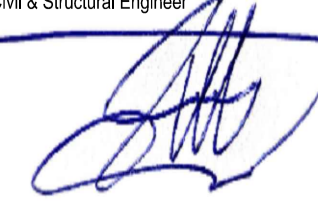

Architect  
**INTO Architecture**  
Scott Miner - Architect NSW Reg. #9100  
Mobile 0409 995 974  
Email scott@intoarchitecture.com.au

Client  
**JOANNE DRAYBI**  
Council  
**HORNSBY SHIRE COUNCIL**

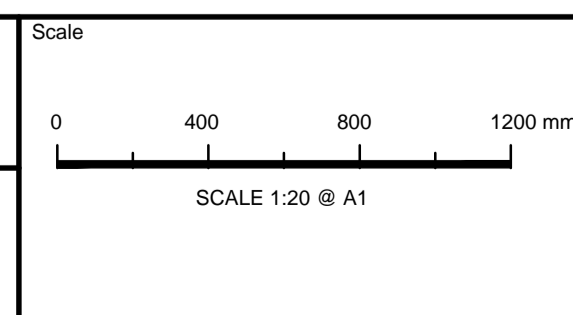

**TELFORD CIVIL**  
DESIGN & CONSTRUCTION EXCELLENCE

Level 14, 32 Smith Street, Parramatta NSW 2150  
PO BOX 3579 Parramatta 2124

Email : info@telfordcivil.com.au  
Phone : 02 7809 4931  
Company : Telford Consulting Pty Ltd

Project  
**94 DAVID ROAD, CASTLE HILL  
PUBLIC DOMAIN WORKS  
CIVIL ENGINEERING PLANS  
CONSTRUCTION CERTIFICATE**

Drawing Title <b>TYPICAL CROSS SECTIONS</b>			
Scale 1:20	A1	Project No. 23001	Dwg. No. C501

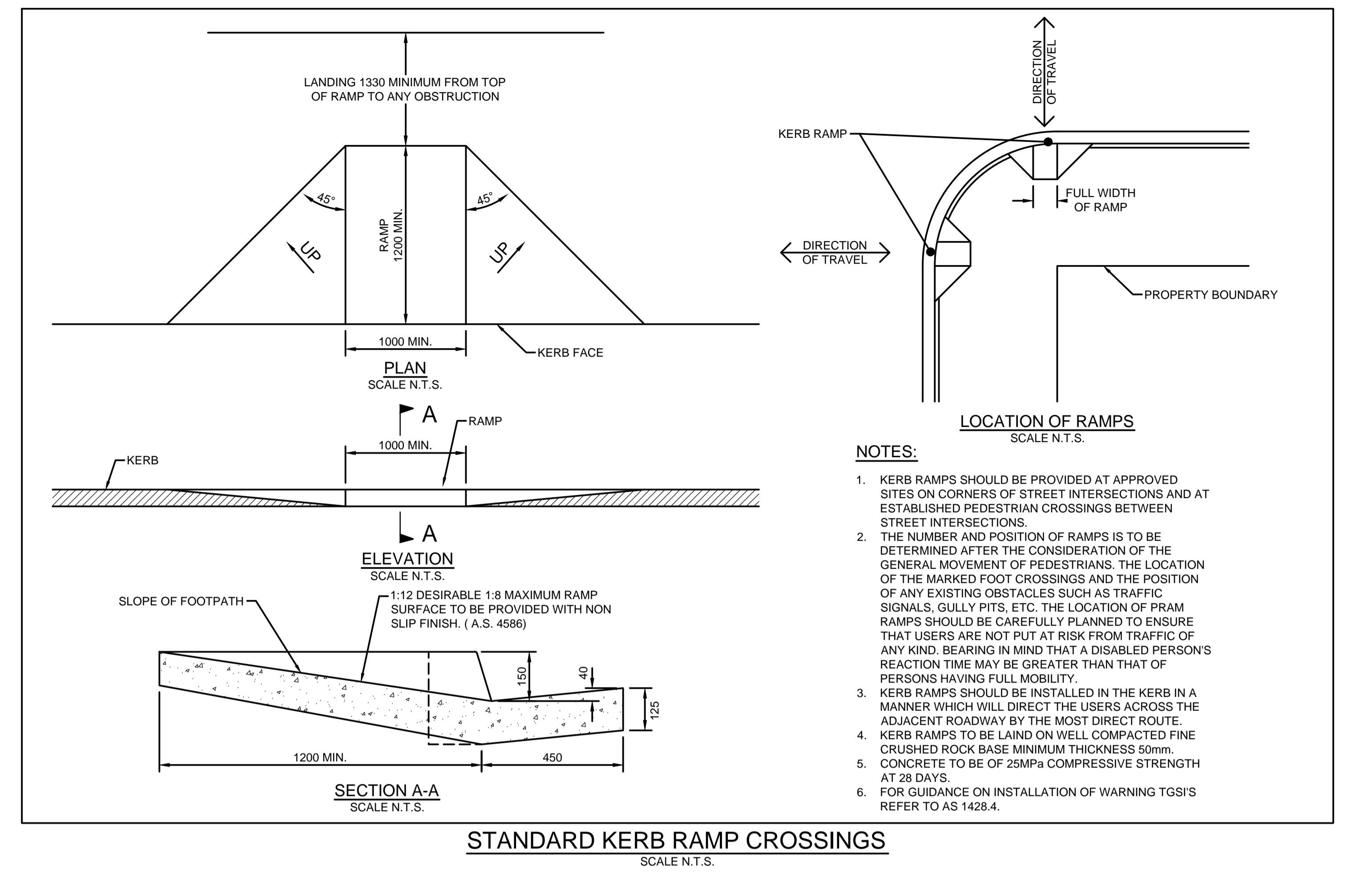
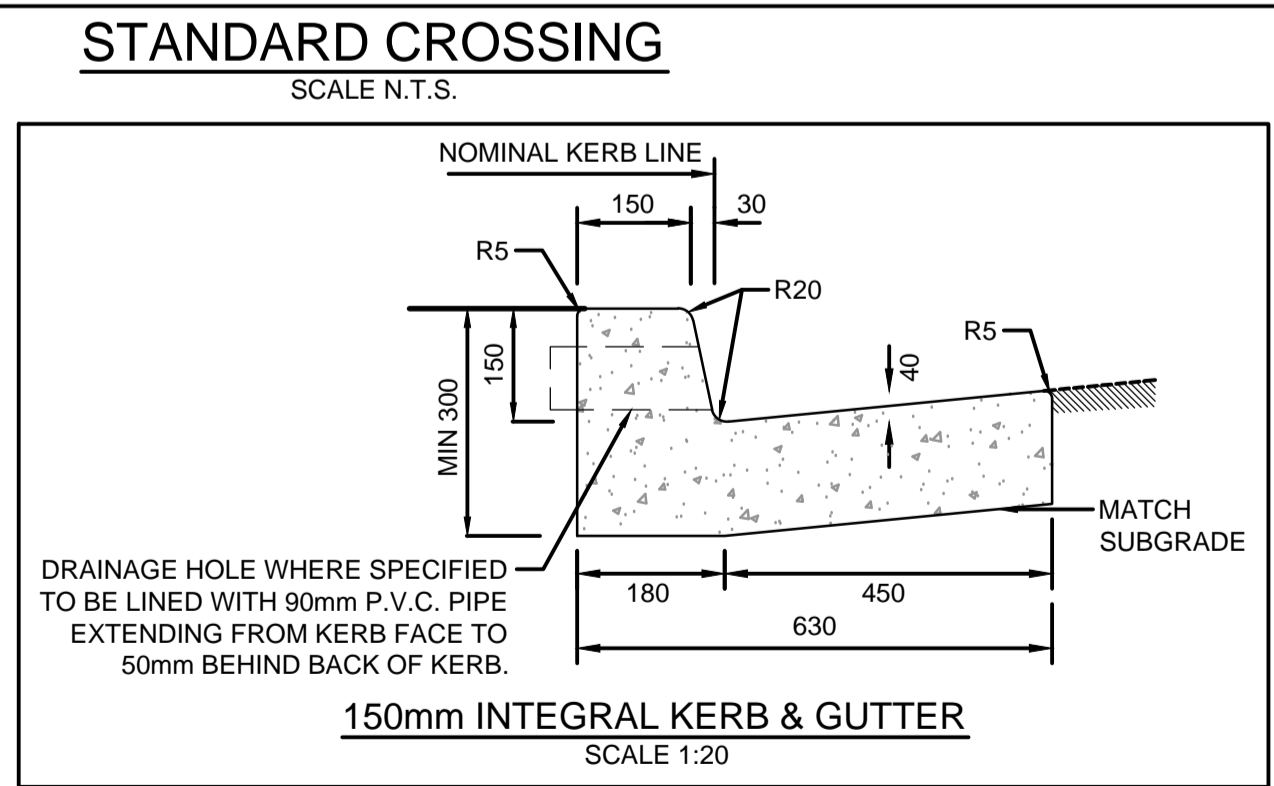
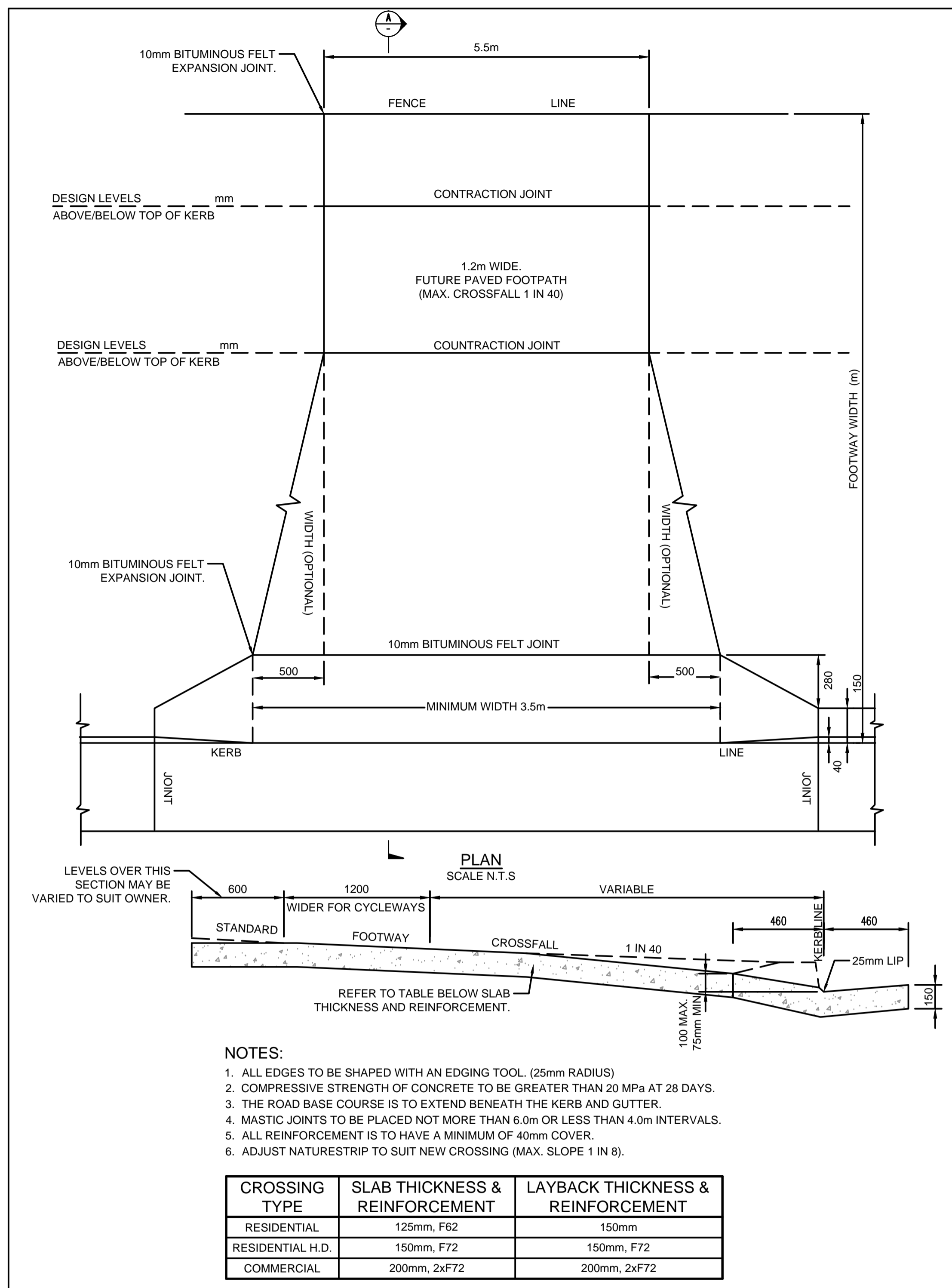

STANDARD KERB RAMP CROSSINGS  
SCALE N.T.S.

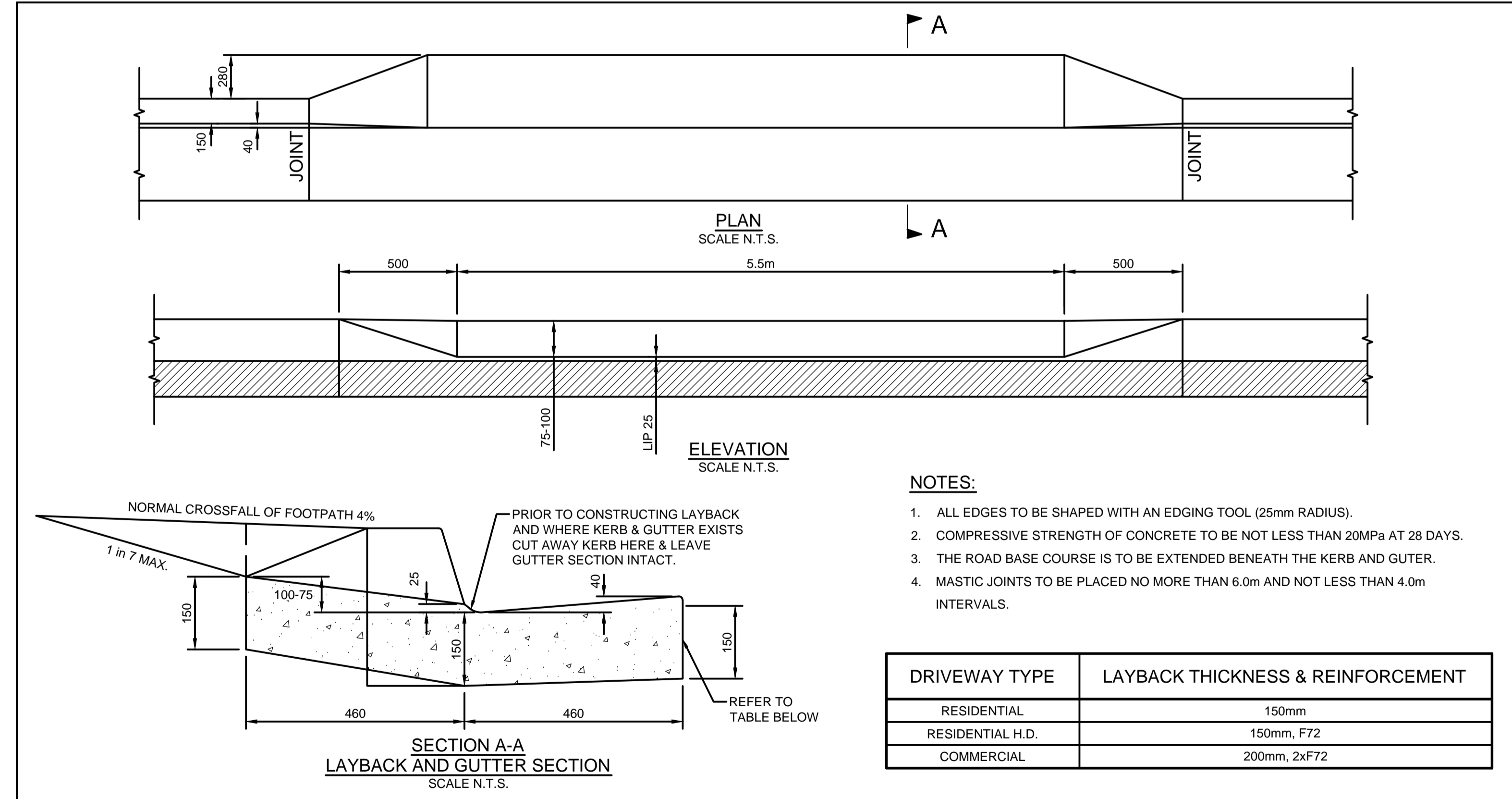

STANDARD LAYBACK  
SCALE N.T.S.

NOT FOR CONSTRUCTION

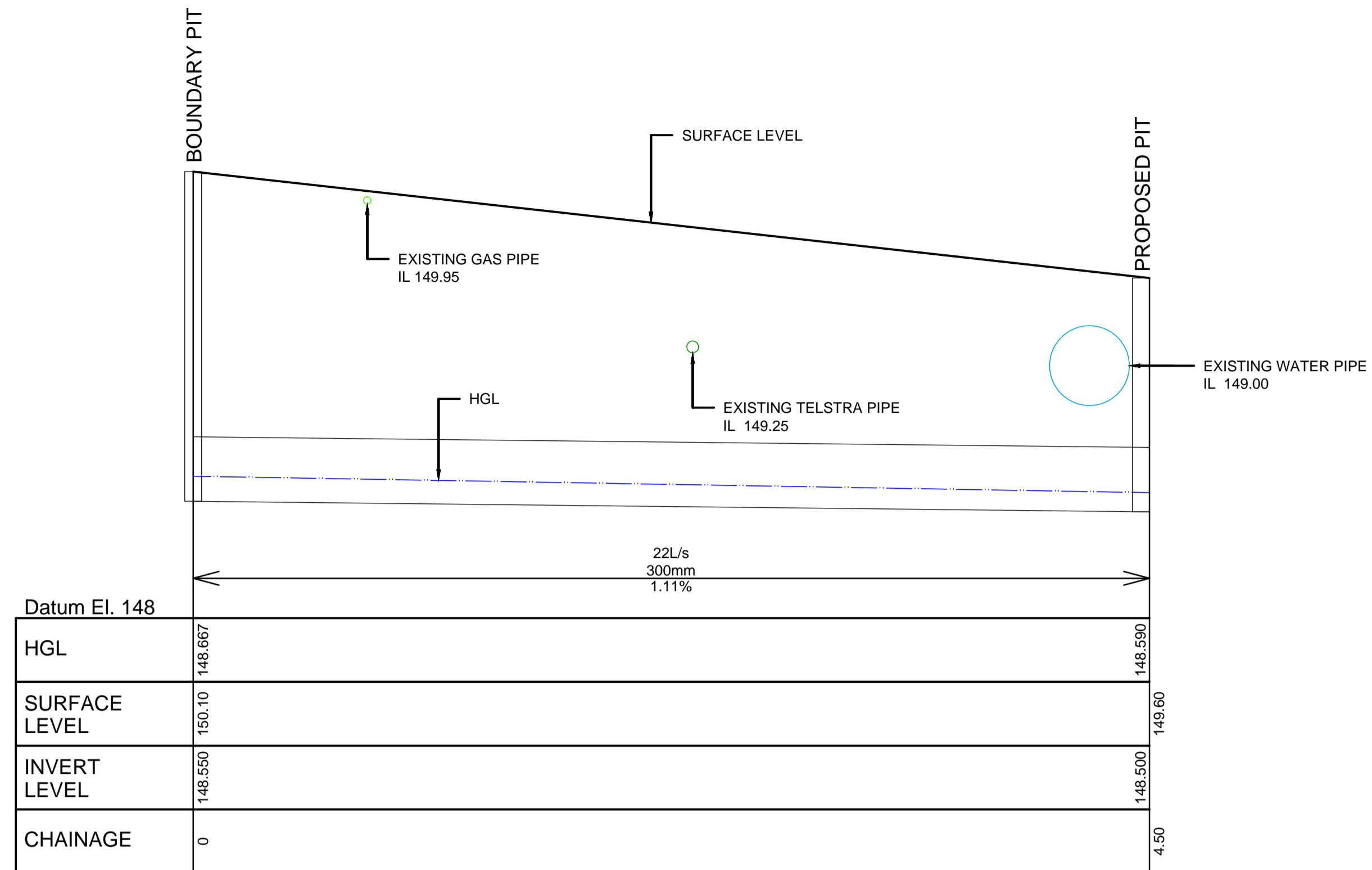

**STORMWATER LONGITUDINAL SECTION**  
SCALE 1:200

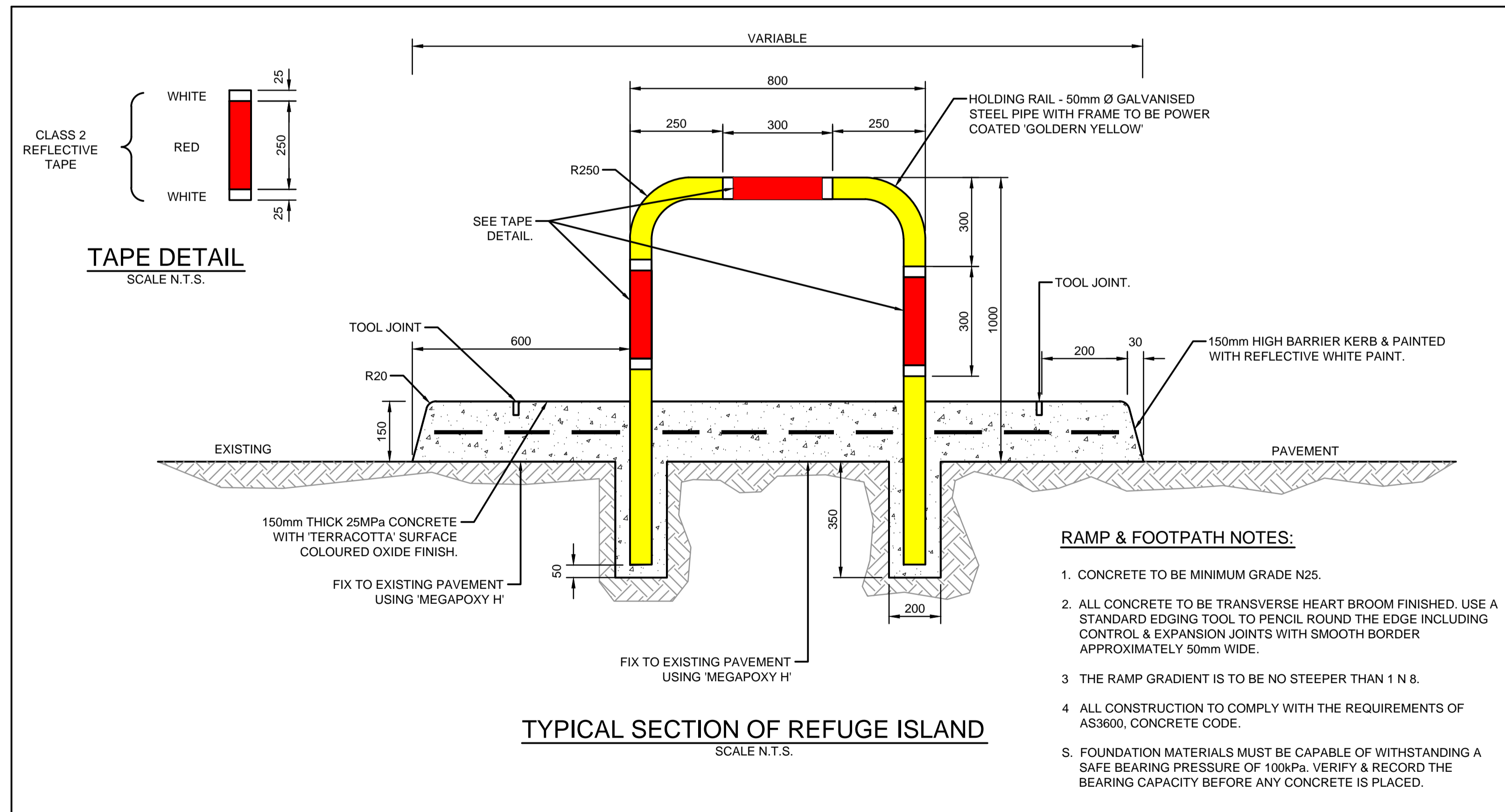

NOT FOR CONSTRUCTION

B	ISSUE FOR CONSTRUCTION CERTIFICATE	22/05/2023	J.E.H.	J.A.B.
A	ISSUE FOR CONSTRUCTION CERTIFICATE	24/03/2023	P.B.T.	J.A.B.
Issue	Description	Date	Design	Checked

Certification By Dr. Michel Chaaya  
B.E., M.E. (Res), Ph.D., F.I.E. Aust., CPEng.,  
Civil & Structural Engineer

**INTO Architecture**  
Scott Miner - Architect NSW Reg. #9100  
Mobile 0409 995 974  
Email scott@intoarchitecture.com.au

Client  
**JOANNE DRAYBI**  
Council  
**HORNSBY SHIRE COUNCIL**

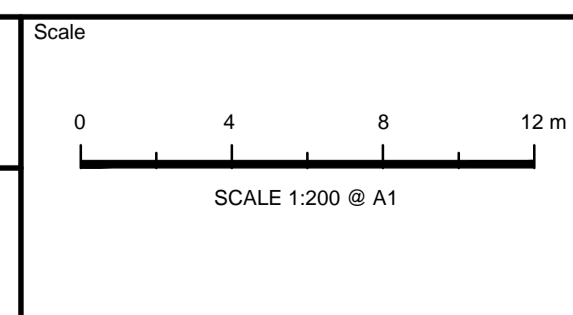

**TELFORD CIVIL**  
DESIGN & CONSTRUCTION EXCELLENCE

Level 14, 32 Smith Street, Parramatta NSW 2150  
PO BOX 3579 Parramatta 2124

Email : info@telfordcivil.com.au  
Phone : 02 7809 4931  
Company : Telford Consulting Pty Ltd

Project  
**94 DAVID ROAD, CASTLE HILL  
PUBLIC DOMAIN WORKS  
CIVIL ENGINEERING PLANS  
CONSTRUCTION CERTIFICATE**

Drawing Title <b>CONSTRUCTION NOTES AND DETAILS SHEET 2 OF 2</b>			
Scale As Shown	Project No. 23001	Dwg. No. C602	Issue B



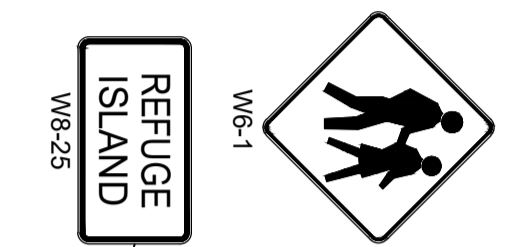

REFUGE ISLAND WB-25

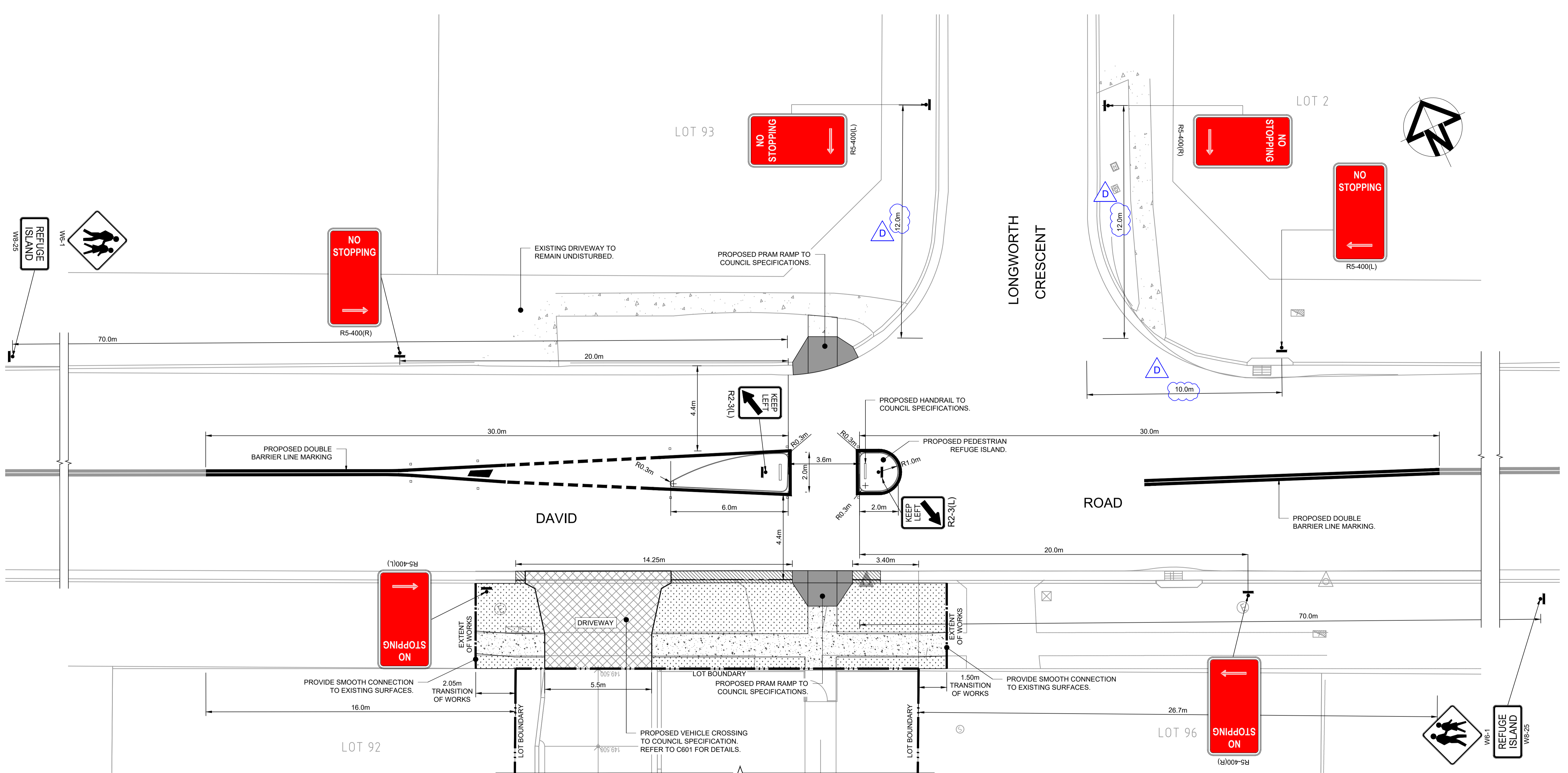

THIS PLAN IS SUBJECT TO HORNSBY LOCAL TRAFFIC COMMITTEE APPROVAL



NOTE: ALL EXISTING SERVICES TO BE ADJUSTED TO MATCH PROPOSED SURFACE LEVELS.

LEGEND

- LOT BOUNDARY
- PROPOSED KERB & GUTTER
- PROPOSED CONTROL LINE
- PROPOSED VERGE
- PROPOSED DRIVEWAY
- PROPOSED CONCRETE FOOTPATH
- PROPOSED PRAM RAMP TO COUNCIL SPECIFICATIONS
- RAISED REFLECTIVE PAVEMENT MARKERS
- PROPOSED SIGN POSTING
- LONGITUDINAL LINES
- EDGE LINES
- SINGLE BARRIER LINE
- DOUBLE BARRIER LINE

EXISTING SERVICES

- EXISTING ROAD CENTRE LINE
- EXISTING CONTOUR
- EXISTING KERB & GUTTER

NOT FOR CONSTRUCTION

D	ISSUE FOR CONSTRUCTION CERTIFICATE	10/07/2023	J.E.H.	J.A.B.
C	ISSUE FOR CONSTRUCTION CERTIFICATE	09/06/2023	J.E.H.	J.A.B.
B	ISSUE FOR CONSTRUCTION CERTIFICATE	22/05/2023	J.E.H.	J.A.B.
A	ISSUE FOR CONSTRUCTION CERTIFICATE	24/03/2023	P.B.T.	J.A.B.
Issue	Description	Date	Design	Checked

Certification By Dr. Michel Chaaya  
 B.E., M.E. (Res), Ph.D., F.I.E. Aust., CPEng,  
 Civil & Structural Engineer

Architect  
**INTO Architecture**  
 Scott Miner - Architect NSW Reg. #9100  
 Mobile 0409 995 974  
 Email scott@intoarchitecture.com.au

Client  
**JOANNE DRAYBI**  
 Council  
**HORNSBY SHIRE COUNCIL**

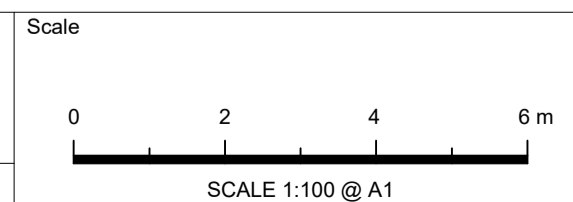

**TELFORD CIVIL**  
 DESIGN & CONSTRUCTION EXCELLENCE

Level 14, 32 Smith Street, Parramatta NSW 2150  
 PO BOX 3579 Parramatta 2124

Email : info@telfordcivil.com.au  
 Phone : 02 7809 4931  
 Company : Telford Consulting Pty Ltd

Project  
**94 DAVID ROAD, CASTLE HILL  
 PUBLIC DOMAIN WORKS  
 CIVIL ENGINEERING PLANS  
 CONSTRUCTION CERTIFICATE**

Drawing Title <b>PEDESTRIAN REFUGE PLAN</b>			
Scale 1:100	A1	Project No. 23001	Dwg. No. C701
			Issue D

**LEGEND**

- VEHICLE BODY
- - - VEHICLE BODY CLEARANCE (0.5m)
- VEHICLE BODY PATH

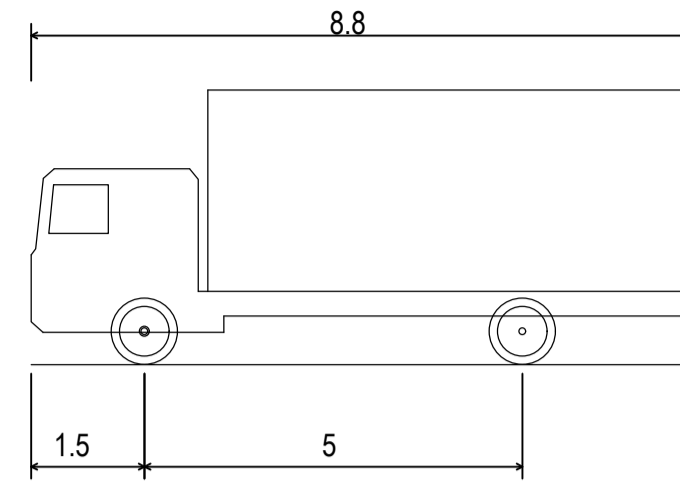
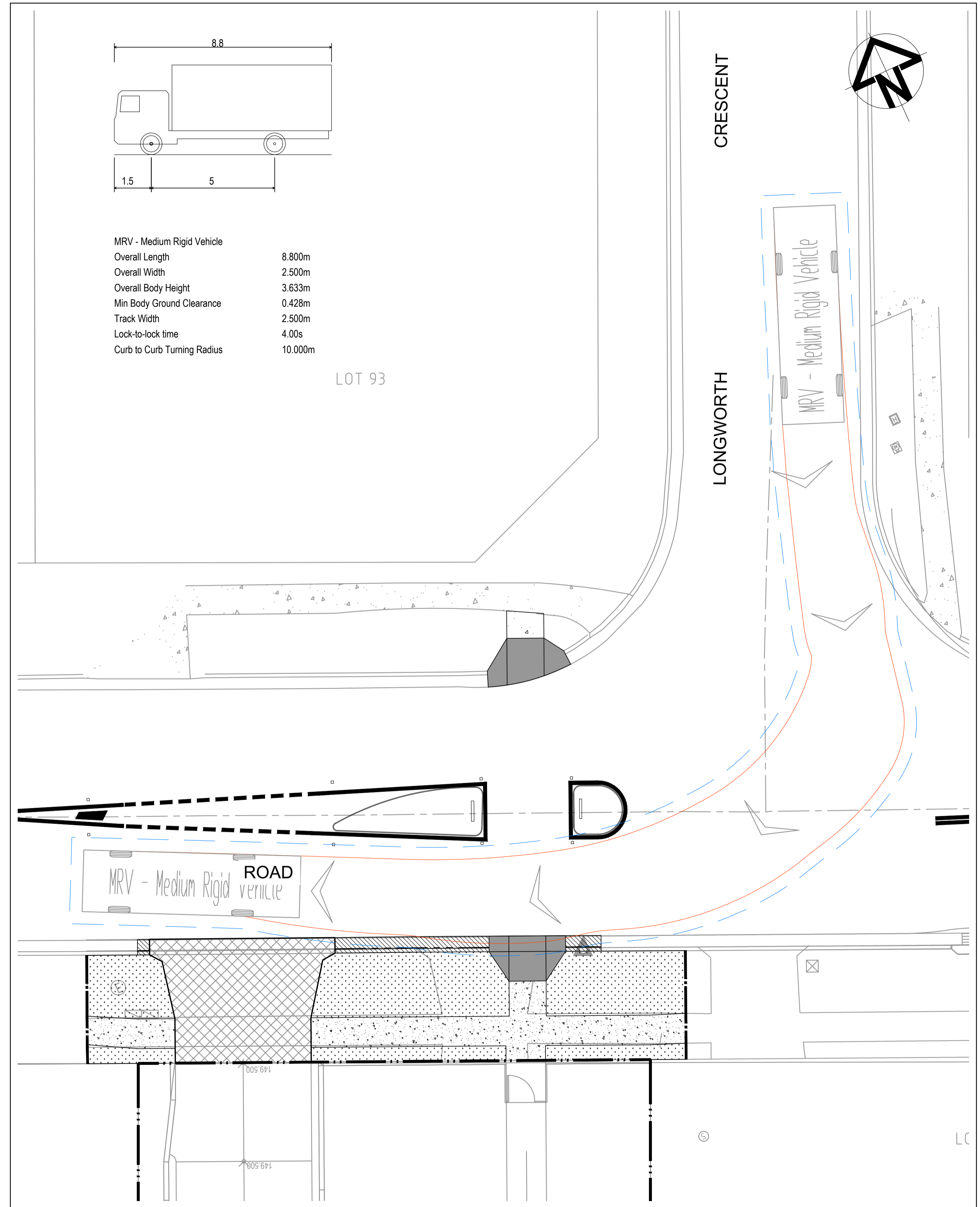
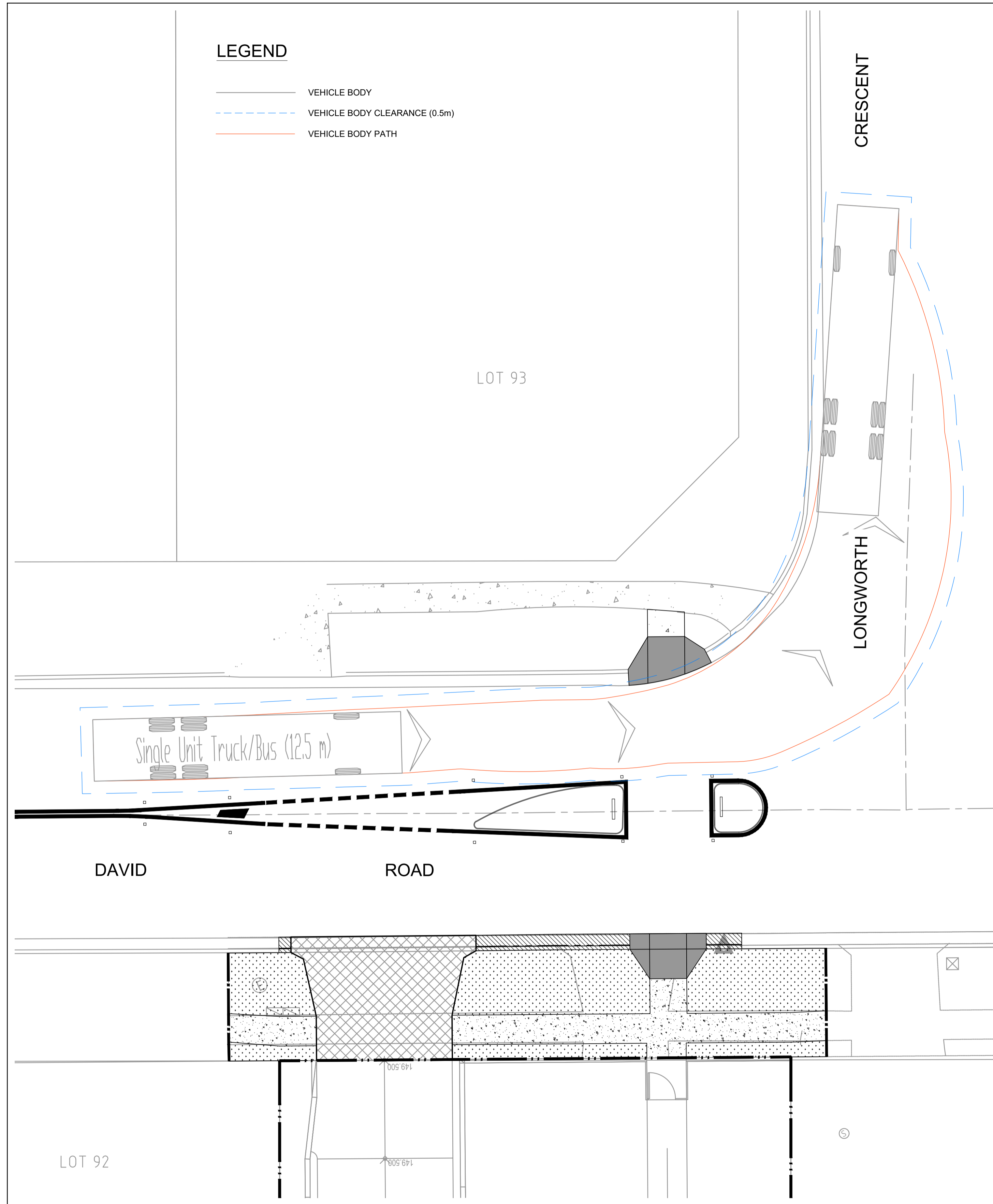

MRV - Medium Rigid Vehicle  
 Overall Length 8.800m  
 Overall Width 2.500m  
 Overall Body Height 3.633m  
 Min Body Ground Clearance 0.428m  
 Track Width 2.500m  
 Lock-to-lock time 4.00s  
 Curb to Curb Turning Radius 10.000m

NOT FOR CONSTRUCTION

Issue	Description	Date	Design	Checked
B	ISSUE FOR CONSTRUCTION CERTIFICATE	09/06/2023	J.E.H.	J.A.B.
A	ISSUE FOR CONSTRUCTION CERTIFICATE	22/05/2023	J.E.H.	J.A.B.

Certification By Dr. Michel Chaaya  
 B.E., M.E. (Res), Ph.D., F.I.E. Aust., CPEng,  
 Civil & Structural Engineer

Architect  
**INTO Architecture**  
 Scott Miner - Architect NSW Reg. #9100  
 Mobile 0409 995 974  
 Email scott@intoarchitecture.com.au

Client  
**JOANNE DRAYBI**  
 Council  
**HORNSBY SHIRE COUNCIL**

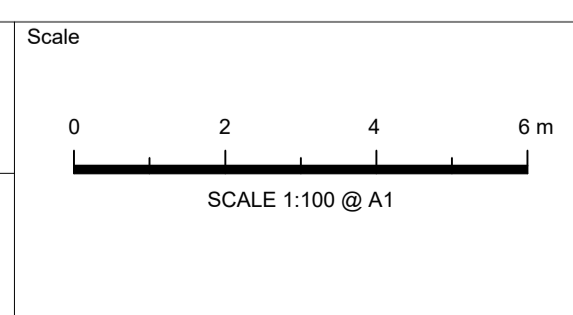

**TELFORD CIVIL**  
 DESIGN & CONSTRUCTION EXCELLENCE

Level 14, 32 Smith Street, Parramatta NSW 2150  
 PO BOX 3579 Parramatta 2124

Email : info@telfordcivil.com.au  
 Phone : 02 7809 4931  
 Company : Telford Consulting Pty Ltd

Project  
**94 DAVID ROAD, CASTLE HILL  
 PUBLIC DOMAIN WORKS  
 CIVIL ENGINEERING PLANS  
 CONSTRUCTION CERTIFICATE**

Drawing Title	<b>SWEPT PATH</b>		
Scale	A1	Project No.	Dwg. No.
1:100		23001	C801
Issue	B		