

SHERBROOK ROAD, ASQUITH PROPOSED RAISED PEDESTRIAN CROSSING

DRAWING SCHEDULE		
SHEET No.	TITLE	ISSUE
1	DRAWING SCHEDULE, LOCALITY PLAN, GENERAL NOTES & LEGEND.	1
2	GENERAL WORKS & SERVICES PLAN & CONCRETE NOTES.	1
3	SETOUT PLAN & CONCRETE JOINT DETAILS.	1
4	SECTIONS A & B & KERB BLISTER ISLAND (EASTERN SIDE) SETOUT PLAN.	1
5	SIGNS & LINE MARKING PLAN.	1

LEGEND

	EXISTING KERB & GUTTER.
	EXISTING STORMWATER PIPE.
	EXISTING CONCRETE PATH EDGE.
	EXISTING POWER POLE.
	EXISTING TELSTRA PIT.
	EXISTING SEWER MAINTENANCE HOLE.
	EXISTING SEWER MAIN.
	EXISTING WATER MAIN.
	EXISTING U/G TELSTRA CABLES.
	EXISTING U/G OPTIC FIBRE CABLES.
	EXISTING U/G ELECTRICAL CABLES.
	EXISTING GAS MAIN.
	EXISTING OVERHEAD ELECTRICAL CABLES.
	NEW BROOMED FINISH 25MPa CONCRETE MEDIAN INFILL (COLOUR: TERRACOTTA). REFER TO SHEET No.3 FOR DETAILS.
	EXTENT OF KERB RAMP & FOOTPATH RECONSTRUCTION.
	EXTENT OF RAISED PEDESTRIAN CROSSING. 200mm THICK REINFORCED CONCRETE WITH TWO LAYERS OF SL82 MESH.
	PROPOSED BARRIER KERB.

GENERAL NOTES:

- ALL WORKS TO BE CARRIED OUT IN ACCORDANCE WITH THE SPECIFICATIONS & REQUIREMENTS OF HORNSBY SHIRE COUNCIL.
- EROSION & SEDIMENT CONTROL MEASURES ARE TO BE INSTALLED IN ACCORDANCE WITH THE LANDCOM PUBLICATION:- "MANAGING URBAN STORMWATER, SOILS & CONSTRUCTION" Vol. 1, 4th EDITION.
- ALL DISTURBED AREAS OF THE SITE INCLUDING FENCES, GATES, DRIVEWAYS ETC. ARE TO BE REINSTATED WITH EXISTING OR MATCHING MATERIALS UNLESS NOTED OTHERWISE (COVERED WITH MULCH) AT THE COMPLETION OF THE WORKS.
- PROVIDE TRAFFIC MANAGEMENT, LINE MARKING & SIGNAGE IN ACCORDANCE WITH "THE MANUAL OF UNIFORM TRAFFIC CONTROL DEVICES" AS1742 REQUIREMENTS.
- APPROVED BY LOCAL TRAFFIC COMMITTEE ON 13/02/2018 REF: LTC 6/2018.



LOCALITY PLAN
NOT TO SCALE

TRAFFIC & ROAD SAFETY BRANCH

Senior Traffic Engineer
Name: R.ZARZYCKI Telephone: 9847 6684
Accepted as complying with the general intent of the design brief

Signed: _____ Date: _____	
Project Number 100197	
Sheet 1	of 5
Issue 1	
HSC Drawing Number 352.24	

Hornsby Shire Council Design & Construction Branch

TELEPHONE: (02) 9847 6666
FACSIMILE: (02) 9847 6999
Authorised for release - Manager Design & Construction
Name: R. RAJCA Signed: _____ Date: _____

Designer B RAJAKARUNA Signed: _____	Design Checked-Design Team Leader Signed: _____				
Drawn B RAJAKARUNA Signed: _____	Design Checked Signed: _____				
Surveyor R.TERTELI	NA Field Book	NA Level Book	AHD Datum		
Project Identifier\VCAD File Name H:\Sherbrook Rd_TR_100197\Design\Sherbrook Road Ped Crossing.dwg					
1	ISSUED FOR CONSTRUCTION	M. NOBILO			
Issue	Description	Name	Initial	Date	
Design not to be amended without authorisation by Manager Design & Construction					

Bar Scales

NOT TO SCALE

DO NOT SCALE, USE FIGURED DIMENSIONS ONLY



SHERBROOK ROAD, ASQUITH PROPOSED RAISED PEDESTRIAN CROSSING

DRAWING SCHEDULE, LOCALITY PLAN, GENERAL NOTES & LEGEND.

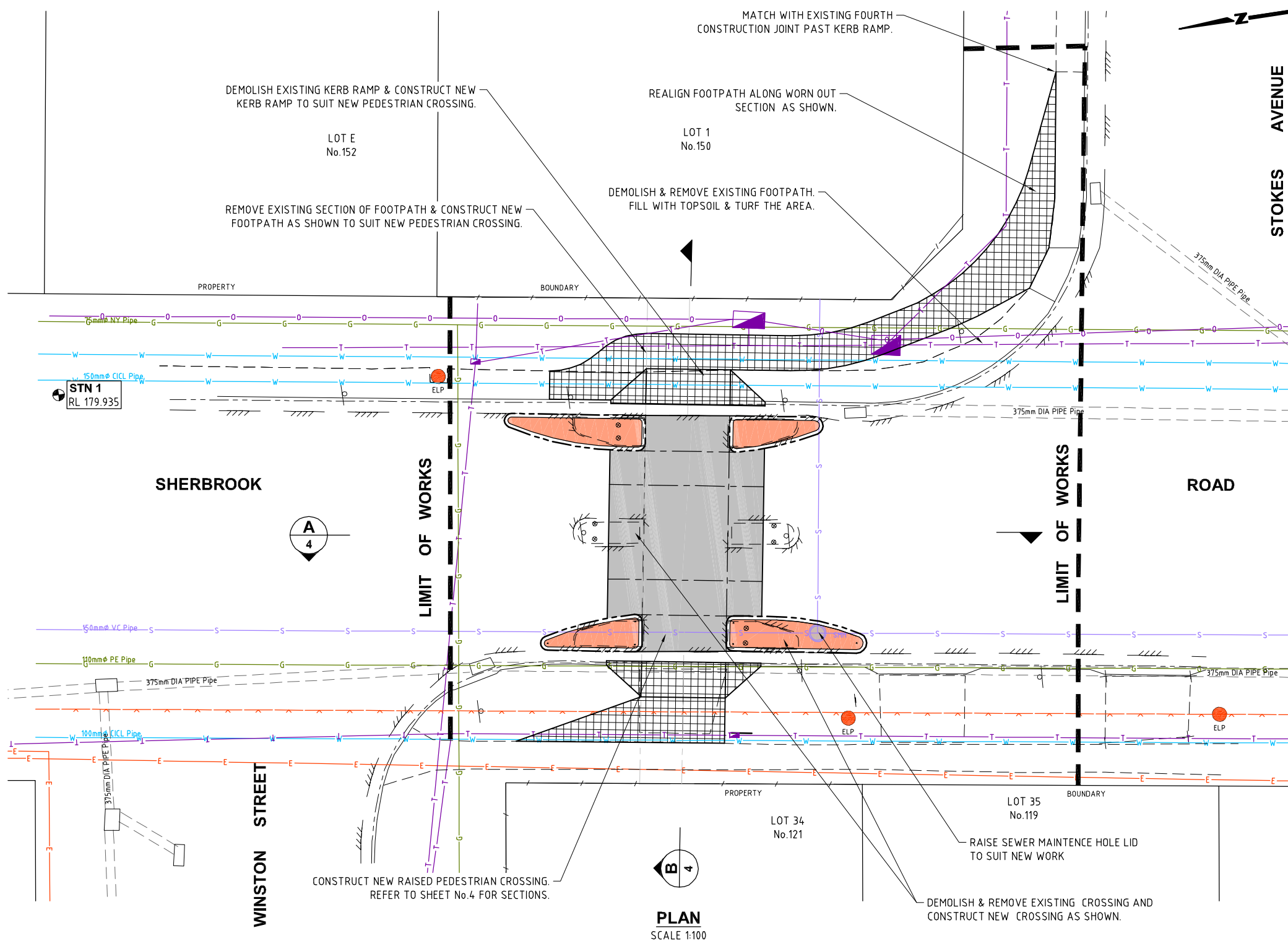

STOKES AVENUE

ROAD

SHERBROOK

WINSTON STREET

LIMIT OF WORKS

LIMIT OF WORKS

PLAN
SCALE 1:100

WARNING
BEWARE OF UNDERGROUND SERVICES
THE LOCATIONS OF UNDERGROUND SERVICES HAVE BEEN INTERPOLATED FROM KNOWN POSITIONS OF VALVES, MANHOLES ETC. AND/OR INFORMATION SUPPLIED BY SERVICE AUTHORITIES. NO RESPONSIBILITY IS TAKEN FOR THE ACCURACY OF THE INTERPOLATED INFORMATION SUPPLIED. ENSURE ALL SERVICES ARE ACCURATELY LOCATED PRIOR TO COMMENCEMENT OF WORK.

*** WARNING MAJOR OPTICAL FIBRE CABLES IN THIS AREA. OPTUS HAVE ADVISED THEY BE CONTACTED IF ENCROACHMENT DISTANCES ARE COMPROMISED. PH: 1800 505 777(OPTUS!)**

REFER TO SHEET No.3 FOR SETOUT & CONCRETE JOINT DETAILS.

REFER TO SHEET No.5 FOR SIGNS AND LINE MARKING DETAILS.

CONCRETE NOTES:
(USING STEEL REINFORCED CONCRETE U.N.O.)

- MATERIALS & CONSTRUCTION: TO AS 3600, AS 3610. STEEL REINFORCEMENT MATERIALS: TO AS 4671.
- CONCRETE QUALITY: TO AS 1379
READY MIX CONCRETE: TO AS 1379
a) DO NOT USE ADMIXTURES WITHOUT WRITTEN APPROVAL FROM CONSTRUCTION ENGINEER.
b) CEMENT: TYPE 'GP' OR 'GB' TO AS 3972.
c) MAXIMUM SIZE OF COARSE AGGREGATE: 20mm.
d) CONCRETE SLUMP: 80mm U.N.O.
- VERIFY STRENGTH BY PRODUCTION CONTROL TESTING TO AS 1379.
- NO UNSPECIFIED HOLES, PIPES, CONDUITS OR CHASES ARE PERMITTED WITHOUT WRITTEN APPROVAL FROM CONSTRUCTION ENGINEER.
- STRUCTURAL DIMENSIONS DO NOT INCLUDE TOPPING OR FINISHES.
- FORM CONSTRUCTION JOINTS ONLY AT LOCATIONS SHOWN ON DRAWINGS. DO NOT VARY WITHOUT WRITTEN APPROVAL FROM SUPERVISING ENGINEER.
- PREPARE COLD JOINTS BY LIGHT SCABBLING, REMOVAL OF DEBRIS & WASHING WITH CLEAN WATER.
- FOUNDATION MATERIALS MUST BE CAPABLE OF WITHSTANDING A SAFE BEARING PRESSURE OF 100kPa. VERIFY & RECORD THE BEARING CAPACITY BEFORE ANY CONCRETE IS PLACED.
- DO NOT PLACE CONCRETE UNTIL REINFORCEMENT (IF USED) & FORMWORK ARE INSPECTED BY SUPERVISING ENGINEER.
- THOROUGHLY CLEAN OUT ALL FORMWORK PRIOR TO POURING.
- DO NOT PLACE CONCRETE UNDER THE FOLLOWING CONDITIONS:
a) WHEN THE SURROUNDING OUTDOOR TEMPERATURE EXCEEDS 30°C.
b) WHEN THE SURROUNDING WIND SPEED EXCEEDS 12 KNOTS.
- DO NOT PLACE CONCRETE WHEN THE CONCRETE TEMPERATURE AT THE TIME OF DELIVERY EXCEEDS 35°C.
- IMPLEMENT THE FOLLOWING PROCEDURES TO MITIGATE PREMATURE DRYING & CRACKING OF THE CONCRETE:
a) IN HOT CONDITIONS, PROGRAM CONCRETE PLACEMENT FOR THE COOLER PART OF THE DAY (i.e. EARLY MORNING).
b) SPRAY EVAPORATIVE RETARDERS WITH FUGATIVE DYES (eg. ALIPHATIC ALCOHOL) OVER THE SURFACE IMMEDIATELY AFTER SCREEDING & WHILST BLEED WATER IS STILL PRESENT. REAPPLY IF THE SURFACE IS DISTURBED.
c) COMMENCE CURING IMMEDIATELY AFTER FINISHING. CURE FOR 7 DAYS.
- VIBRATE CONCRETE DURING PLACEMENT TO GIVE MAXIMUM COMPACTION WITHOUT SEGREGATION.
- SURFACE FINISH - REFER TO DRAWINGS FOR DETAILS.
- COMMENCE CURING OF ALL CONCRETE SURFACES IMMEDIATELY ON FINISHING & CONTINUE FOR 7 DAYS MIN.
- EXPANSION JOINTS & ISOLATION JOINTS ARE TO BE SEALED TO MANUFACTURER'S SPECIFICATIONS WITH A GUN GRADE POLYURETHANE LOW MODULUS SELF PRIMING SEALANT EQUAL TO 'TREMCO DYMONIC NT' (+100%, -50% MOVEMENT CAPACITY). SEALANT COLOUR AS SPECIFIED IN PROJECT DRAWINGS.

ELEMENT	CHARACTERISTIC CONCRETE STRENGTH(f'c) AT 28 DAYS	COVER	SPECIAL REQUIREMENTS
PLATFORM AND RAMPS	S 32 (U.N.O.)	AS DETAILED	BROOM FINISH
KERB RAMP	S 25 (U.N.O.)	AS DETAILED	BROOM FINISH

Hornsby Shire Council Design & Construction Branch <small>TELEPHONE: 021 9847 8666 FACSIMILE: 021 9847 8999</small> <small>Authorised for release - Manager Design & Construction Name: R. RAJCA Signed: Date:</small>	Designer B RAJAKARUNA Signed:	Design Checked-Design Team Leader Signed:	Drawn B RAJAKARUNA Signed:	<table border="1" style="width: 100%; border-collapse: collapse;"> <tr> <td style="width: 33%;">NA</td> <td style="width: 33%;">NA</td> <td style="width: 33%;">AHD</td> </tr> <tr> <td style="font-size: 8px;">Field Book</td> <td style="font-size: 8px;">Level Book</td> <td style="font-size: 8px;">Datum</td> </tr> </table>	NA	NA	AHD	Field Book	Level Book	Datum	<table border="1" style="width: 100%; border-collapse: collapse;"> <tr> <td style="width: 33%;">1</td> <td style="width: 33%;">ISSUED FOR CONSTRUCTION</td> <td style="width: 33%;">M. NOBILO</td> </tr> <tr> <td style="font-size: 8px;">Issue</td> <td style="font-size: 8px;">Description</td> <td style="font-size: 8px;">Name Initial Date</td> </tr> <tr> <td colspan="3" style="font-size: 8px;">Design not to be amended without authorisation by Manager Design & Construction</td> </tr> </table>	1	ISSUED FOR CONSTRUCTION	M. NOBILO	Issue	Description	Name Initial Date	Design not to be amended without authorisation by Manager Design & Construction		
	NA	NA	AHD																	
Field Book	Level Book	Datum																		
1	ISSUED FOR CONSTRUCTION	M. NOBILO																		
Issue	Description	Name Initial Date																		
Design not to be amended without authorisation by Manager Design & Construction																				
Project Identifier-\\CAD File Name H:\Sherbrook Rd_TR_100197\Design\Sherbrook Road Ped Crossing.dwg	TRIM Document Number D07684237	DO NOT SCALE, USE FIGURED DIMENSIONS ONLY																		

HORNSBY SHIRE COUNCIL
PO BOX 37, HORNSBY NSW 1630
DX 9855 HORNSBY

SHERBROOK ROAD, ASQUITH
PROPOSED RAISED PEDESTRIAN CROSSING

GENERAL WORKS & SERVICES PLAN & CONCRETE NOTES.

Project Number		100197
Sheet	of	Issue
2	5	1
HSC Drawing Number		352.24

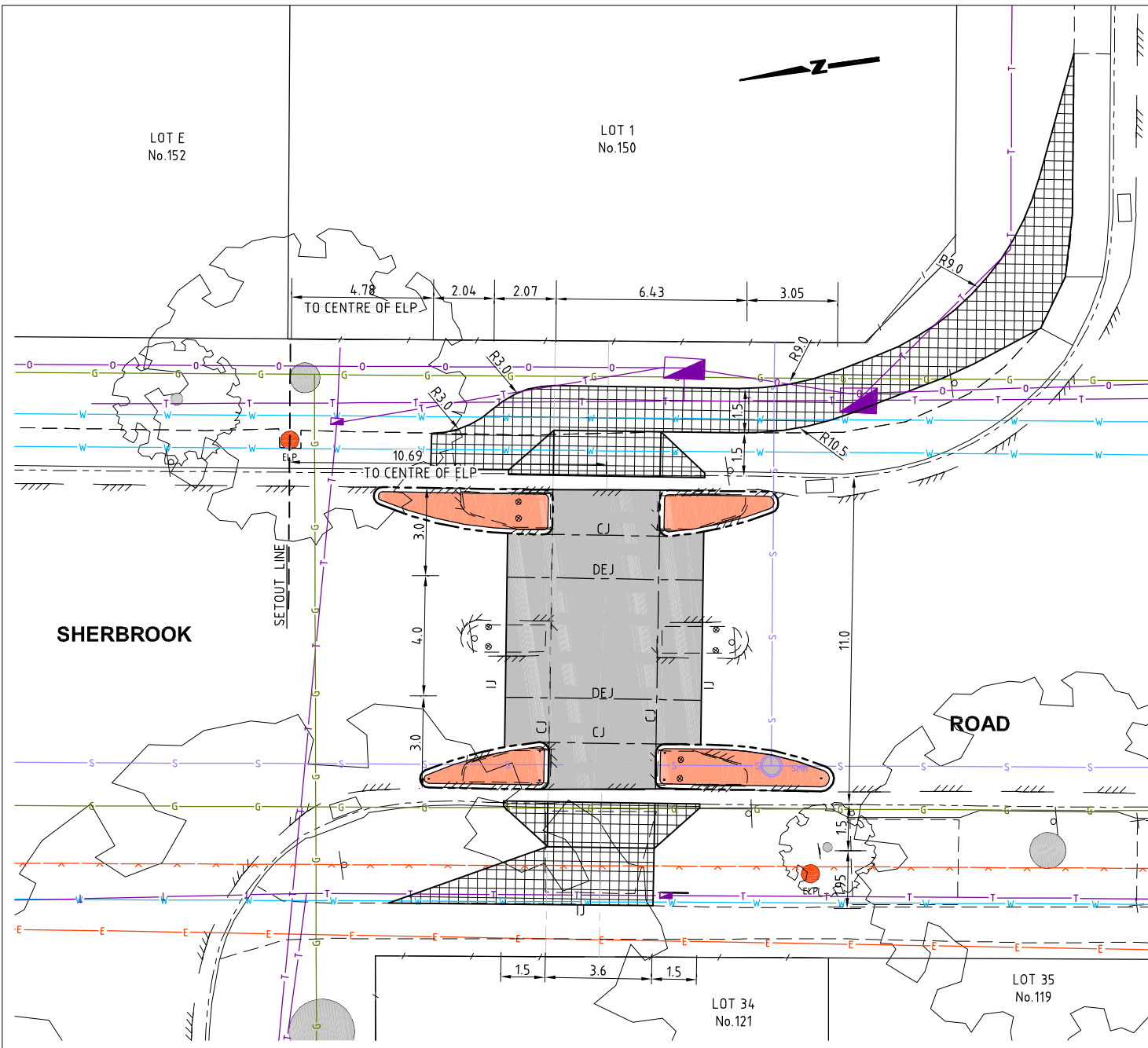

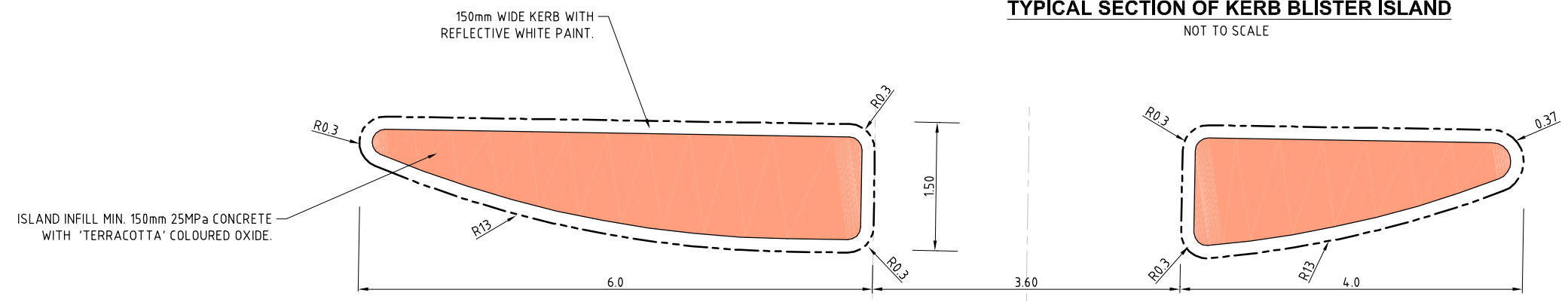
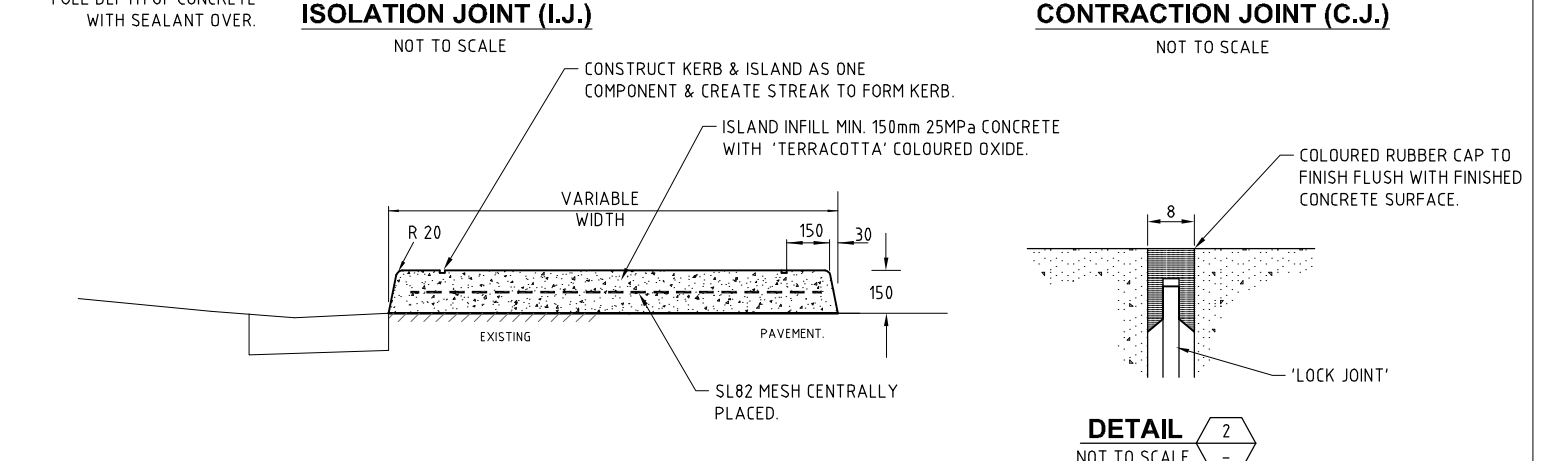
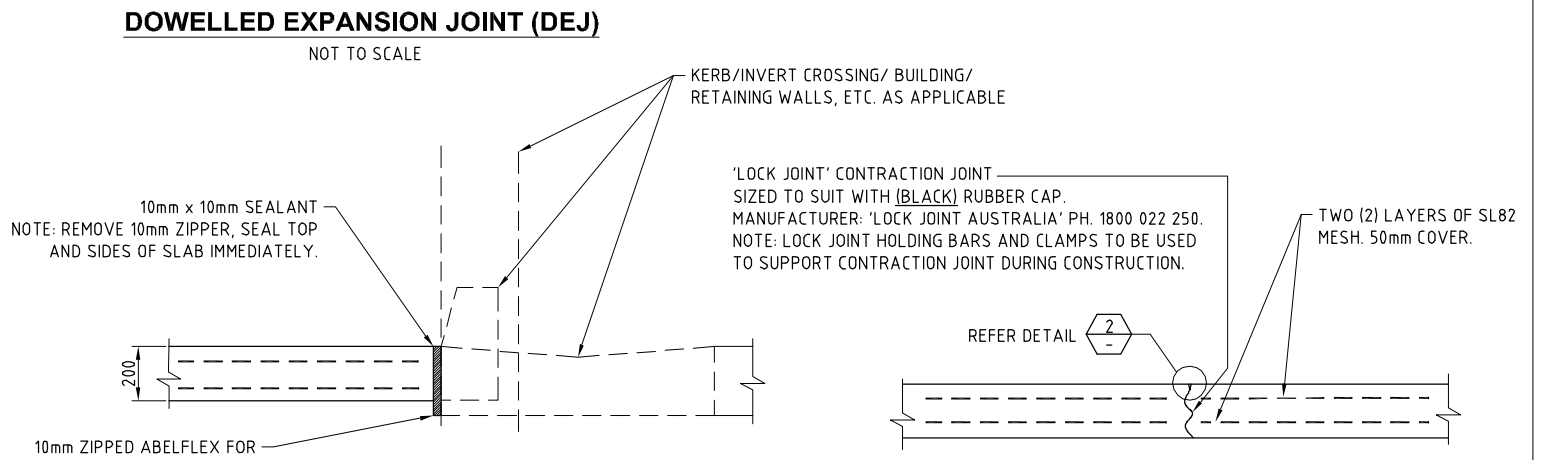
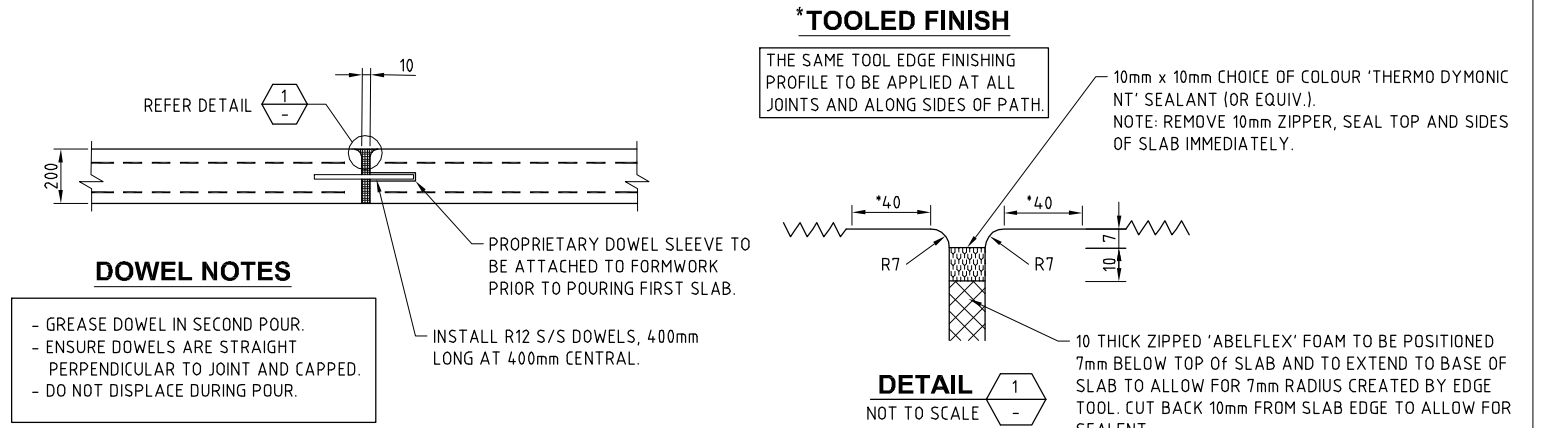

SETOUT & CONCRETE JOINT PLAN
SCALE 1:100

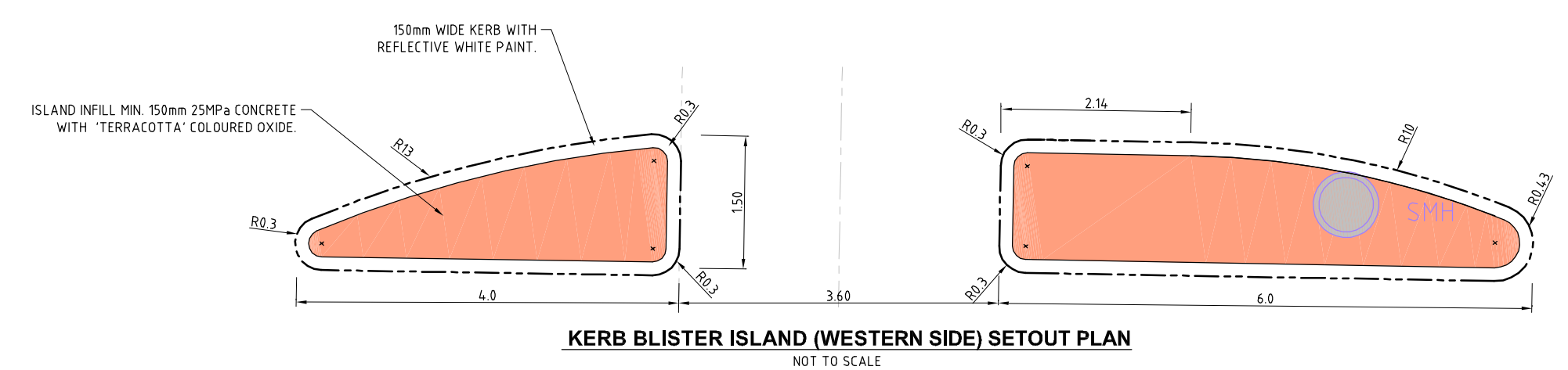
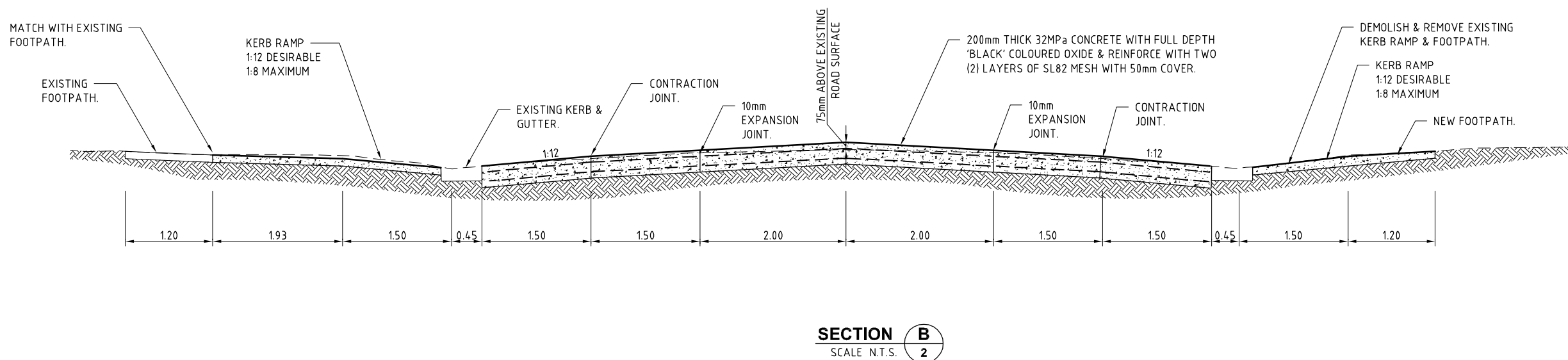
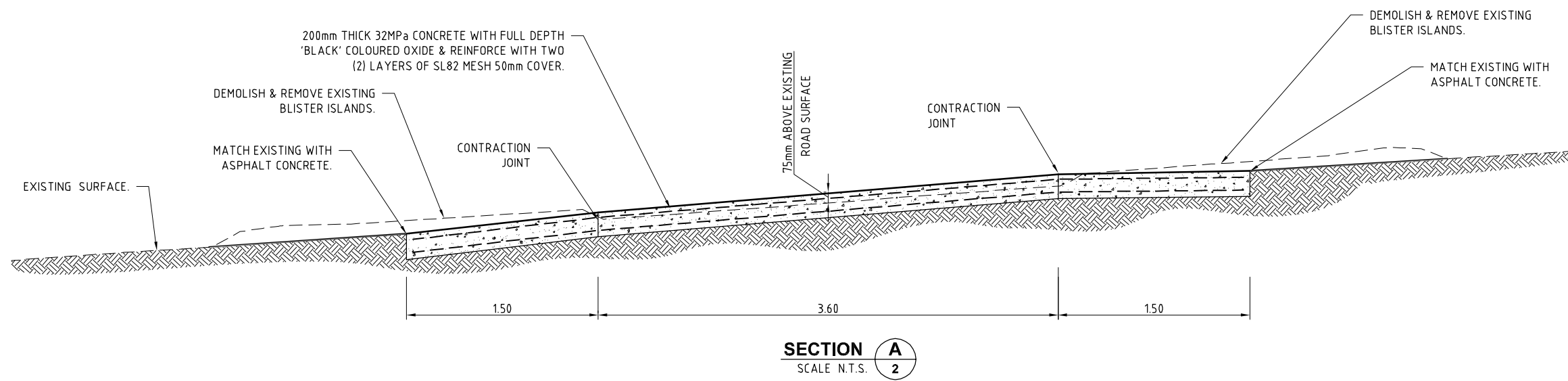

KERB BLISTER ISLAND (EASTERN SIDE) SETOUT PLAN
NOT TO SCALE

Hornsby Shire Council Design & Construction Branch TELEPHONE: 021 9847 8666 FACSIMILE: 021 9847 8999 Authorised for release - Manager Design & Construction Name: R. RAJCA Signed: Date:	Designer B RAJAKARUNA Signed:	Design Checked-Design Team Leader Signed:								Bar Scales AS SHOWN	 PO BOX 37, HORNSBY NSW 1630 DX 9855 HORNSBY	SHERBROOK ROAD, ASQUITH PROPOSED RAISED PEDESTRIAN CROSSING SETOUT PLAN & CONCRETE JOINT DETAILS.	Project Number 100197	Sheet of 3 5	Issue 1
	Drawn B RAJAKARUNA Signed:	NA Field Book	NA Level Book	AHD Datum	Project Identifier\VCAD File Name H:\Sherbrook Rd_TR_100197\Design\Sherbrook Road Ped Crossing.dwg	TRIM Document Number D07684237	1 Issue	ISSUED FOR CONSTRUCTION Description	M. NOBILO Name				Initial Date	DO NOT SCALE, USE FIGURED DIMENSIONS ONLY	HSC Drawing Number 352.24



Hornsby Shire Council Design & Construction Branch <small>TELEPHONE: 021 9847 6666 FACSIMILE: 021 9847 6999</small>	Designer B RAJAKARUNA Signed: _____	Design Checked-Design Team Leader Signed: _____			Bar Scales NOT TO SCALE	 SHERBROOK ROAD, ASQUITH PROPOSED RAISED PEDESTRIAN CROSSING	Project Number 100197
	Drawn B RAJAKARUNA Signed: _____	Drawing Checked Signed: _____	Surveyor R.TERTELI	NA <small>Field Book</small>			NA <small>Level Book</small>
Project Identifier\CAD File Name H:\Sherbrook Rd_TR_100197\Design\Sherbrook Road Ped Crossing.dwg	TRIM Document Number D07684237	1 ISSUED FOR CONSTRUCTION Description	M. NOBILO Name	Initial Date	DO NOT SCALE, USE FIGURED DIMENSIONS ONLY	SECTIONS A & B & KERB BLISTER ISLAND (EASTERN SIDE) SETOUT PLAN	HSC Drawing Number 352.24
Authorised for release - Manager Design & Construction Name: R. RAJCA Signed: _____ Date: _____	Design not to be amended without authorisation by Manager Design & Construction						

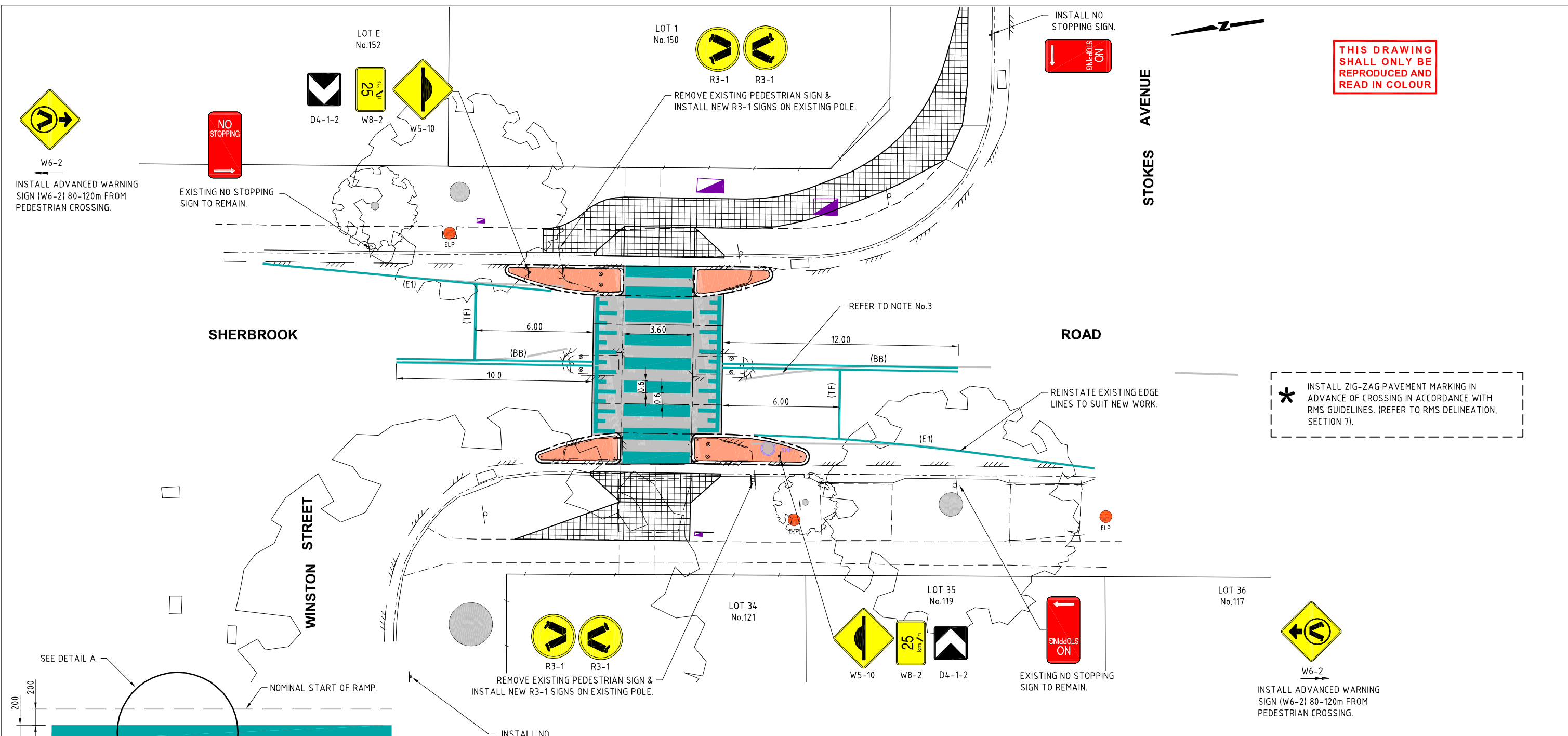

THIS DRAWING SHALL ONLY BE REPRODUCED AND READ IN COLOUR

* INSTALL ZIG-ZAG PAVEMENT MARKING IN ADVANCE OF CROSSING IN ACCORDANCE WITH RMS GUIDELINES. (REFER TO RMS DELINEATION, SECTION 7).

SIGNS & LINE MARKING PLAN
SCALE 1:100

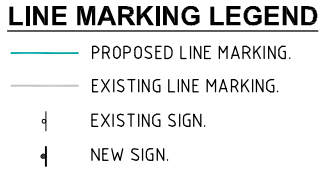
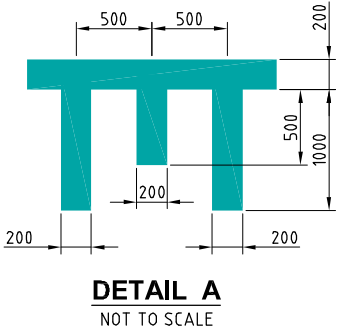
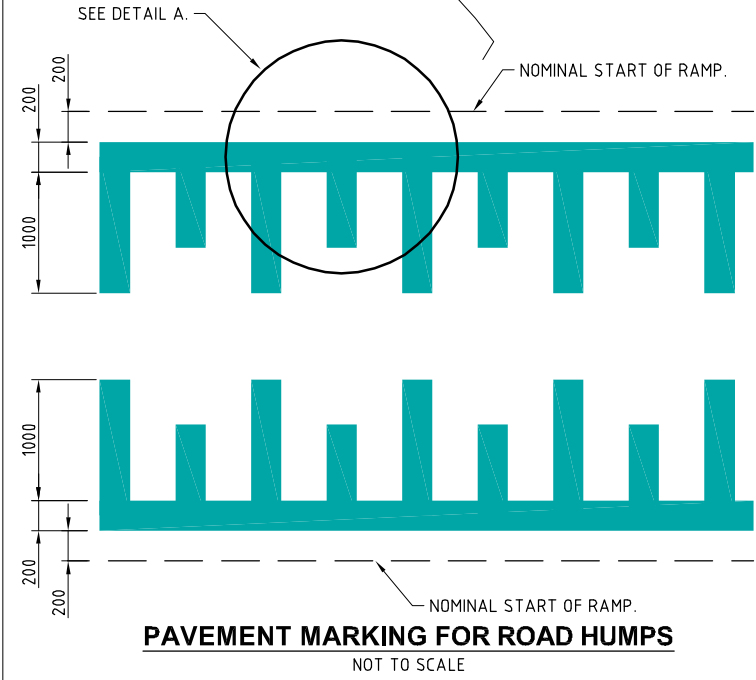

LINE MARKING NOTES

1. SIGNS & LINE MARKING TO BE INSTALLED IN ACCORDANCE WITH MANUAL OF UNIFORM TRAFFIC CONTROL DEVICES/ AS1742 REQUIREMENTS.
2. WHERE POSSIBLE EXISTING SIGNAGE IS TO BE CLEANED & REUSED TO SUIT NEW WORK.
3. REMOVE REDUNDANT LINE MARKING.
4. KERB ON MEDIAN ISLANDS SHALL BE PAINTED WITH REFLECTIVE WHITE PAINT.
5. TEMPORARY 'CHANGED TRAFFIC CONDITIONS AHEAD' (T1-23) SIGNS TO BE INSTALLED ON ALL APPROACHES APPROXIMATELY 100m FROM LIMIT OF WORKS (TYPICAL) AT THE COMMENCEMENT OF WORKS & UNTIL 6 MONTHS AFTER COMPLETION.
6. APPROVED BY LOCAL TRAFFIC COMMITTEE 13/02/2018 - REFERENCE: LTC6/2018.

Hornsby Shire Council
Design & Construction
Branch

Designer
B RAJAKARUNA
Signed: _____
Drawn
B RAJAKARUNA
Signed: _____
Surveyor
R.TERTELI
NA NA AHD
Field Book Level Book Datum
Project Identifier \\\CAD File Name
H:\\\\Sherbrook Rd_TR_100197\\Design\\Sherbrook Road Ped Crossing.dwg
TRIM Document Number
D07684237

Issue	Description	Name	Initial	Date
1	ISSUED FOR CONSTRUCTION	M. NOBILO		

Design not to be amended without authorisation by Manager Design & Construction

Bar Scales
AS SHOWN
DO NOT SCALE, USE FIGURED DIMENSIONS ONLY



SHERBROOK ROAD, ASQUITH
PROPOSED RAISED PEDESTRIAN CROSSING

SIGNS & LINE MARKING PLAN.

Project Number	100197		
Sheet of	5	5	Issue
HSC Drawing Number	352.24		