

# THE PROMENADE, CHELTENHAM PROPOSED WOMBAT CROSSING

DRAWING SCHEDULE		
SHEET No.	TITLE	ISSUE
1	DRAWING SCHEDULE, LOCALITY PLAN, GENERAL NOTES & LEGEND.	1
2	GENERAL WORKS & SERVICES PLAN.	1
3	CONCRETE NOTES & JOINT DETAILS.	1
4	SETOUT PLAN & STATION DETAILS.	1
5	SECTIONS A & B.	1
6	SIGNS & LINE MARKING PLAN.	1

### GENERAL NOTES:

- ALL WORKS TO BE CARRIED OUT IN ACCORDANCE WITH THE REQUIREMENTS & SPECIFICATIONS OF HORNSBY SHIRE COUNCIL.
- PROVIDE TRAFFIC MANAGEMENT, LINE MARKING & SIGNAGE IN ACCORDANCE WITH THE TRANSPORT FOR NEW SOUTH WALES "TRAFFIC CONTROL AT WORK SITES" TECHNICAL MANUAL & AS1742.3 REQUIREMENTS.
- SERVICES SHOWN ON THESE PLANS HAVE BEEN LOCATED FROM INFORMATION SUPPLIED FROM THE RELEVANT AUTHORITIES VIA A "DIAL BEFORE YOU DIG" ENQUIRY. THE LOCATION OF SERVICES SHOWN ON THESE DRAWINGS HAVE BEEN PLOTTED AS ACCURATELY AS POSSIBLE FROM DIAGRAMS PROVIDED BY SERVICE AUTHORITIES & FIELD INVESTIGATIONS & ARE TO BE VERIFIED PRIOR TO CONSTRUCTION.
- EROSION & SEDIMENT CONTROL MEASURES ARE TO BE INSTALLED IN ACCORDANCE WITH THE LANDCOM PUBLICATION - "MANAGING URBAN STORMWATER, SOILS & CONSTRUCTION" Vol. 1, 4th EDITION.
- ALL DISTURBED AREAS OF THE SITE ARE TO BE REINSTATED WITH EXISTING OR MATCHING MATERIALS UNLESS NOTED OTHERWISE AT THE COMPLETION OF THE WORKS.
- WHERE WORKS ARE ADJACENT TO EXISTING STRUCTURES UNDERTAKE A DILAPIDATION SURVEY OF EXISTING ADJACENT STRUCTURES BEFORE COMMENCEMENT OF ANY WORKS.
- THIS PLAN WAS APPROVED BY THE LOCAL TRAFFIC COMMITTEE ON REF LTC.

### ACCESS & SAFETY NOTES:

- THE CONTRACTOR SHALL COMPLY WITH ALL STATUTORY & INDUSTRIAL REQUIREMENTS FOR PROVISION OF A SAFE WORKING ENVIRONMENT INCLUDING TRAFFIC CONTROL.
- THE CONTRACTOR SHALL PROVIDE TRAFFIC MANAGEMENT PLANS FOR THE PROPOSED WORKS COMPLETED BY A SUITABLY QUALIFIED PERSON & APPROVED BY COUNCIL/REGULATORY AUTHORITY. WORK IS NOT TO COMMENCE ON SITE PRIOR TO APPROVAL OF TRAFFIC MANAGEMENT SCHEME.
- THE CONTRACTOR SHALL ENSURE THAT AT ALL TIMES ACCESS TO BUILDINGS/RESIDENCES ADJACENT TO THE WORKS IS NOT DISRUPTED.
- WHERE NECESSARY THE CONTRACTOR SHALL PROVIDE SAFE PASSAGE OF EMERGENCY SERVICE VEHICLES AND/OR EMERGENCY SERVICE PERSONNEL THROUGH THE SITE.

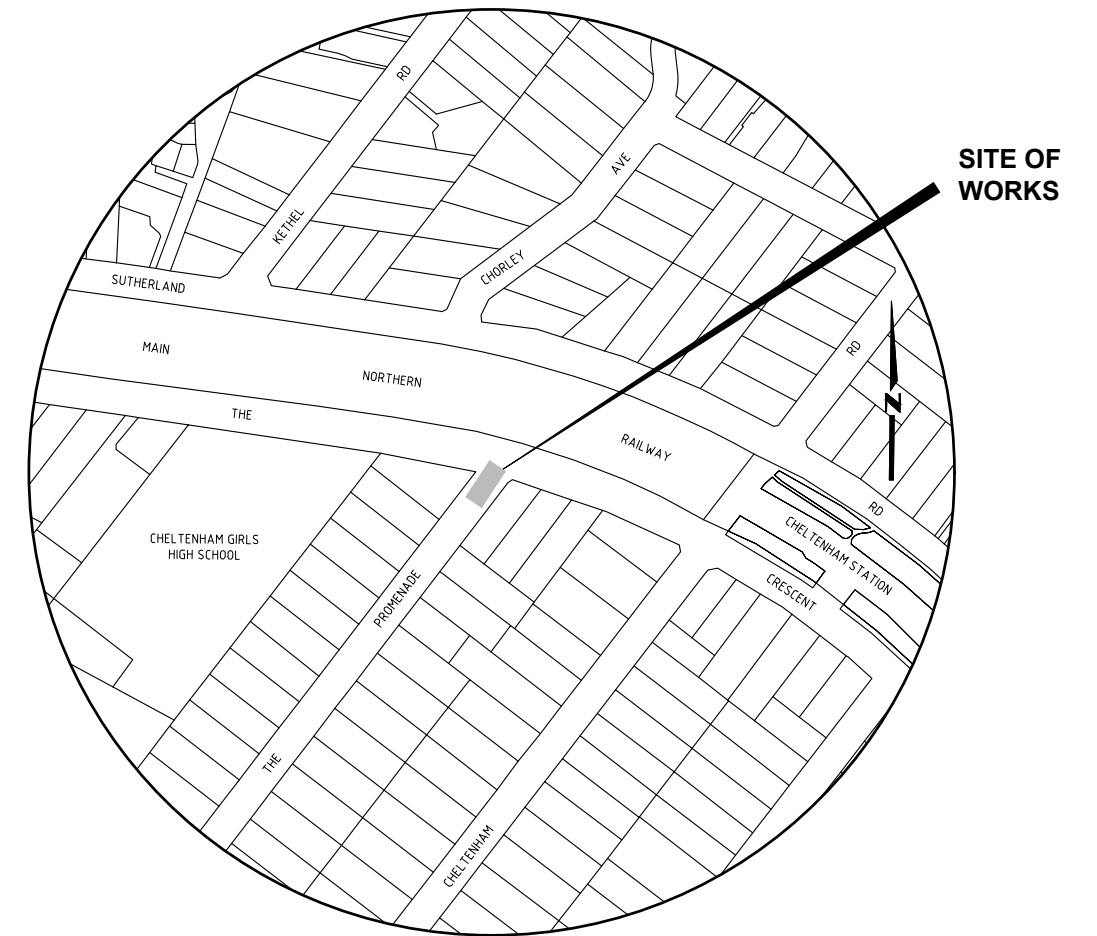

LOCALITY PLAN  
NOT TO SCALE

### LEGEND

	EXISTING KERB & GUTTER.
	EXISTING CONCRETE PATH EDGE.
	EXISTING FENCE.
	EXISTING POWER POLE.
	EXISTING HYDRANT.
	EXISTING WATER STOP VALVE.
	SURVEY TRAVERSE STATION.
	SURVEY REFERENCE MARKS - DRILL HOLE & WING.
	EXISTING WATER MAIN.
	EXISTING OVERHEAD ELECTRICAL CABLES.
	PROPOSED KERB & GUTTER
	EXTENT OF PROPOSED WOMBAT CROSSING. (COLOUR: BLACK).
	EXTENT OF PROPOSED FOOTPATH, PLATFORM RAMPS & KERB RAMPS (COLOUR: PLAIN CONCRETE).
	EXTENT OF PAVEMENT PROFILING TO SUIT FINISHED DESIGN LEVELS.
	EXISTING TREE.

**Hornsby Shire Council  
Design & Construction  
Branch**

TELEPHONE: (02) 9847 6666  
EMAIL: hsc@hornsby.nsw.gov.au  
Authorised for release - Manager Design & Construction  
Name: R. RAJCA Signed: Date:

Designer X. ZHENG	Design Checked-Design Team Leader		
Drawn X. ZHENG	Signed:		
Surveyor J. HART	NA Field Book	NA Level Book	AHD Datum
Project Identifier\ACAD File Name H:\The Promenade_TR_100858\Design\ACAD\The Promenade			
TRM Document Number D08295968	Issue		

Issue	Description	Name	Initial	Date
1	ISSUED FOR CONSTRUCTION	M. DRAKE		

Design not to be amended without authorisation by Manager Design & Construction

Bar Scales  
NOT TO SCALE  
DO NOT SCALE, USE FIGURED DIMENSIONS ONLY

**DRAFT**  
not for construction  
**HORNSBY SHIRE COUNCIL**  
PO BOX 37, HORNSBY NSW 1630

**THE PROMENADE, CHELTENHAM  
PROPOSED WOMBAT CROSSING**

DRAWING SCHEDULE, LOCALITY PLAN, GENERAL NOTES & LEGEND

TRAFFIC & ROAD SAFETY BRANCH		
Senior Traffic Engineer Name: R. ZARZYCKI Telephone: 9847 6684 Accepted as complying with the general intent of the design brief		
Signed: Date:		
Project Number <b>100858</b>		
Sheet <b>1</b>	of <b>6</b>	Issue <b>1</b>
HSC Drawing Number <b>1154.2</b>		

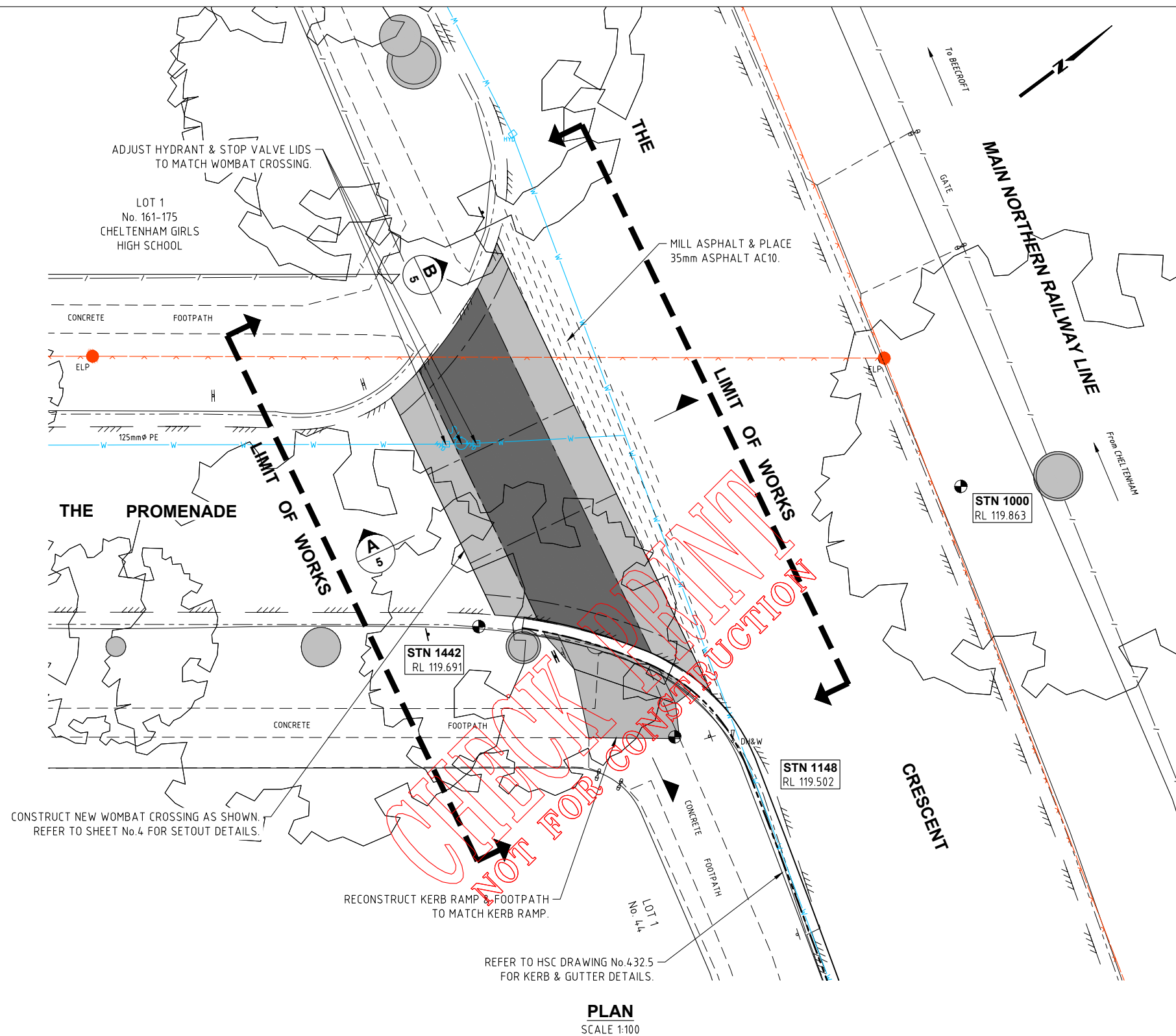

**PLAN**  
SCALE 1:100

**WARNING**

**BEWARE OF UNDERGROUND SERVICES**

THE LOCATIONS OF UNDERGROUND SERVICES HAVE BEEN INTERPOLATED FROM KNOWN POSITIONS OF VALVES, MANHOLES ETC. AND/OR INFORMATION SUPPLIED BY SERVICE AUTHORITIES. NO RESPONSIBILITY IS TAKEN FOR THE ACCURACY OF THE INTERPOLATED INFORMATION SUPPLIED. ENSURE ALL SERVICES ARE ACCURATELY LOCATED PRIOR TO COMMENCEMENT OF WORK.

REFER TO SHEET No.3 FOR CONCRETE JOINT DETAILS.

REFER TO SHEET No.4 FOR CONCRETE SETOUT DETAILS.

REFER TO SHEET No.6 FOR SIGNS AND LINE MARKING DETAILS.

**Hornsby Shire Council**  
**Design & Construction**  
**Branch**

Designer X. ZHENG	Design Checked-Design Team Leader		
Drawn X. ZHENG	Signed:		
Surveyor J. HART	NA Field Book	NA Level Book	AHD Datum
Project Identifier\ACAD File Name H:\The Promenade_TR_100858\Design\ACAD\The Promenade			
TRIM Document Number D08295968			

Issue	Description	Name	Initial	Date
1	ISSUED FOR CONSTRUCTION	M. DRAKE		

Design not to be amended without authorisation by Manager Design & Construction

Bar Scales
0 1 2 3 4 5m
SCALE 1:100 @ A1



**THE PROMENADE, CHELTENHAM**  
**PROPOSED WOMBAT CROSSING**

GENERAL WORKS & SERVICES PLAN

Project Number	100858	
Sheet of	2 6	Issue 1
HSC Drawing Number	1154.2	

Authorised for release - Manager Design & Construction  
Name: R. RAJCA Signed: Date:

DO NOT SCALE, USE FIGURED DIMENSIONS ONLY

PO BOX 37, HORNSBY NSW 1630

**CONCRETE NOTES:**

(USING STEEL REINFORCED CONCRETE U.N.O.)

- MATERIALS & CONSTRUCTION: TO AS 3600, AS 3610.  
STEEL REINFORCEMENT MATERIALS: TO AS 4671.
- CONCRETE QUALITY: TO AS 1379  
READY MIX CONCRETE: TO AS 1379  
a) DO NOT USE ADMIXTURES WITHOUT WRITTEN APPROVAL FROM CONSTRUCTION ENGINEER.  
b) CEMENT: TYPE 'GP' OR 'GB' TO AS 3972.  
c) MAXIMUM SIZE OF COARSE AGGREGATE: 20mm.  
d) CONCRETE SLUMP: 80mm U.N.O.
- VERIFY STRENGTH BY PRODUCTION CONTROL TESTING TO AS 1379.
- NO UNSPECIFIED HOLES, PIPES, CONDUITS OR CHASES ARE PERMITTED WITHOUT WRITTEN APPROVAL FROM CONSTRUCTION ENGINEER.
- STRUCTURAL DIMENSIONS DO NOT INCLUDE TOPPING OR FINISHES.
- FORM CONSTRUCTION JOINTS ONLY AT LOCATIONS SHOWN ON DRAWINGS. DO NOT VARY WITHOUT WRITTEN APPROVAL FROM SUPERVISING ENGINEER.
- PREPARE COLD JOINTS BY LIGHT SCABBLING, REMOVAL OF DEBRIS & WASHING WITH CLEAN WATER.
- FOUNDATION MATERIALS MUST BE CAPABLE OF WITHSTANDING A SAFE BEARING PRESSURE OF 100kPa. VERIFY & RECORD THE BEARING CAPACITY BEFORE ANY CONCRETE IS PLACED.
- FOR RAISED PEDESTRIAN CROSSING FOUNDATION, REMOVE ASPHALT, TRIM AND COMPACT.
- BLISTER ISLANDS TO BE CONSTRUCTED ON TOP OF RAISED PEDESTRIAN CROSSING RAMP AND ASPHALT PAVEMENT AND ATTACHED WITH MEGAPOXY H.
- DO NOT PLACE CONCRETE UNTIL REINFORCEMENT (IF USED) & FORMWORK ARE INSPECTED BY SUPERVISING ENGINEER.
- THOROUGHLY CLEAN OUT ALL FORMWORK PRIOR TO POURING.
- DO NOT PLACE CONCRETE UNDER THE FOLLOWING CONDITIONS:  
a) WHEN THE SURROUNDING OUTDOOR TEMPERATURE EXCEEDS 30°C.  
b) WHEN THE SURROUNDING WIND SPEED EXCEEDS 22km/h.
- DO NOT PLACE CONCRETE WHEN THE CONCRETE TEMPERATURE AT THE TIME OF DELIVERY EXCEEDS 35°C.
- IMPLEMENT THE FOLLOWING PROCEDURES TO MITIGATE PREMATURE DRYING & CRACKING OF THE CONCRETE:  
a) IN HOT CONDITIONS, PROGRAM CONCRETE PLACEMENT FOR THE COOLER PART OF THE DAY (ie. EARLY MORNING).  
b) SPRAY EVAPORATIVE RETARDERS WITH FUGATIVE DYES (eg. ALIPHATIC ALCOHOL) OVER THE SURFACE IMMEDIATELY AFTER SCREEDING & WHILST BLEED WATER IS STILL PRESENT. REAPPLY IF THE SURFACE IS DISTURBED.  
c) COMMENCE CURING IMMEDIATELY AFTER FINISHING. CURE FOR 7 DAYS.
- VIBRATE CONCRETE DURING PLACEMENT TO GIVE MAXIMUM COMPACTION WITHOUT SEGREGATION.
- SURFACE FINISH - REFER TO NOTE 2 ABOVE & DRAWINGS FOR DETAILS.
- EXPANSION JOINTS & ISOLATION JOINTS ARE TO BE SEALED TO MANUFACTURER'S SPECIFICATIONS WITH A GUN GRADE POLYURETHANE LOW MODULUS SELF PRIMING SEALANT EQUAL TO 'TREMCO DYMONIC NT' (+100%, -50% MOVEMENT CAPACITY). SEALANT COLOUR AS SPECIFIED IN SHEET 3.

ELEMENT	CHARACTERISTIC CONCRETE STRENGTH(f'c) AT 28 DAYS	COVER	SPECIAL REQUIREMENTS
PLATFORM AND RAMPS	S 32 (U.N.O.)	AS DETAILED	COLOUR AS DETAILED BROOM FINISH
FOOTPATH & KERB RAMPS	S 25 (U.N.O.)	AS DETAILED	BROOM FINISH

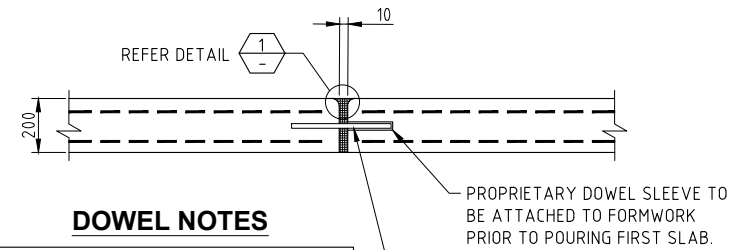

**DOWEL NOTES**

- GREASE DOWEL IN SECOND POUR.
- ENSURE DOWELS ARE STRAIGHT PERPENDICULAR TO JOINT AND CAPPED.
- DO NOT DISPLACE DURING POUR.

PROPRIETARY DOWEL SLEEVE TO BE ATTACHED TO FORMWORK PRIOR TO POURING FIRST SLAB.

INSTALL R12 S/S DOWELS, 400mm LONG AT 400mm CENTRES PLACED MID-DEPTH.

**DOWELLED EXPANSION JOINT (DEJ)**

NOT TO SCALE

**\*TOOLED FINISH**

THE SAME TOOL EDGE FINISHING PROFILE TO BE APPLIED AT ALL JOINTS AND ALONG SIDES OF PATH.

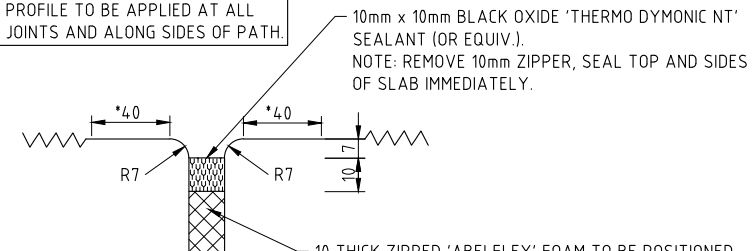

**DETAIL 1**

NOT TO SCALE

10 THICK ZIPPED 'ABELFLEX' FOAM TO BE POSITIONED 7mm BELOW TOP OF SLAB AND TO EXTEND TO BASE OF SLAB TO ALLOW FOR 7mm RADIUS CREATED BY EDGE TOOL. CUT BACK 10mm FROM SLAB EDGE TO ALLOW FOR SEALANT.

'LOCK JOINT' CONTRACTION JOINT - SIZED TO SUIT WITH (BLACK) RUBBER CAP. MANUFACTURER: 'LOCK JOINT AUSTRALIA' PH. 1800 022 250. NOTE: LOCK JOINT HOLDING BARS AND CLAMPS TO BE USED TO SUPPORT CONTRACTION JOINT DURING CONSTRUCTION.

TWO (2) LAYERS OF SL82 MESH. 50mm COVER.

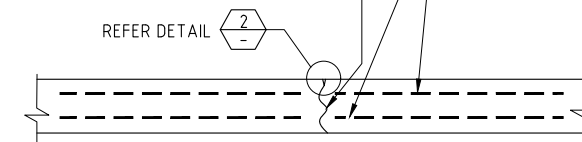

**CONTRACTION JOINT (CJ)**

NOT TO SCALE

KERB/ PAVEMENT/ INVERT CROSSING/ BUILDING/ RETAINING WALLS, ETC. AS APPLICABLE.

10mm x 10mm BLACK OXIDE SEALANT  
NOTE: REMOVE 10mm ZIPPER, SEAL TOP AND SIDES OF SLAB IMMEDIATELY.

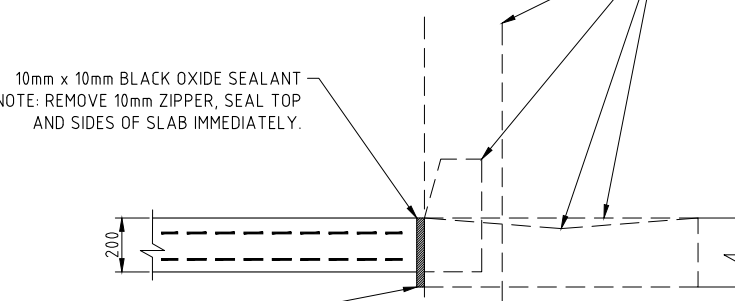

10mm ZIPPED ABELFLEX FOR FULL DEPTH OF CONCRETE WITH SEALANT OVER.

**ISOLATION JOINT (IJ)**

NOT TO SCALE

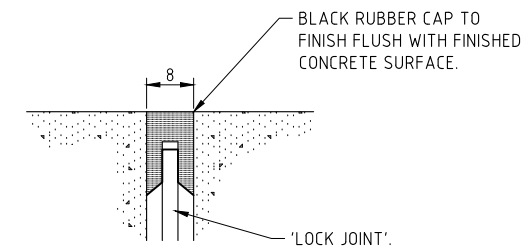

**DETAIL 2**

NOT TO SCALE

**Hornsby Shire Council  
Design & Construction  
Branch**

TELEPHONE: (02) 9847 6666  
EMAIL: hsc@hornsby.nsw.gov.au  
Authorised for release - Manager Design & Construction  
Name: R. RAJCA Signed: Date:

Designer X. ZHENG	Design Checked-Design Team Leader		
Drawn X. ZHENG	Signed:		
Surveyor J. HART	NA Field Book	NA Level Book	AHD Datum
Project Identifier\ACAD File Name H:\The Promenade_TR_100858\Design\ACAD\The Promenade			
1	ISSUED FOR CONSTRUCTION	M. DRAKE	
Issue	Description	Name	Initial Date
Design not to be amended without authorisation by Manager Design & Construction			

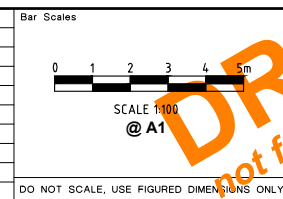

**DRAFT**  
not for construction  
**HORNSBY  
SHIRE COUNCIL**  
PO BOX 37, HORNSBY NSW 1630

**THE PROMENADE, CHELTENHAM  
PROPOSED WOMBAT CROSSING**

CONCRETE NOTES & JOINT DETAILS

Project Number <b>100858</b>	Sheet of <b>3 6</b>	Issue <b>1</b>
HSC Drawing Number <b>1154.2</b>		

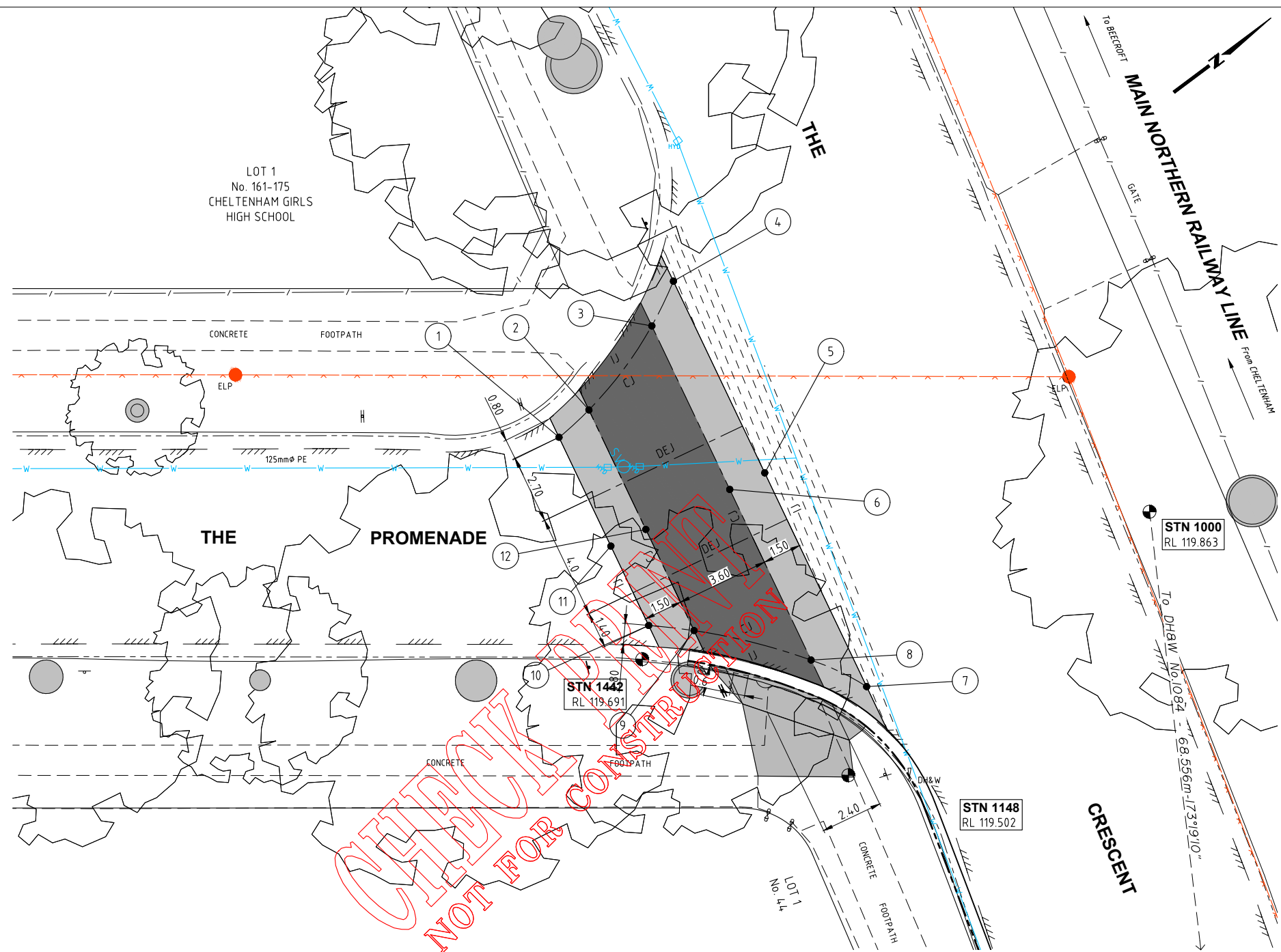

**SETOUT PLAN**  
SCALE 1:100

WOMBAT CROSSING SETOUT DETAILS				
POINT No.	EASTING	NORTHING	LEVEL	REMARKS
1	321833.798	6263316.759	EXISTING	BOTTOM OF PLATFORM
2	321833.664	6263318.321	119.657	TOP OF PLATFORM
3	321832.563	6263322.235	119.681	TOP OF PLATFORM
4	321831.696	6263323.953	119.613	BOTTOM OF PLATFORM
5	321839.736	6263322.245	119.701	BOTTOM OF PLATFORM
6	321839.425	6263320.778	119.769	TOP OF PLATFORM
7	321848.712	6263320.339	119.624	BOTTOM OF PLATFORM
8	321846.586	6263319.257	119.728	TOP OF PLATFORM
9	321842.708	6263316.400	119.686	TOP OF PLATFORM
10	321841.697	6263315.081	EXISTING	BOTTOM OF PLATFORM
11	321838.365	6263315.789	EXISTING	BOTTOM OF PLATFORM
12	321838.677	6263317.256	199.755	TOP OF PLATFORM

SURVEY STATIONS & REFERENCE MARKS TABLE				
POINT #	EASTING	NORTHING	LEVEL	DESCRIPTION
1000	321850.004	6263333.156	119.863	NAIL IN PATH
1084	321852.588	6263319.454	119.548	DHW
1148	321851.007	6263317.691	119.502	NAIL
2000	321908.840	6263298.094	116.856	NAIL IN PATH

SURVEY CONTROL		
SURVEY STATION AND/OR CONTROL LINE DETAILS CHECKED AND VERIFIED		
Signed:	Date:	
Project Number	100858	
Sheet of	4 6	Issue 1
HSC Drawing Number	1154.2	

**Hornsby Shire Council**  
Design & Construction  
Branch  
TELEPHONE: (02) 9847 6666  
EMAIL: hsc@hornsby.nsw.gov.au

Designer X. ZHENG	Design Checked-Design Team Leader Signed:				
Drawn X. ZHENG	Drawing Checked Signed:				
Surveyor J. HART	NA Field Book	NA Level Book	AHD Datum		
Project Identifier\ACAD File Name H:\The Promenade_TR_100858\Design\ACAD\The Promenade	1	ISSUED FOR CONSTRUCTION	M. DRAKE		
TRIM Document Number D08295968	Issue	Description	Name	Initial	Date
Design not to be amended without authorisation by Manager Design & Construction					

Bar Scales  
0 1 2 3 4 5m  
SCALE 1:100  
@ A1

**DRAFT**  
not for construction

**HORNSBY SHIRE COUNCIL**  
PO BOX 37, HORNSBY NSW 1630

**THE PROMENADE, CHELTENHAM**  
**PROPOSED WOMBAT CROSSING**

SETOUT PLAN & STATION DETAILS

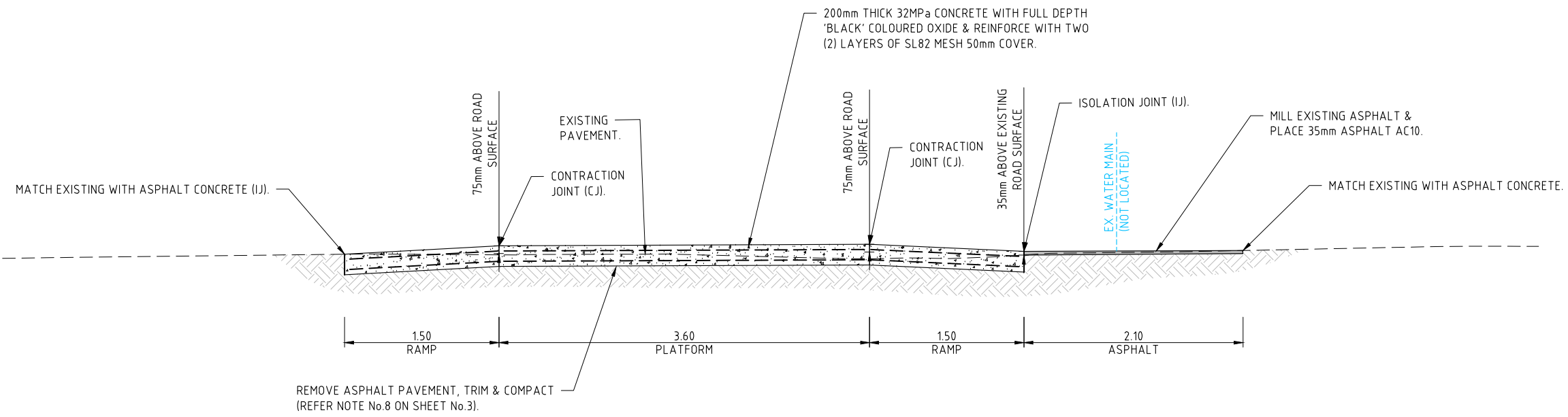

**SECTION A**  
SCALE N.T.S.

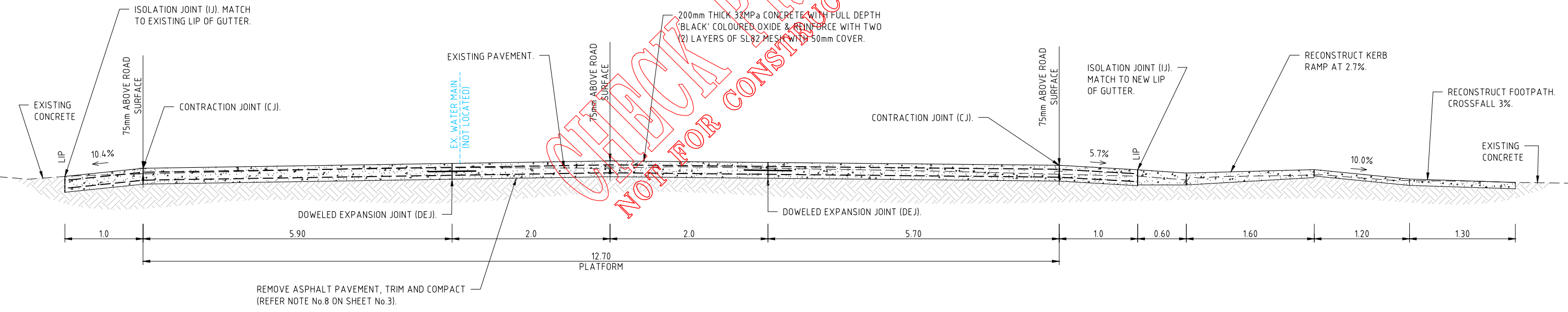

**SECTION B**  
SCALE N.T.S.

**Hornsby Shire Council  
Design & Construction  
Branch**  
TELEPHONE: (02) 9847 6666  
EMAIL: hsc@hornsby.nsw.gov.au

Designer <b>X. ZHENG</b>	Design Checked-Design Team Leader		
Drawn <b>X. ZHENG</b>	Signed:		
Surveyor <b>J. HART</b>	NA Field Book	NA Level Book	AHD Datum
Project Identifier\ACAD File Name H:\The Promenade_TR_100858\Design\ACAD\The Promenade			
TRIM Document Number <b>D08295968</b>	1	ISSUED FOR CONSTRUCTION	M. DRAKE
Name	Initial	Date	
Design not to be amended without authorisation by Manager Design & Construction			

Bar Scales  
0 1 2 3 4 5m  
SCALE 1:100 @ A1

**DRAFT**  
not for construction

**HORNSBY SHIRE COUNCIL**  
PO BOX 37, HORNSBY NSW 1630

**THE PROMENADE, CHELTENHAM  
PROPOSED WOMBAT CROSSING**

Project Number  
**100858**

Sheet of Issue  
**5 6 1**

HSC Drawing Number  
**1154.2**

SECTIONS A & B

Authorised for release - Manager Design & Construction  
Name: R. RAJCA Signed: Date:

DO NOT SCALE, USE FIGURED DIMENSIONS ONLY

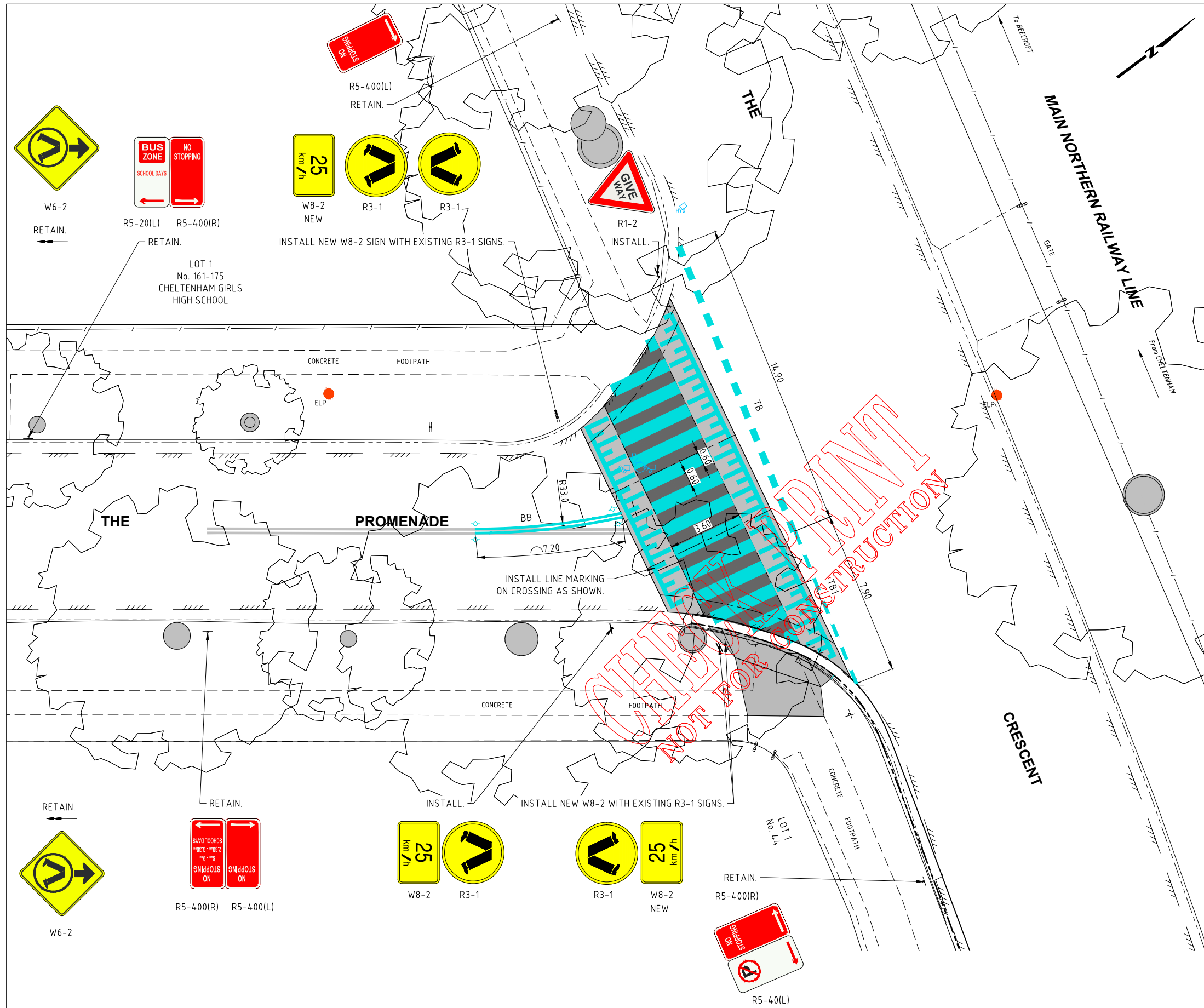

**LINE MARKING NOTES**

1. SIGNS & LINE MARKING TO BE INSTALLED IN ACCORDANCE WITH MANUAL OF UNIFORM TRAFFIC CONTROL DEVICES/ AS1742 REQUIREMENTS.
2. WHERE POSSIBLE EXISTING SIGNAGE IS TO BE CLEANED & REUSED TO SUIT NEW WORK.
3. ALL NEW LINE MARKING TO BE THERMOPLASTIC & WHITE UNLESS NOTED OTHERWISE
4. GRIND OFF REDUNDANT LINE MARKING & REMOVE REDUNDANT RRPMS.
5. ALL NEW SIGNS TO BE SIZE A.
6. TEMPORARY 'CHANGED TRAFFIC CONDITIONS AHEAD' (T1-23) SIGNS TO BE INSTALLED ON ALL APPROACHES APPROXIMATELY 100m FROM LIMIT OF WORKS (TYPICAL) AT THE COMMENCEMENT OF WORKS & UNTIL 6 MONTHS AFTER COMPLETION.
7. THIS PLAN WAS APPROVED BY THE LOCAL TRAFFIC COMMITTEE ON.

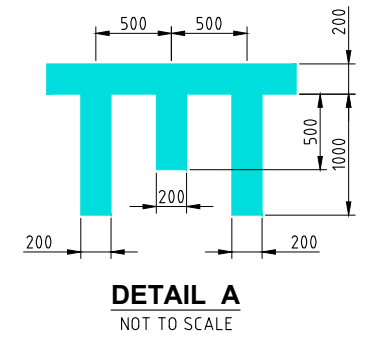
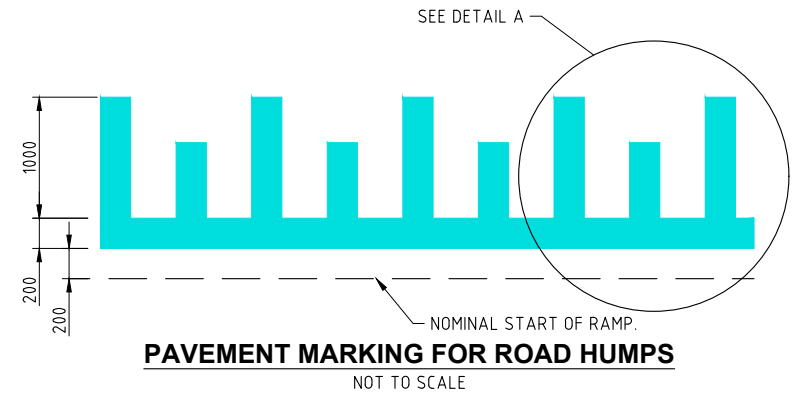

**LEGEND**

- PROPOSED LINE MARKING.
- EXISTING LINE MARKING.
- ⬇ EXISTING SIGN.
- ⬆ NEW SIGN.

**THIS DRAWING SHALL ONLY BE REPRODUCED AND READ IN COLOUR**

**RRPM LEGEND**

- ◊ BIDIRECTIONAL YELLOW

**SIGNS & LINE MARKING PLAN**  
SCALE 1:100

<b>Hornsby Shire Council</b> Design & Construction Branch TELEPHONE: (02) 9847 6666 EMAIL: hsc@hornsby.nsw.gov.au	Designer X. ZHENG Signed:	Design Checked-Design Team Leader Signed:			Bar Scales  SCALE 1:100 @ A1 DO NOT SCALE, USE FIGURED DIMENSIONS ONLY	<b>DRAFT</b> not for construction <b>HORNSBY SHIRE COUNCIL</b> PO BOX 37, HORNSBY NSW 1630	<b>THE PROMENADE, CHELTENHAM PROPOSED WOMBAT CROSSING</b>  <b>SIGNS &amp; LINE MARKING PLAN</b>	Project Number <b>100858</b>	
	Drawn X. ZHENG Signed:	NA Field Book	NA Level Book	AHD Datum				Sheet of <b>6 6</b>	Issue <b>1</b>
	Surveyor J. HART	Project Identifier\ACAD File Name H:\The Promenade_TR_100858\Design\ACAD\The Promenade		HSC Drawing Number <b>1154.2</b>					
Authorised for release - Manager Design & Construction Name: R. RAJCA Signed: Date:	TRIM Document Number D08295968	1 Issue	ISSUED FOR CONSTRUCTION Description	M. DRAKE Name Initial Date	Design not to be amended without authorisation by Manager Design & Construction				