

WHERE ASBESTOS MAY BE FOUND IN A TYPICAL HOME

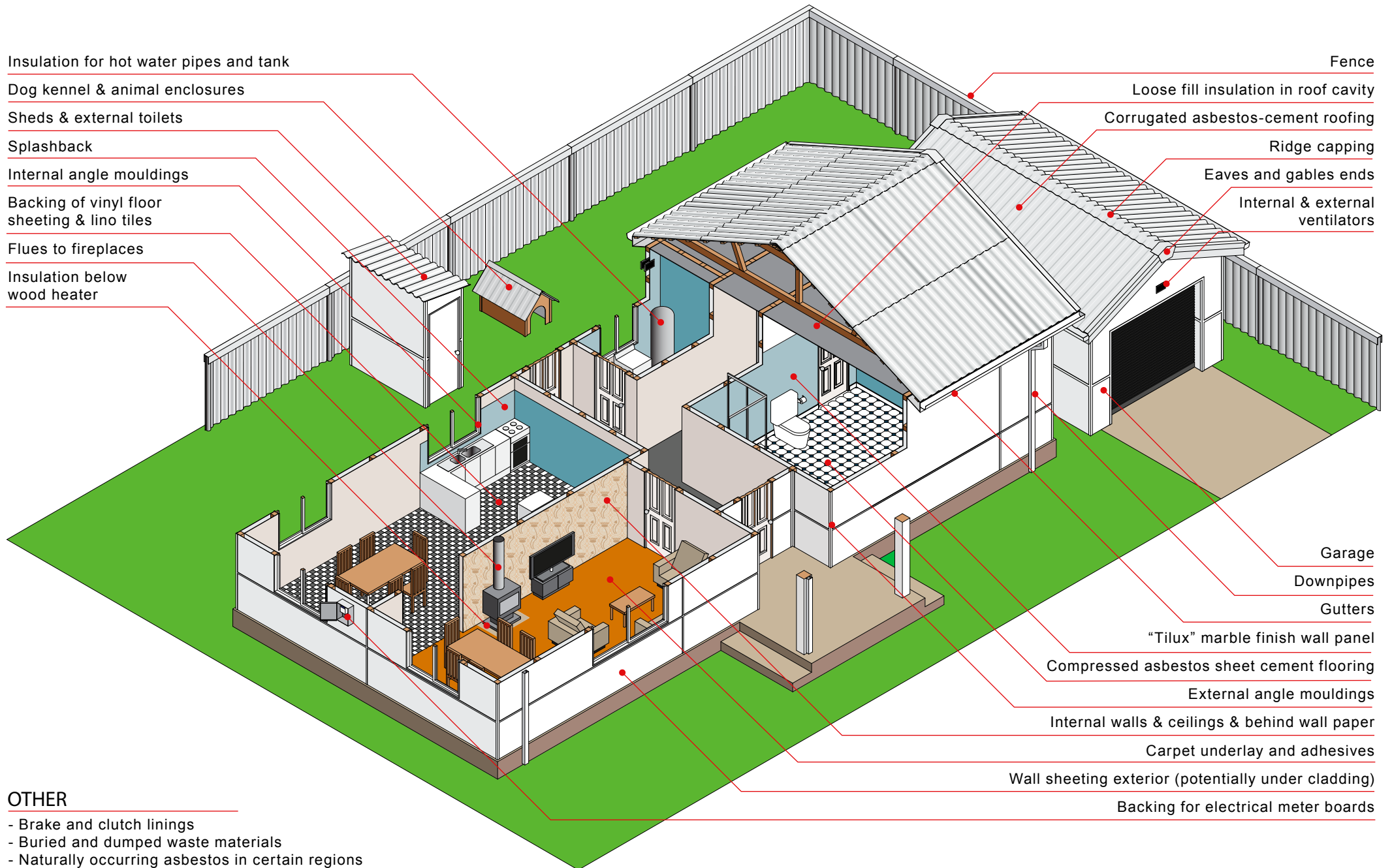

- Insulation for hot water pipes and tank
- Dog kennel & animal enclosures
- Sheds & external toilets
- Splashback
- Internal angle mouldings
- Backing of vinyl floor sheeting & lino tiles
- Flues to fireplaces
- Insulation below wood heater

- Fence
- Loose fill insulation in roof cavity
- Corrugated asbestos-cement roofing
- Ridge capping
- Eaves and gables ends
- Internal & external ventilators

- Garage
- Downpipes
- Gutters
- "Tilux" marble finish wall panel
- Compressed asbestos sheet cement flooring
- External angle mouldings
- Internal walls & ceilings & behind wall paper
- Carpet underlay and adhesives
- Wall sheeting exterior (potentially under cladding)
- Backing for electrical meter boards

OTHER

- Brake and clutch linings
- Buried and dumped waste materials
- Naturally occurring asbestos in certain regions