

HORNSBY AQUATIC CENTRE

DELIBERATIVE FORUM

DAY TWO

Decision Statement

The design for a new Hornsby Aquatic Centre to be built on the existing site, that meets community needs and is within a budget Hornsby Council can afford.



Deliberative Process

Day 2

- explore options and rank them against criteria
- review recommended option for improvements

Agenda Day 2

- Reflection on last week
- Review and prioritisation of criteria
- Explore design options
- Evaluation
- Lunch
- Improvements
- Recommendation to Councillors

Reflection

At your tables,

- What was a key thing you learned last week?
- What implication might it have for meeting community needs in a new aquatic centre?
- What questions do you still have?

Share a key insight from the group

Post questions to sticky wall

Selection Criteria

- Design Principles (would generically apply to any option)
- Musts (any option must satisfy)
- Wants (these could have different priority)

Criteria

Musts

- Fits on the site
- Within budget of \$20M
- Break even on operating costs

Criteria Ranking

Individually, rank each criteria from 1 to 5 in order of importance to you

1- most important

5- least important

At your tables, add the scores from each for each criteria, and report

Total - lowest number indicates highest importance



Budget

\$20M

Sites Considered





Old Mans Valley

Hornsby Park

Hornsby RSL land

Hornsby Bowling Club

Brickpit Park

Old Mans Valley

Council Land
Too expensive to develop
Poor location

Hornsby Park

Crown Land
Under care and control of HSC

Council Land
Useable areas fully developed

Brickpit Park

Hornsby RSL land

Private Land
Too small

Hornsby Bowling Club

Crown Land
Not under care and control of HSC
Major trunk stormwater drainage and sewer lines across the site

For Council to buy land
Approx cost \$8M to \$10M



Brickpit Park

APPROX SIZE OF AQUATIC FACILITY

Fill Area

Up to 25m deep

Land is leased for golf driving range



Old Mans Valley

OMV Servicing Costs

Access Road	\$1.0M
Public Utilities	\$4.0M
Includes:	
• Water, Sewer, Electricity, Gas	
Lighting	\$0.5M

Hornsby Park Costs

Demolition & restoration	\$1.5M
--------------------------	--------

TOTAL \$7M

- LEGEND:**
1. LARGE PLAYING FIELD (165m x 135m)
 2. LAKE
 3. PARKLAND
 4. PLAYGROUND
 5. ENTRY BUILDING / CAFE
 6. AMENITIES BUILDING
 7. NATIVE PLANTING AND TRAIL
 8. CARPARKING

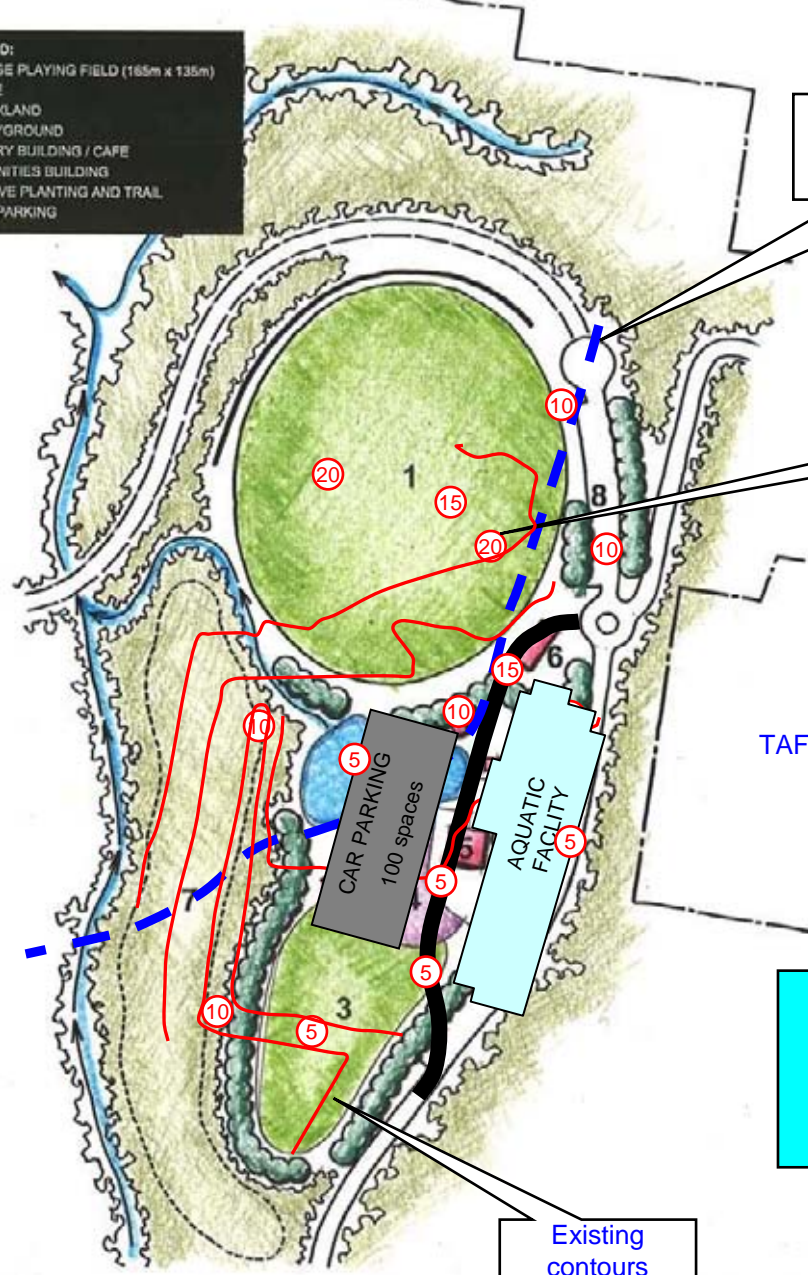

Fault Line –
Breccia / Sandstone
interface

Depth of fill

TAFE

CAR PARKING
100 spaces

AQUATIC FACILITY

Total Pool Cost in OMV
≈\$24M
Includes 100 Space Carpark

Existing
contours



2009/2010 Swimming Carnival Attendance Numbers

2009/2010 Swimming Carnival Attendance Numbers

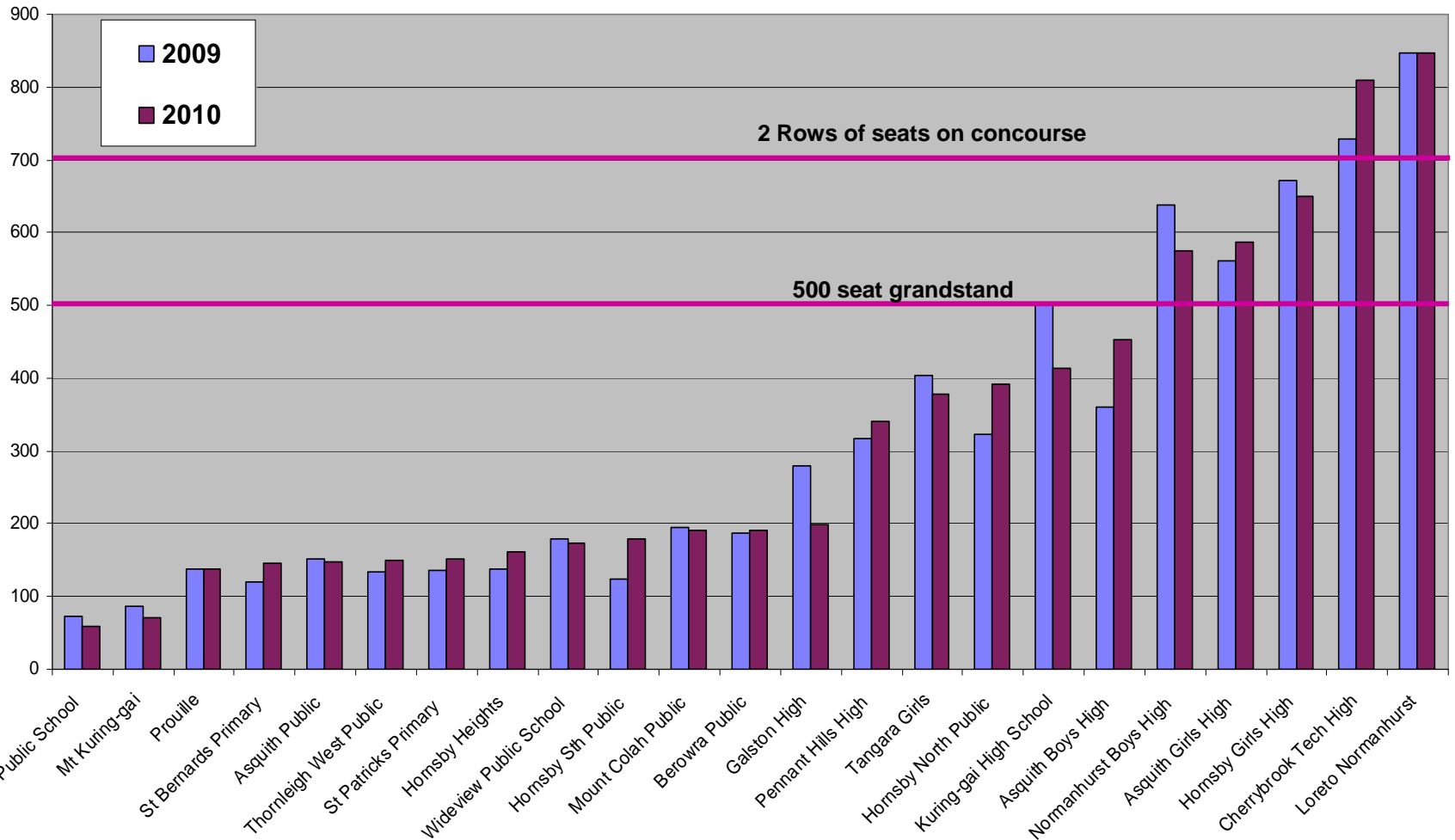

Spatial Footprint



DESIGN AND CONSTRUCTION MANAGEMENT OF HORNSBY AQUATIC CENTRE



peter hunt architect

Explore design options

- Process to develop options
- Staging Difficulties
- Options

OPTION 1 - Indoor 25m + Outdoor 50m

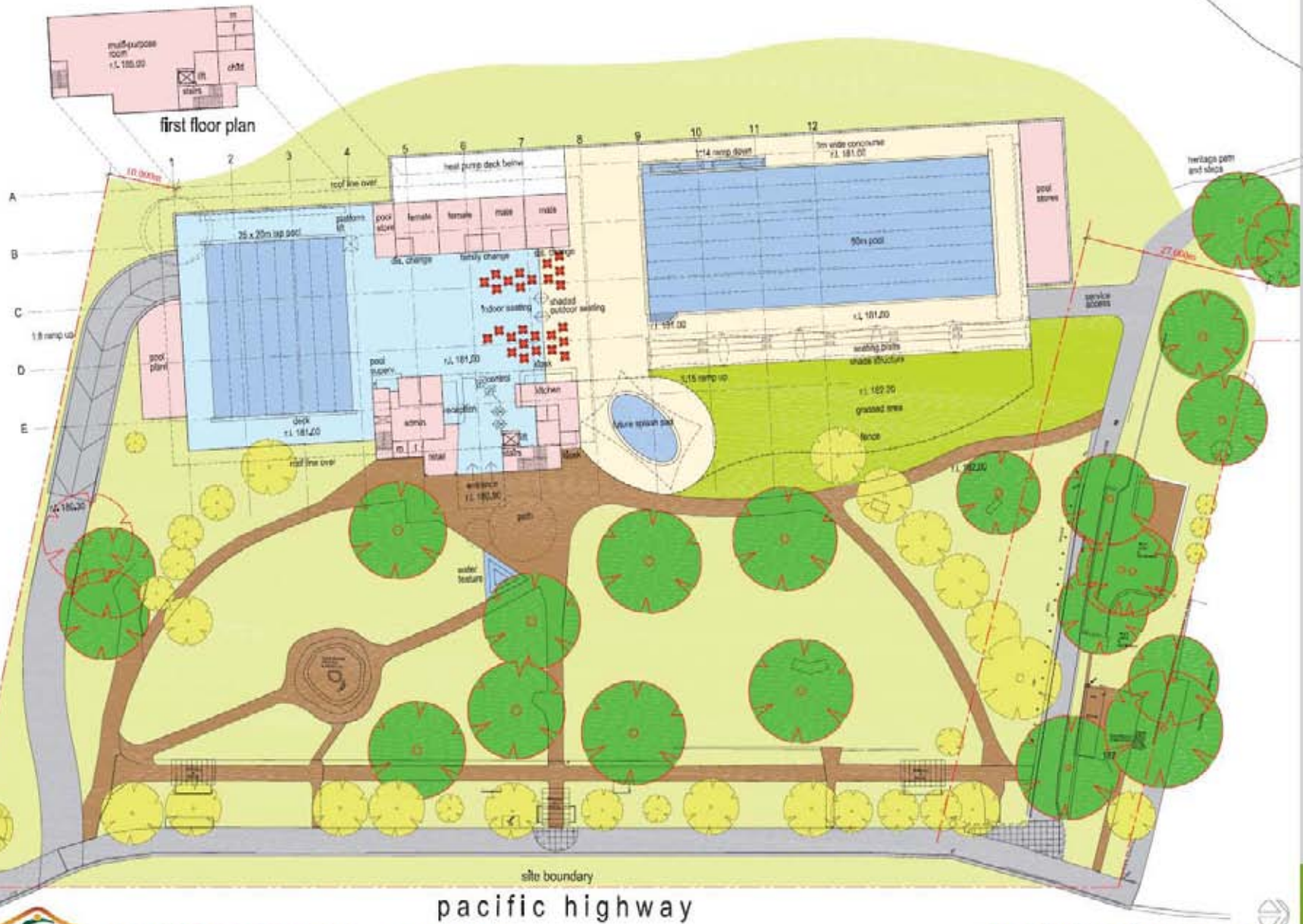

Hornsby aquatic centre redevelopment
peter hunt architect



GROUND FLOOR LEVEL SCALE 1:500 AT A3

ORIGINAL CONCEPT DESIGN

01 APRIL 2011

A 21

OPTION 2 - Indoor shaped pool + Outdoor 50m

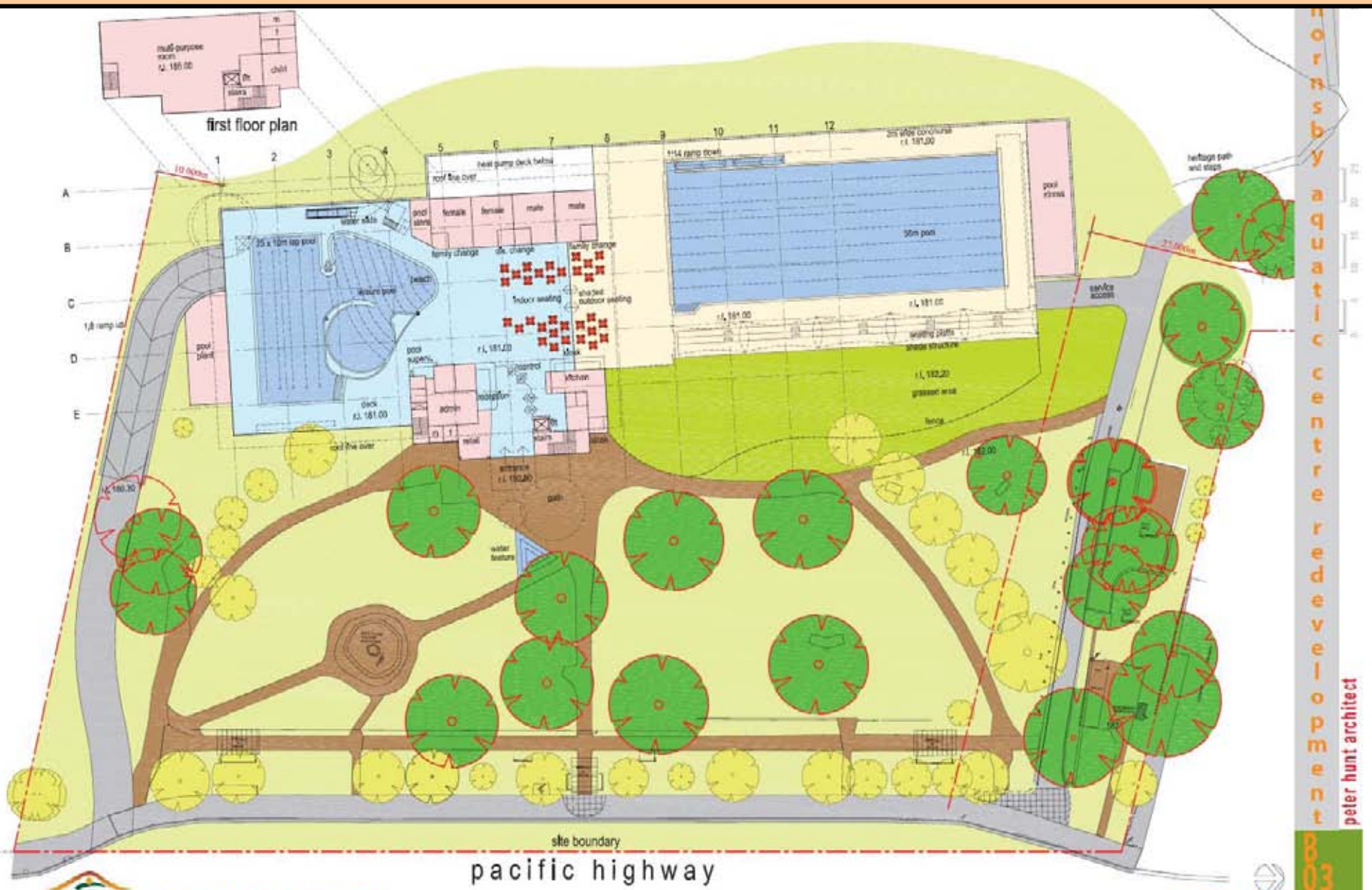

Hornsby aquatic centre redevelopment
peter hunt architect



GROUND FLOOR LEVEL SCALE 1:500 AT A3

OPTION 2A

00 APRIL 2011

B03

OPTION 3 - Indoor 25m + Outdoor 25m + WOW

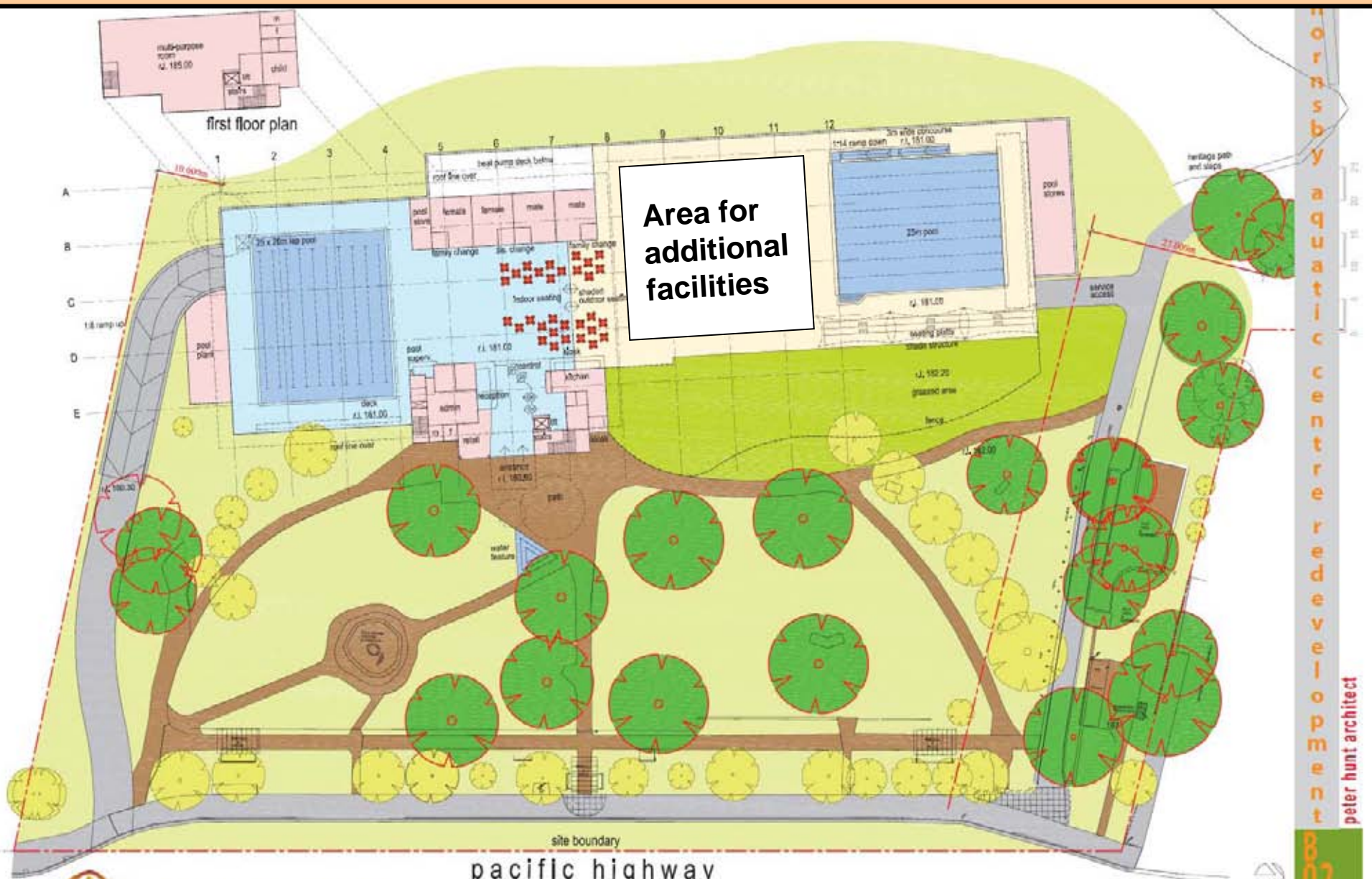

Area for additional facilities

hornsbys aquatic centre redevelopment
peter hunt architect



GROUND FLOOR LEVEL SCALE 1:500 AT A3

OPTION 1B

08 APRIL 2011

B02

OPTION 4 - Indoor shaped pool + Outdoor 25m + WOW

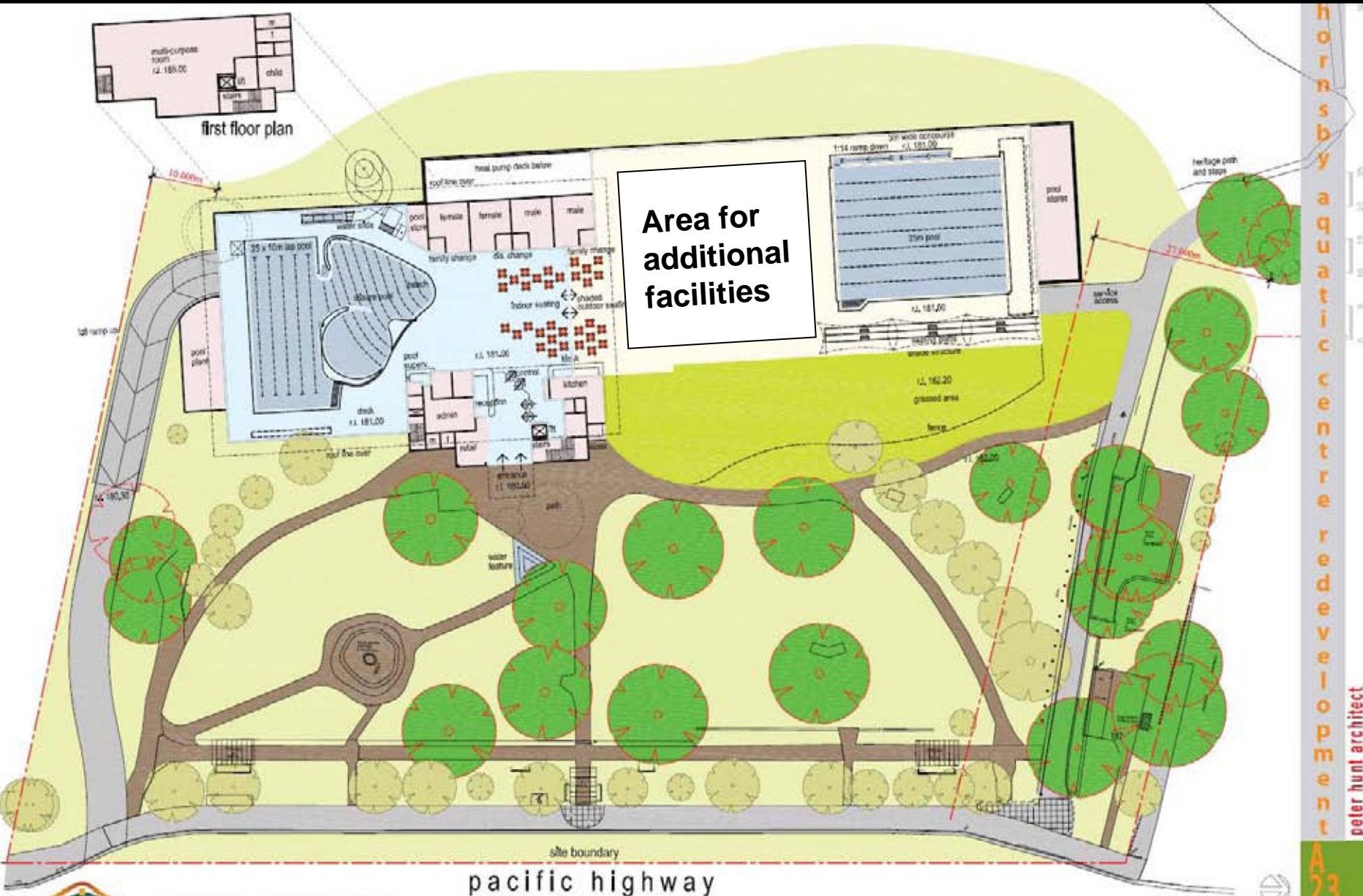

Area for additional facilities

hornsby aquatic centre redevelopment
peter hunt architect



GROUND FLOOR LEVEL SCALE 1:1500 AT A3

OPTION 2A

07 APRIL 2011

A 23

Carparking

- All options show 60 spaces (min)
- Recreational planner recommends >100 spaces

Sharing the space



Sharing the space

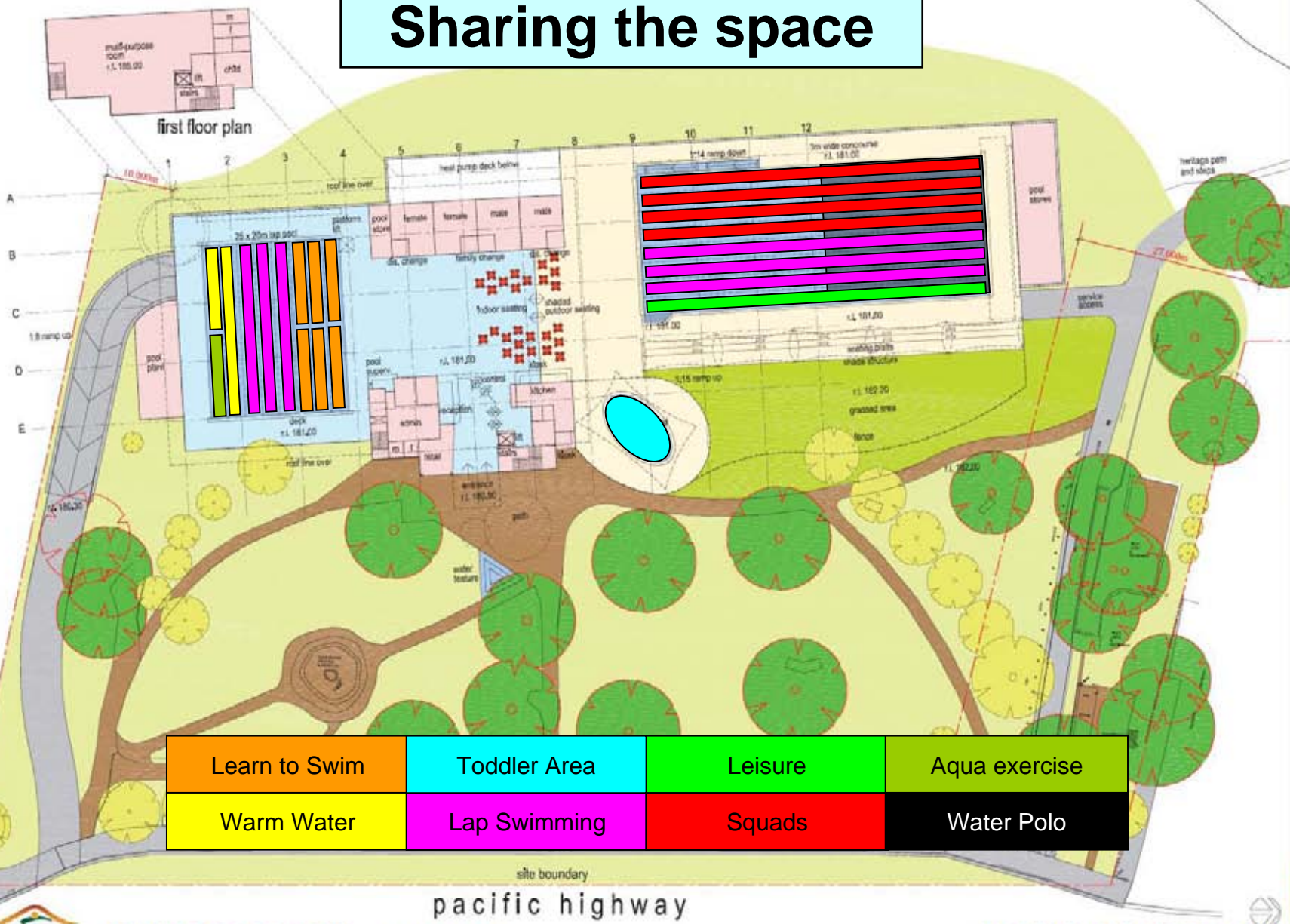

Learn to Swim	Toddler Area	Leisure	Aqua exercise
Warm Water	Lap Swimming	Squads	Water Polo

Hornsby aquatic centre redevelopment
peter hunt architect



Sharing the space



first floor plan

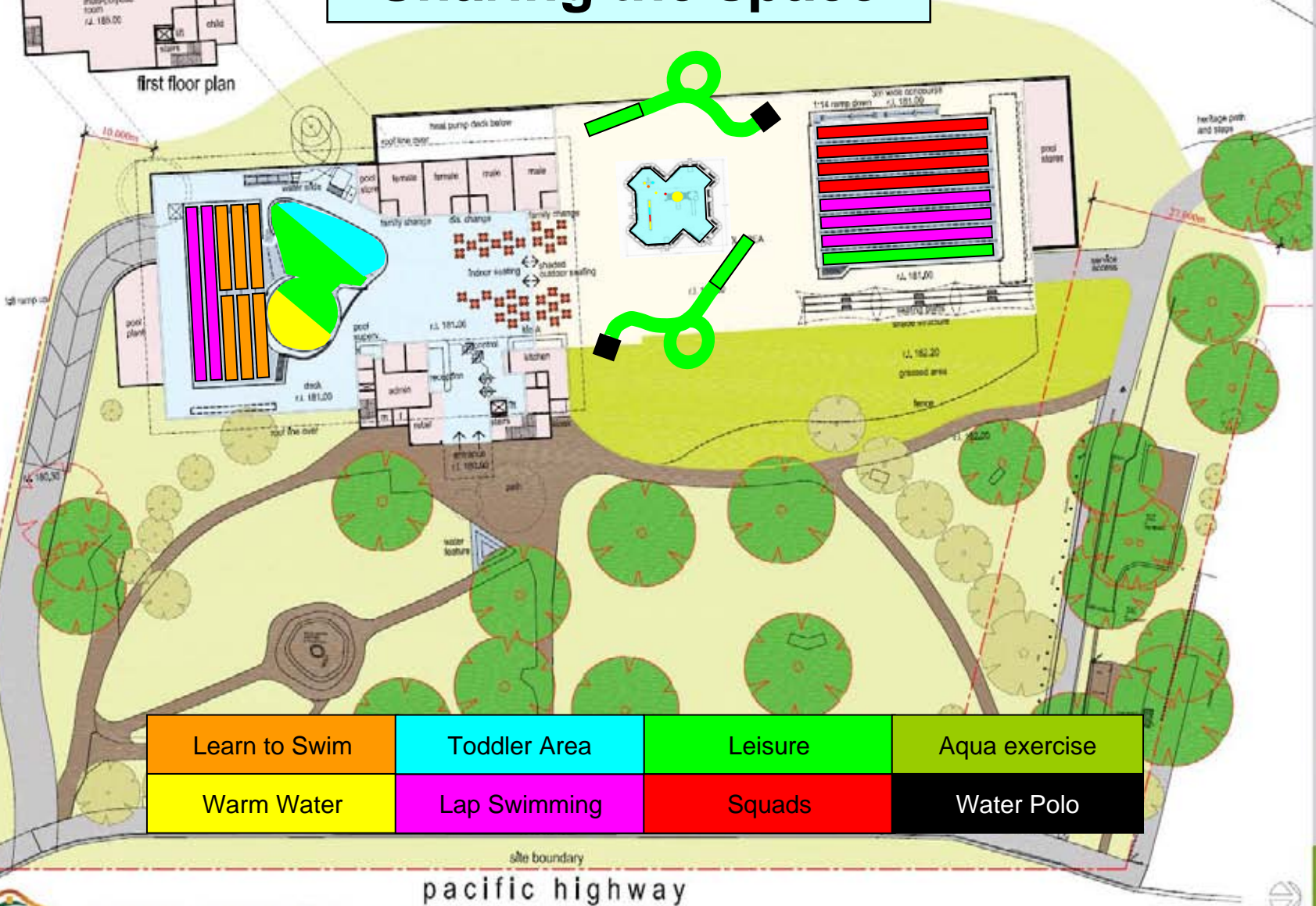

Learn to Swim	Toddler Area	Leisure	Aqua exercise
Warm Water	Lap Swimming	Squads	Water Polo

hornsby aquatic centre redevelopment peter hunt architect



LUNCH

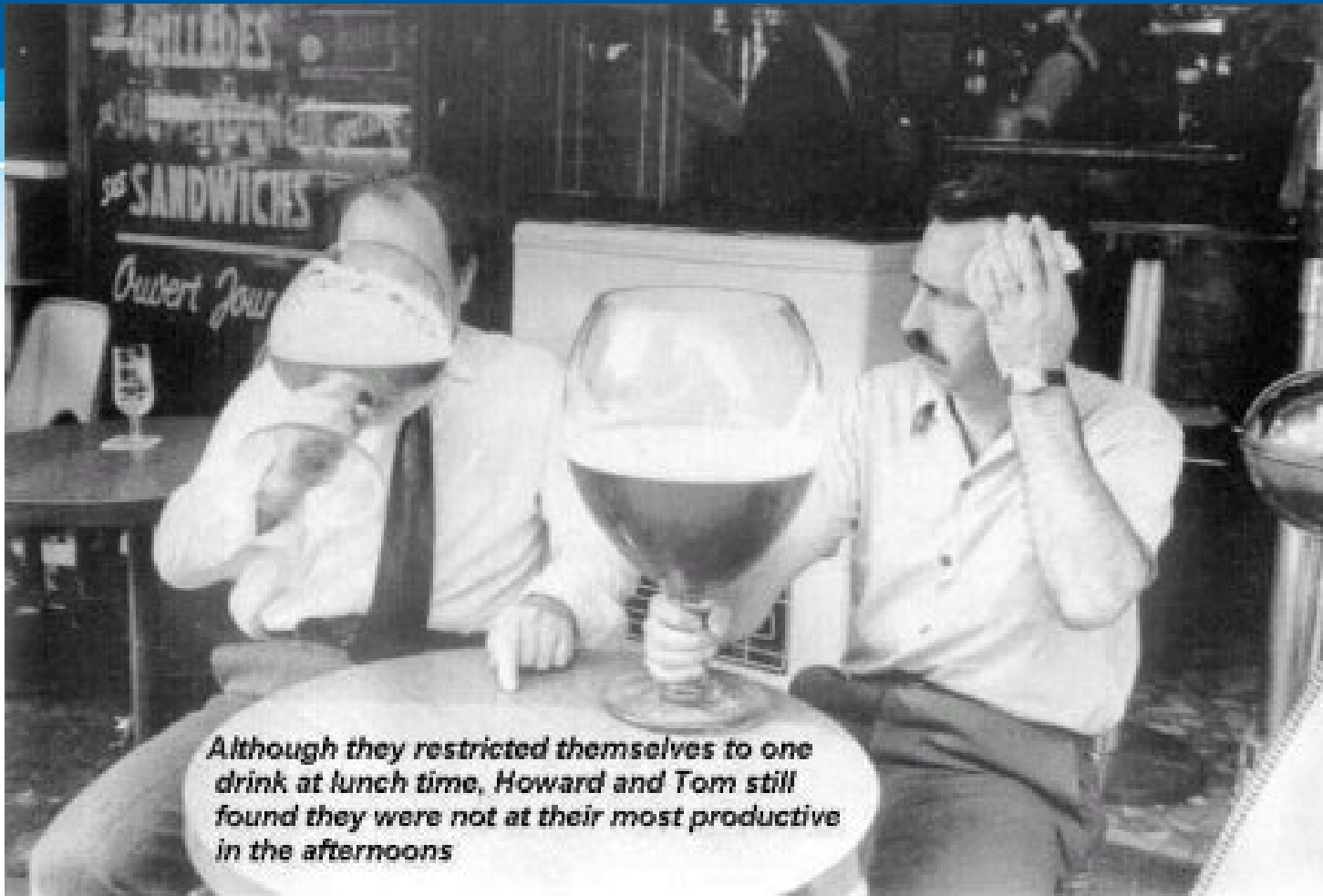

Evaluation

Test the four options against each criteria individually, and then together at your table

“Which option best meets the criteria and why?”

Each table to post one green card with the key reason(s) on the selected option for each criteria

“Best fit” Option

Look at the table created, and the rationale for the choices

Review the preferences against the ranking of the criteria

Which option is a “best fit” at this stage?



“Best fit” Option

Look at the table created, and the rationale for the choices

Review the preferences against the ranking of the criteria

Which option is a “best fit” at this stage?



TABLE No.

OPTION 1	OPTION 2	OPTION 3	OPTION 4
Indoor 25m + Outdoor 50m	Indoor shaped pool + Outdoor 50m	Indoor 25m + Outdoor 25m + WOW	Indoor shaped pool + Outdoor 25m + WOW

Criteria

1. "How well does the design create opportunities for social interaction?"				
2. "How well does the design provide a pleasant, comfortable and safe physical environment for users?"				
3. "How well does the design cater for year round use?"				
4. "How well does the design facilitate accessibility for the broadest number of potential users?"				
5. "How flexible is the design to cater for the needs of the maximum variety of users and activities?"				
Learn to Swim				
Toddler Area				
Leisure				
Aqua				
Warm Water				
Lap Swimming				
Squads				
Water Polo				
Swim Club				
School Carnival				



Improvements

Costing Elements



Approx \$0.25M



Approx \$0.7M





Approx \$1.5M

WANNASUPPLY.COM

Approx \$0.5M



Approx \$0.8M



Approx \$1.5M



Improvements

Looking at the “best fit” option, and the criteria, brainstorm ideas at your table for improving the design

I.e. What might you change or add so that the design would better meet the criteria, within the budget?

Each table to suggest an idea, with the reason it would make it better

Recommendation

Imagine you are one of the Councillors

What input from this activity will assist you to make a good decision that reflects the needs of the community and is consistent with the role of Council?



Recommendation

Some volunteers to present recommendation to Council?



Thanks

Please complete the yellow feedback form on your table



END

